

ORCHARD GROVE

Located on East Side of Walled Lake, Oakland County, Michigan.

A SUBDIVISION OF DISTINCTION—AS EACH LOT (AVERAGING OVER 3 ACRES) BEING RESTRICTED AND HAVING A VERY DESIRABLE BUILDING SITE, GIVING TO EVERY PARCEL A GRAND VIEW OF THE LAKE AND SURROUNDING COUNTRY. ALSO FAR ENOUGH OFF THE GRAVEL ROADS TO BE FREE FROM DUST AND NOISE, BUT STILL A STEP FROM THE SHORES OF THE LAKE.

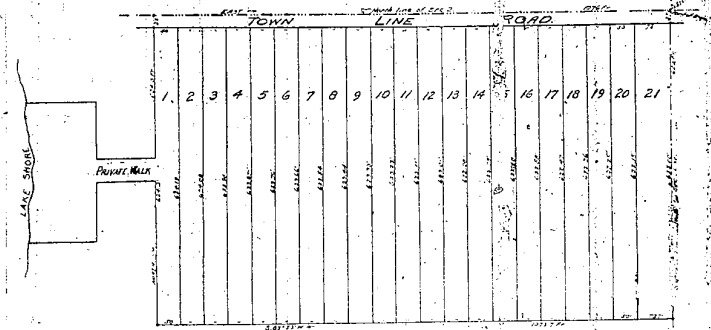

Plat as Accepted and Recorded.

OVER 125 FULL GROWN APPLE TREES

of
Standard Varieties
Carefully Trimmed
and Sprayed

Which Alone Will Pay a Dividend
on the investment.



Same of the Apple Trees

Detroit Edison Electricity guaranteed to each builder.
Private Lake Privileges deeded with every lot. Soil adapted to the growing of anything in the Garden Line or the raising of Poultry.
Private Drive through center of Subdivision so lots can be divided.
Directly back of Hickory Knoll on the South Side of the Town Line State Road lays this Subdivision which is 28 Miles to Detroit City Hall via two state roads.

PRICED FROM \$350 UP--10% DOWN; 1% MONTHLY

For Further Particulars see

LOVEWELL FARMS CO., Real Estate Dealers

Phone 264. **OWNERS, NORTHVILLE, MICH.** Phone 188-J.
S. A. LOVEWELL. Phone 259. E. L. SMITH. Phone 188-J.

FIFTEENTH LIST OF THE

LOVEWELL FARMS CO.

(Incorporated)
MEANS A HOME

The Following For Exchange,
and worth your time if you have a home, con-
tracts or farm you wish to trade.

No. 1. Apple Grove Subdivision—41 restricted choice lots on the east shore of Walled Lake. Five acres covered with large apple trees; all lots command a fine view of the lake. Priced from \$350.00 up. 10% down; 1% monthly.

No. 2. Impeccable Business—Stand strictest investigation. Wants farm or contract.

No. 3. 2 Acres and up—At the edge of Northville; One high land; spring water—will build to suit buyer.

No. 4. 9 Acres—One mile out; 20 young fruit trees; 1 acre strawberries; barn, new small house, small tools, horse; wants home in Northville.

No. 5. 4 Acres—2 miles toward Detroit. New modern bungalow, chickenhouse, garage, springs \$4,000. Terms.

No. 6. 4 Acres—West of town. Good house, barn and outbuildings—all kinds of fruit, \$4,200. \$1,800 down; wants home in Northville.

No. 7. 5 Ten-Acre Tracts—No buildings, electricity, state road—not far out. \$350 per acre up. City improved or contract.

No. 8. 20 Acres—1/4 mile off Grand River; 6-room new brick bungalow; basement barn, spring orchard, 4 a. timber. Wants home on West Side, Detroit.

No. 9. 38 Acres—1/4 mile off Grand River; all work land, fruit; 6-room fair house; small barn; team, 4 cows, hogs, 80 chickens, tools, crops. \$4,500—\$2,000 down. Will consider home near city.

No. 10. 50 Acres—In the 12-Mile circle, good house, fair barn, orchard, all level work land, \$12,000. Trade for home in Plymouth or city property.

No. 11. 40 Acres—Near Whitmore Lake, with new bungalow (not quite finished), level clay loam, new seedling (sweet), and 10 acres of Apple Orchard just in its prime; 250 trees of the best variety; 50 standard cherries, and a real place. Exchange considered on fair and clear improved.

No. 12. 60 Acres—1/4 mile off cement; good

house, 4 acres apple orchard; good soil—go waste land—at \$7,000. Terms or exchange considered.

No. 13. 50 Acres—Same location, with new buildings; modern home; silo, soil a black sand, loam, sloping to the south and just right for truck gardening; 12 acres of timber. Farm can be bought for \$10,000 on terms—and exchange considered.

No. 14. 70 Acres—Overlooking a lake and good bathing shores, including lake privileges; 10-room extra good house, oak floors down stairs, running water, large shady yard. Good basement barn (not painted), 1,000 foot frontage on fishing lake, 8 acres alfalfa. Farm somewhat rolling but a good producer. A number of cottages nearby. An income easily obtained from the farm. Including stock and equipment for \$14,000. Exchange for city home or contracts.

No. 15. 80 Acres—Near Novi and Grand River, gravel clay loam; 2 a. timber; 12 a. 6-year-old apple trees (peaches and apples), silo, fair big a. Exchange for Detroit or Royal Oak home at \$15,500.

No. 16. 80 Acres—Out Base Line, 8-room good house, beautiful shaded yard, basement barn, silo, good outbuildings, 7 acres timber, 50 apple trees, 24 acres hay. \$150 per acre. Will consider a Pontiac home in exchange.

No. 17. 90 Acres—2 miles out, very good buildings, 650 fruit trees. Will sell farm with equipment or not or exchange for contracts and some vacant. Priced on a cash selling price.

No. 18. 100 Acres—Near cement road, two houses, silo, good barns, orchard, timber; part black loam and part gravel clay loam, at \$175 per acre with some exchange.

No. 19. 116 Level Acres—Near Salem and 1/4 mile off state road, with very good buildings, water system by hydraulic ram; apples; 8 acres sugar bush, silo. \$150 per acre. Terms and exchange considered.

No. 20. 90 Acres—Near Ypsilanti; new modern buildings, state road, 30 miles Detroit. \$22,000. Exchange for 2 or 4-family flat in city.

No. 21. 120 Acres—On Ann Arbor State road, 40 acres timber, small orchard; no buildings; 60 acres plow land, balance pasture. \$45 per acre trade.

No. 22. 128 Acres—Just out of Milford, 2 good barns, good outbuildings, no house; 13 acres saw timber, large apple orchard; Huron river crosses farm. \$9,000—\$1,000 down or trade. What have you to offer?

No. 23. 120 Acres—On the state road, three miles out, 10 acres real orchard, pasture, level, clay loam, 2 new hip-roof barns, 7-room very good house, electricity available; new wire fence, 2 silos, fine shade, all kinds of fruit. Price right and will consider exchange for Pontiac home.

No. 24. 120 Acres—On State Road, 3 miles off Grand River, 23 miles out; 80 acres gravel loam plow land, 40 acres woods (all laker); over 1/4 mile desirable lake frontage—Large Lake partly subdivided, 9-room very good house, fair barn, fine shade. Priced at farm value and exchange, desired for a single or 2-fam.

No. 25. 120 Acres or 80 Acres—Near Milford, all plow land, 40 mixed 1, 1st, 2nd, 3rd, 4th, 5th, 6th, 7th, 8th, 9th, 10th, 11th, 12th, 13th, 14th, 15th, 16th, 17th, 18th, 19th, 20th, 21st, 22nd, 23rd, 24th, 25th, 26th, 27th, 28th, 29th, 30th, 31st, 32nd, 33rd, 34th, 35th, 36th, 37th, 38th, 39th, 40th, 41st, 42nd, 43rd, 44th, 45th, 46th, 47th, 48th, 49th, 50th, 51st, 52nd, 53rd, 54th, 55th, 56th, 57th, 58th, 59th, 60th, 61st, 62nd, 63rd, 64th, 65th, 66th, 67th, 68th, 69th, 70th, 71st, 72nd, 73rd, 74th, 75th, 76th, 77th, 78th, 79th, 80th, 81st, 82nd, 83rd, 84th, 85th, 86th, 87th, 88th, 89th, 90th, 91st, 92nd, 93rd, 94th, 95th, 96th, 97th, 98th, 99th, 100th, 101st, 102nd, 103rd, 104th, 105th, 106th, 107th, 108th, 109th, 110th, 111th, 112th, 113th, 114th, 115th, 116th, 117th, 118th, 119th, 120th, 121st, 122nd, 123rd, 124th, 125th, 126th, 127th, 128th, 129th, 130th, 131st, 132nd, 133rd, 134th, 135th, 136th, 137th, 138th, 139th, 140th, 141st, 142nd, 143rd, 144th, 145th, 146th, 147th, 148th, 149th, 150th, 151st, 152nd, 153rd, 154th, 155th, 156th, 157th, 158th, 159th, 160th, 161st, 162nd, 163rd, 164th, 165th, 166th, 167th, 168th, 169th, 170th, 171st, 172nd, 173rd, 174th, 175th, 176th, 177th, 178th, 179th, 180th, 181st, 182nd, 183rd, 184th, 185th, 186th, 187th, 188th, 189th, 190th, 191st, 192nd, 193rd, 194th, 195th, 196th, 197th, 198th, 199th, 200th, 201st, 202nd, 203rd, 204th, 205th, 206th, 207th, 208th, 209th, 210th, 211st, 212nd, 213th, 214th, 215th, 216th, 217th, 218th, 219th, 220th, 221st, 222nd, 223rd, 224th, 225th, 226th, 227th, 228th, 229th, 230th, 231st, 232nd, 233rd, 234th, 235th, 236th, 237th, 238th, 239th, 240th, 241st, 242nd, 243rd, 244th, 245th, 246th, 247th, 248th, 249th, 250th, 251st, 252nd, 253rd, 254th, 255th, 256th, 257th, 258th, 259th, 260th, 261st, 262nd, 263rd, 264th, 265th, 266th, 267th, 268th, 269th, 270th, 271st, 272nd, 273rd, 274th, 275th, 276th, 277th, 278th, 279th, 280th, 281st, 282nd, 283rd, 284th, 285th, 286th, 287th, 288th, 289th, 290th, 291st, 292nd, 293rd, 294th, 295th, 296th, 297th, 298th, 299th, 300th, 301st, 302nd, 303rd, 304th, 305th, 306th, 307th, 308th, 309th, 310th, 311st, 312nd, 313th, 314th, 315th, 316th, 317th, 318th, 319th, 320th, 321st, 322nd, 323rd, 324th, 325th, 326th, 327th, 328th, 329th, 330th, 331st, 332nd, 333rd, 334th, 335th, 336th, 337th, 338th, 339th, 340th, 341st, 342nd, 343rd, 344th, 345th, 346th, 347th, 348th, 349th, 350th, 351st, 352nd, 353rd, 354th, 355th, 356th, 357th, 358th, 359th, 360th, 361st, 362nd, 363rd, 364th, 365th, 366th, 367th, 368th, 369th, 370th, 371st, 372nd, 373rd, 374th, 375th, 376th, 377th, 378th, 379th, 380th, 381st, 382nd, 383rd, 384th, 385th, 386th, 387th, 388th, 389th, 390th, 391st, 392nd, 393rd, 394th, 395th, 396th, 397th, 398th, 399th, 400th, 401st, 402nd, 403rd, 404th, 405th, 406th, 407th, 408th, 409th, 410th, 411st, 412nd, 413th, 414th, 415th, 416th, 417th, 418th, 419th, 420th, 421st, 422nd, 423rd, 424th, 425th, 426th, 427th, 428th, 429th, 430th, 431st, 432nd, 433rd, 434th, 435th, 436th, 437th, 438th, 439th, 440th, 441st, 442nd, 443rd, 444th, 445th, 446th, 447th, 448th, 449th, 450th, 451st, 452nd, 453rd, 454th, 455th, 456th, 457th, 458th, 459th, 460th, 461st, 462nd, 463rd, 464th, 465th, 466th, 467th, 468th, 469th, 470th, 471st, 472nd, 473rd, 474th, 475th, 476th, 477th, 478th, 479th, 480th, 481st, 482nd, 483rd, 484th, 485th, 486th, 487th, 488th, 489th, 490th, 491st, 492nd, 493rd, 494th, 495th, 496th, 497th, 498th, 499th, 500th, 501st, 502nd, 503rd, 504th, 505th, 506th, 507th, 508th, 509th, 510th, 511st, 512nd, 513th, 514th, 515th, 516th, 517th, 518th, 519th, 520th, 521st, 522nd, 523rd, 524th, 525th, 526th, 527th, 528th, 529th, 530th, 531st, 532nd, 533rd, 534th, 535th, 536th, 537th, 538th, 539th, 540th, 541st, 542nd, 543rd, 544th, 545th, 546th, 547th, 548th, 549th, 550th, 551st, 552nd, 553rd, 554th, 555th, 556th, 557th, 558th, 559th, 560th, 561st, 562nd, 563rd, 564th, 565th, 566th, 567th, 568th, 569th, 570th, 571st, 572nd, 573rd, 574th, 575th, 576th, 577th, 578th, 579th, 580th, 581st, 582nd, 583rd, 584th, 585th, 586th, 587th, 588th, 589th, 590th, 591st, 592nd, 593rd, 594th, 595th, 596th, 597th, 598th, 599th, 600th, 601st, 602nd, 603rd, 604th, 605th, 606th, 607th, 608th, 609th, 610th, 611st, 612nd, 613th, 614th, 615th, 616th, 617th, 618th, 619th, 620th, 621st, 622nd, 623rd, 624th, 625th, 626th, 627th, 628th, 629th, 630th, 631st, 632nd, 633rd, 634th, 635th, 636th, 637th, 638th, 639th, 640th, 641st, 642nd, 643rd, 644th, 645th, 646th, 647th, 648th, 649th, 650th, 651st, 652nd, 653rd, 654th, 655th, 656th, 657th, 658th, 659th, 660th, 661st, 662nd, 663rd, 664th, 665th, 666th, 667th, 668th, 669th, 670th, 671st, 672nd, 673rd, 674th, 675th, 676th, 677th, 678th, 679th, 680th, 681st, 682nd, 683rd, 684th, 685th, 686th, 687th, 688th, 689th, 690th, 691st, 692nd, 693rd, 694th, 695th, 696th, 697th, 698th, 699th, 700th, 701st, 702nd, 703rd, 704th, 705th, 706th, 707th, 708th, 709th, 710th, 711st, 712nd, 713th, 714th, 715th, 716th, 717th, 718th, 719th, 720th, 721st, 722nd, 723rd, 724th, 725th, 726th, 727th, 728th, 729th, 730th, 731st, 732nd, 733rd, 734th, 735th, 736th, 737th, 738th, 739th, 740th, 741st, 742nd, 743rd, 744th, 745th, 746th, 747th, 748th, 749th, 750th, 751st, 752nd, 753rd, 754th, 755th, 756th, 757th, 758th, 759th, 760th, 761st, 762nd, 763rd, 764th, 765th, 766th, 767th, 768th, 769th, 770th, 771st, 772nd, 773rd, 774th, 775th, 776th, 777th, 778th, 779th, 780th, 781st, 782nd, 783rd, 784th, 785th, 786th, 787th, 788th, 789th, 790th, 791st, 792nd, 793rd, 794th, 795th, 796th, 797th, 798th, 799th, 800th, 801st, 802nd, 803rd, 804th, 805th, 806th, 807th, 808th, 809th, 810th, 811st, 812nd, 813th, 814th, 815th, 816th, 817th, 818th, 819th, 820th, 821st, 822nd, 823rd, 824th, 825th, 826th, 827th, 828th, 829th, 830th, 831st, 832nd, 833rd, 834th, 835th, 836th, 837th, 838th, 839th, 840th, 841st, 842nd, 843rd, 844th, 845th, 846th, 847th, 848th, 849th, 850th, 851st, 852nd, 853rd, 854th, 855th, 856th, 857th, 858th, 859th, 860th, 861st, 862nd, 863rd, 864th, 865th, 866th, 867th, 868th, 869th, 870th, 871st, 872nd, 873rd, 874th, 875th, 876th, 877th, 878th, 879th, 880th, 881st, 882nd, 883rd, 884th, 885th, 886th, 887th, 888th, 889th, 890th, 891st, 892nd, 893rd, 894th, 895th, 896th, 897th, 898th, 899th, 900th, 901st, 902nd, 903rd, 904th, 905th, 906th, 907th, 908th, 909th, 910th, 911st, 912nd, 913th, 914th, 915th, 916th, 917th, 918th, 919th, 920th, 921st, 922nd, 923rd, 924th, 925th, 926th, 927th, 928th, 929th, 930th, 931st, 932nd, 933rd, 934th, 935th, 936th, 937th, 938th, 939th, 940th, 941st, 942nd, 943rd, 944th, 945th, 946th, 947th, 948th, 949th, 950th, 951st, 952nd, 953rd, 954th, 955th, 956th, 957th, 958th, 959th, 960th, 961st, 962nd, 963rd, 964th, 965th, 966th, 967th, 968th, 969th, 970th, 971st, 972nd, 973rd, 974th, 975th, 976th, 977th, 978th, 979th, 980th, 981st, 982nd, 983rd, 984th, 985th, 986th, 987th, 988th, 989th, 990th, 991st, 992nd, 993rd, 994th, 995th, 996th, 997th, 998th, 999th, 1000th, 1001st, 1002nd, 1003rd, 1004th, 1005th, 1006th, 1007th, 1008th, 1009th, 1010th, 1011st, 1012nd, 1013th, 1014th, 1015th, 1016th, 1017th, 1018th, 1019th, 1020th, 1021st, 1022nd, 1023rd, 1024th, 1025th, 1026th, 1027th, 1028th, 1029th, 1030th, 1031st, 1032nd, 1033rd, 1034th, 1035th, 1036th, 1037th, 1038th, 1039th, 1040th, 1041st, 1042nd, 1043rd, 1044th, 1045th, 1046th, 1047th, 1048th, 1049th, 1050th, 1051st, 1052nd, 1053rd, 1054th, 1055th, 1056th, 1057th, 1058th, 1059th, 1060th, 1061st, 1062nd, 1063rd, 1064th, 1065th, 1066th, 1067th, 1068th, 1069th, 1070th, 1071st, 1072nd, 1073rd, 1074th, 1075th, 1076th, 1077th, 1078th, 1079th, 1080th, 1081st, 1082nd, 1083rd, 1084th, 1085th, 1086th, 1087th, 1088th, 1089th, 1090th, 1091st, 1092nd, 1093rd, 1094th, 1095th, 1096th, 1097th, 1098th, 1099th, 1100th, 1101st, 1102nd, 1103rd, 1104th, 1105th, 1106th, 1107th, 1108th, 1109th, 1110th, 1111st, 1112nd, 1113th, 1114th, 1115th, 1116th, 1117th, 1118th, 1119th, 1120th, 1121st, 1122nd, 1123rd, 1124th, 1125th, 1126th, 1127th, 1128th, 1129th, 1130th, 1131st, 1132nd, 1133rd, 1134th, 1135th, 1136th, 1137th, 1138th, 1139th, 1140th, 1141st, 1142nd, 1143rd, 1144th, 1145th, 1146th, 1147th, 1148th, 1149th, 1150th, 1151st, 1152nd, 1153rd, 1154th, 1155th, 1156th, 1157th, 1158th, 1159th, 1160th, 1161st, 1162nd, 1163rd, 1164th, 1165th, 1166th, 1167th, 1168th, 1169th, 1170th, 1171st, 1172nd, 1173rd, 1174th, 1175th, 1176th, 1177th, 1178th, 1179th, 1180th, 1181st, 1182nd, 1183rd, 1184th, 1185th, 1186th, 1187th, 1188th, 1189th, 1190th, 1191st, 1192nd, 1193rd, 1194th, 1195th, 1196th, 1197th, 1198th, 1199th, 1200th, 1201st, 1202nd, 1203rd, 1204th, 1205th, 1206th, 1207th, 1208th, 1209th, 1210th, 1211st, 1212nd, 1213th, 1214th, 1215th, 1216th, 1217th, 1218th, 1219th, 1220th, 1221st, 1222nd, 1223rd, 1224th, 1225th, 1226th, 1227th, 1228th, 1229th, 1230th, 1231st, 1232nd, 1233rd, 1234th, 1235th, 1236th, 1237th, 1238th, 1239th, 1240th, 1241st, 1242nd, 1243rd, 1244th, 1245th, 1246th, 1247th, 1248th, 1249th, 1250th, 1251st, 1252nd, 1253rd, 1254th, 1255th, 1256th, 1257th, 1258th, 1259th, 1260th, 1261st, 1262nd, 1263rd, 1264th, 1265th, 1266th, 1267th, 1268th, 1269th, 1270th, 1271st, 1272nd, 1273rd, 1274th, 1275th, 1276th, 1277th, 1278th, 1279th, 1280th, 1281st, 1282nd, 1283rd, 1284th, 1285th, 1286th, 1287th, 1288th, 1289th, 1290th, 1291st, 1292nd, 1293rd, 1294th, 1295th, 1296th, 1297th, 1298th, 1299th, 1300th, 1301st, 1302nd, 1303rd, 1304th, 1305th, 1306th, 1307th, 1308th, 1309th, 1310th, 1311st, 1312nd, 1313th, 1314th, 1315th, 1316th, 1317th, 1318th, 1319th, 1320th, 1321st, 1322nd, 1323rd, 1324th, 1325th, 1326th, 1327th, 1328th, 1329th, 1330th, 1331st, 1332nd, 1333rd, 1334th, 1335th, 1336th, 1337th, 1338th, 1339th, 1340th, 1341st, 1342nd, 1343rd, 1344th, 1345th, 1346th, 1347th, 1348th, 1349th, 1350th, 1351st, 1352nd, 1353rd, 1354th, 1355th, 1356th, 1357th, 1358th, 1359th, 1360th, 1361st, 1362nd, 1363rd, 1364th, 1365th, 1366th, 1367th, 1368th, 1369th, 1370th, 1371st, 1372nd, 1373rd, 1374th, 1375th, 1376th, 1377th, 1378th, 1379th, 1380th, 1381st, 1382nd, 1383rd, 1384th, 1385th, 1386th, 1387th, 1388th, 1389th, 1390th, 1391st, 1392nd, 1393rd, 1394th, 1395th, 1396th, 1397th, 1398th, 1399th, 1400th, 1401st, 1402nd, 1403rd, 1404th, 1405th, 1406th, 1407th, 1408th, 1409th, 1410th, 1411st, 1412nd, 1413th, 1414th, 1415th, 1416th, 1417th, 1418th, 1419th, 1