



Marie McGee editor/591-2300

Thursday, August 20, 1986 O&F

(F)1E

Huge new resort lures vacationers

By Corinne Abatt
Staff writer

LIKE IT OR NOT, nobody in Traverse City makes light of the impact of the Grand Traverse Resort upon the community.

The newly opened 15-story glass Tower, designed by Livonia-based architects Louis Redstone Associates, soars into the skyline.

The 840-acre resort with its accommodations for at least 1,500 people at any one time, the condo developments, both rental and permanent residential, the golf courses and elaborate sports facilities, meeting and banquet rooms and nine restaurants or lounges has already affected the economy of the community.

Paul Nine, Bloomfield Hills attorney and president of the resort, said, "When we started (1973), Traverse City had one of the highest unemployment rates in the state and now we're looking for people to hire."

Colleen Bagley, the Resort's marketing director, echoed that statement: "We have over a thousand employees and we still looking for more in a few departments."

Located several miles east of the city on pleasantly rolling countryside, the resort is easy to find and recognizable because of the pristine condition of the miles of green lawns and golf courses bordered with bright flowers.

When the Redstone-designed conference center, seating 2,000 people, is completed next summer, the National Governors' Association will inaugurate the facility. And although it is still in the embryo state, it has been officially dubbed "Governors' Hall" in honor of its prestigious first guests.

REDSTONE SAID the construction of the convention center, like the Tower, "is all split second timing" in order to make the tight deadline. It will be one story brick and glass right in the center of things with the Resort facilities just few steps away.

Nine, said the Resort is "clearly one of the finalists" in its bid to

A \$17 million expansion plan is well under way. It's like watching the evolution of a planned community on a film that's set on 'fast forward.'

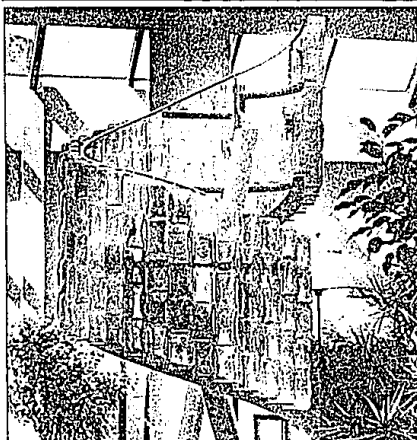
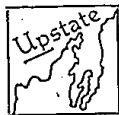

This glass sculpture by Herbert Babcock of Auburn Hills is one of the first things visitors see when entering the lobby of the Grand Traverse Resort. When water flows over the multicolored hand-blown glass bricks and spirals down into a pool below, it captures the light from the Tower Gallery's atrium. The autumn foliage colors at the top change to blues and greens at the bottom of the 12-foot work. Babcock is head of the glass department at CCS-College of Art and Design.

host the 1992 PGA tournament on the "Bear," which golfers say lives up to its name. He also admitted

that Oakland Hills, another contender, is tough to score against.

Please turn to Page 10

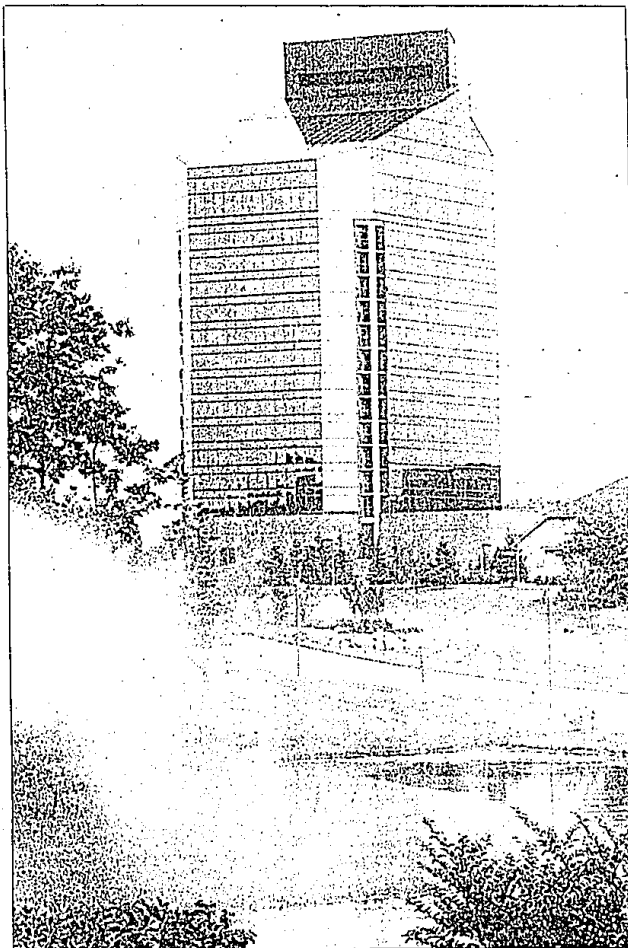

The 15-story Grand Traverse Resort Tower, double glazed, reflective glass. The mist in designed by Louis G. Redstone Associates of the lower left corner is from the fountains Livonia, opened last June. The exterior of the near the entrance. \$27 million structure is tinted bronze with

and permanent residents

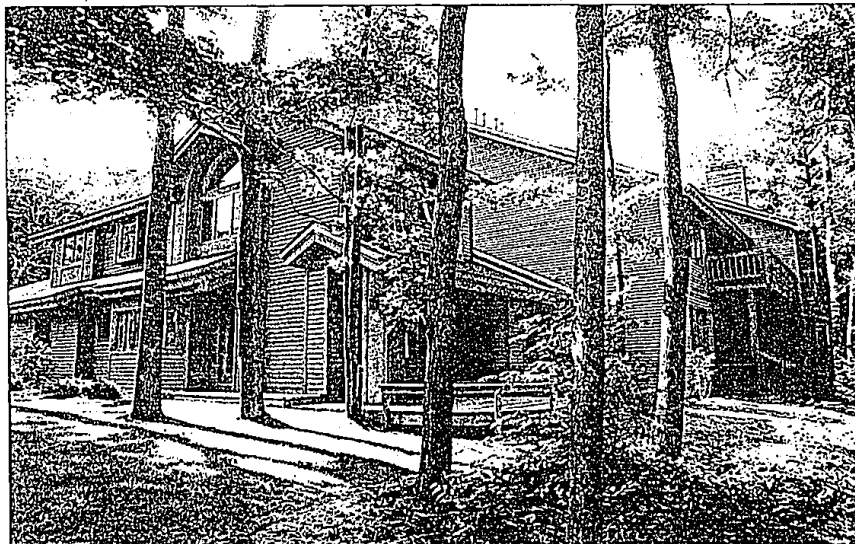

The two- and three-bedroom condominium residences at Deepwater Point, part of Grand Traverse Resort Village, are designed to serve as permanent residences or second homes. They are on a point in the woods high above East Grand Traverse Bay. The exterior view shows the deck, which offers a beautiful view of the woods, beach and bay. Inside natural materials such as wood and brick are used lavishly in conjunction with luxurious fabrics in a soft mauve, autumn haze palette. Prices start at \$179,500.

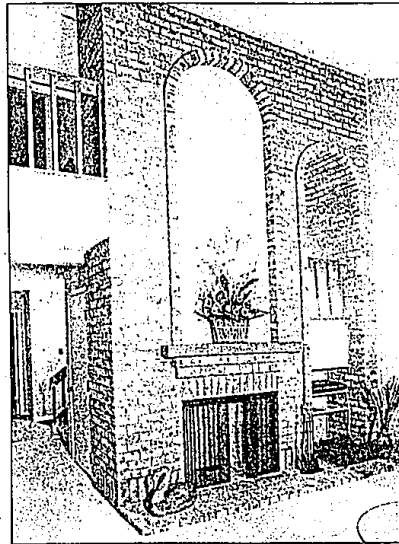

Staff photos by Stephen Cantrell