

Monte Nagler's photograph of the Conwy Castle in Wales is enhanced and strengthened by the effective use of the

Directing viewer's attention

In past columns I've touched on the importance of composition. I would define it as the placement of the elements you view through the camera.

Today, I'd like to concentrate on a very important aspect of good composition, something that will enhance and add stopping power to your photographs — lead-in lines.

A lead-in line can be a river, pathway, road, fence or any other element that will lead and direct the viewer's attention to the central subject.

NEXT TIME you're about to photograph that weathered, old barn, stop and take a moment to search for a composition that will include a lead-in line.

Perhaps it's the dilapidated fence or the furrows in a recently plowed field that lead the eye to the barn. By using either, can you imagine how much more exciting your finished picture will be?

How about that lonely tree in the valley you're about to shoot? Can you position yourself so that the meandering river leads the way into the picture?

Using lead-in lines causes you to slow down, think more and plan the final image in your mind's eye. You're going through the process of making photographs, not taking snapshots — and your pictures will definitely show the difference.

SUBJECT PLACEMENT often works well by using the "rule of thirds." This means positioning the subject toward one of the corners of the

sweeping walkway and wall as lead-in lines.



photography
Monte Nagler

viewfinder rather than in the center. After you've done this, look for a lead-in coming from the opposite corner.

In the photograph shown here of the Conwy Castle in Wales, I placed the main subject (the castle) in the upper right "third." I then used the sweeping lines of the walkway and wall as effective lead-ins to direct attention to the castle. See how easily it works?

Of course, you'll have to pay close attention to depth-of-field. Most likely you'll need a small aperture so that everything in your finished print is sharp and in focus.

Look for abstract lead-in lines, too. Man-made patterns such as the steel structure in a building under construction or nature's patterns such as the ripples in a dramatic sand dune can all serve as effective lead-ins.

The important thing is to begin to "see" lead-in lines. They'll help you look at the world in fresh, new, exciting ways. Your photographs will have added strength and impact that will make you proud to share them with others.

Nancy Thayer to lead art business seminar

A popular informational half-day seminar geared for artists is back by request.

Sponsored by the Livonia Arts Commission, the workshop, "The Business of Being An Artist," will be held 1:30-5 p.m. Saturday, Sept. 23, in the Livonia Civic Center Library on Five Mile. It is open to all area

Short shots

Monte Nagler's fall classes begin Tuesday, Sept. 26, at the Farmington Community Center (call 477-8404 to register), and Wednesday, Sept. 27, at The Community House of Birmingham (644-5932).

The classes last four weeks and cover basic and intermediate information for 35mm enthusiasts.

residents. Speaker will be well-known area artist Nancy Thayer, who will open her talk on "Record Keeping." Later in the afternoon, Thayer will discuss "Framing," focusing on appropriate choices and the necessity of proper framing.

Thayer, an instructor at the Center for Creative Studies in Detroit and the Detroit Institute of Arts, conducted a similar workshop last spring.

Cost of the workshop is \$3. Registration may be made by sending a check payable to the Livonia Arts Commission, 23000 Civic Center Drive, Livonia 48154-3097, or by registering with the Community Resources Department on the fourth floor of the Livonia City Hall.

GRAND OPENING! Oak Pointe

NEW CUSTOM HOME MODELS



SALES OFFICE MODEL: 4280 ST. ANDREWS

The newly developed Highlands area of Oak Pointe (the former Burroughs Farms) features custom, single family homes by Guenther on 23 beautiful, large, rolling acres. Many of the homes will adjoin the fairways of one of the three superior golf courses carefully carved from Oak Pointe's 700 acres of rolling meadows, woodlands, lakes and streams.

It is the best of so many worlds. A peaceful, private retreat and an exciting resort boasting the finest recreational facilities, including a beautiful club and marina on West Crooked Lake. Guenther homes in Oak Pointe Highlands range from 2800 to 3600 sq. ft. and are priced from \$280,000 to \$400,000. The sales model pictured above is tastefully furnished and decorated for your viewing pleasure. Three other models are under construction for quick occupancy. MODELS OPEN Saturday 9-5 Sunday 12-5 Monday, Tuesday, & Friday, 1:00 to 5:00; Wednesday 3:00 to 6:00; Closed Thursday

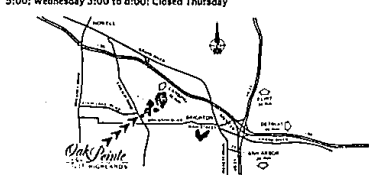

GUENTHER BUILDING CO. PHONE: 313/227-6607

MILFORD

Open Houses

presented during
Milford's Historic Homes Tour
by REAL ESTATE ONE

OPEN SAT., SEPT. 16 2-5 P.M.

531 Union \$115,500
55481 Ward \$115,900
324 East St. \$119,000
4700 Kindardline \$198,000

OPEN SUN., SEPT. 17 2-5 P.M.

430 Hillwood \$ 82,900
125 Houghton \$109,900
312 Franklin \$109,900
3267 Rippleway \$114,900
531 Union \$115,500
324 East St. \$119,000
1410 Hickory Ridge \$135,000
240 E. Dawson \$178,000
2615 Shagbark \$179,900

ALSO AVAILABLE — Not Open

3851 Middle Rd. \$ 97,900
1405 Wixom Trail \$129,000
4328 Kensington \$135,000
1708 Majon \$129,900
425 Lawrence Dr. \$249,900
7171 Oakwood \$342,000
(West Bloomfield)



Visit Our Real Estate One Office at

545 N. Main Street

Sunday 12-5 p.m. during the Old Car Show
for FREE Refreshments

Need Directions? Call 684-1065

Select Properties from Real Estate One.

Michigan's Largest Real Estate Company

BIRMINGHAM, MI 48202



GREAT LOCATION - GREAT PRICE - GREAT HOME. Fantastic contemporary 6 months old home in your price range. You're going through the process of making photographs, not taking snapshots — and your pictures will definitely show the difference.



PRESTIGIOUS NEW HOME. Beautiful colonial on wooded lot near downtown Farmington. Circular drive. Fantastic open design, neutral decor. Three bedrooms plus library/study. One year old. \$185,000 477-1111

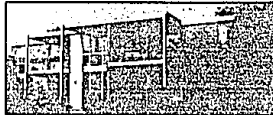

TOP BIRMINGHAM CONDO. Two bedroom, two bath first floor condo with sharp recent updating, carpet throughout, patio, pool in complex, Bloomfield Hills schools. Asking only \$103,600. 477-1111

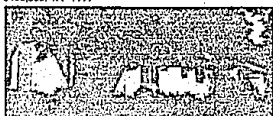

TWO BEDROOM RANCH WITH FAMILY ROOM. Much updating, finished basement, large family room, formal dining room, living room with fireplace. Downtown Farmington. 2 car attached garage. Room for expansion. \$99,900 477-1111

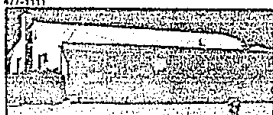

BRICK RANCH WITH FIREPLACE. Fresh paint and new carpet in same rooms. Three bedrooms plus two in basement. Finished recreation room, 2 1/2 car garage, on big lot. \$35,900 477-1111



BEAUTIFULLY MAINTAINED 3 bedroom bungalow. Tastefully decorated with neutral colors thru-out. Features include vinyl double hung windows, finished basement, alarm system, beautiful yard, very clean and ready to move into! \$129,000 348-6430

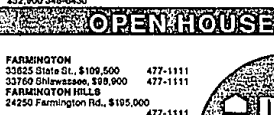

FARMINGTON 32625 State St., \$109,500 477-1111
33760 Glenview, \$98,900 477-1111
FARMINGTON HILLS 24250 Farmington Rd., \$195,000 477-1111
23240 Fox Creek, \$209,900 477-1111
37550 River Bend, \$229,500 477-1111
28683 Oak Pointe Dr., \$199,500 851-1000
32531 Galtway, \$159,000 851-1000
33811 Hartan, \$169,000 851-1000
26530 Badalamenti, \$144,000 363-1511
26523 Ravenscroft, \$129,900 851-1000

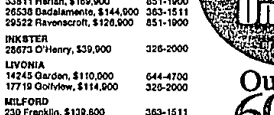

INXETER 28673 O'Henry, \$39,000 326-2000
LIVONIA 14245 Garden, \$110,000 644-4700
17718 Oakview, \$114,900 326-2000
MILFORD 230 Franklin, \$129,800 363-1511

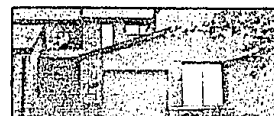

DOWNTOWN FARMINGTON. Walk to everything from this immaculate 2 bedroom condo in Wynet complex. 2 1/2 bath, garage, finished rec room and appliances. Just turn the key, move-in condition. Immediate occupancy. \$129,000 851-1900 (GFA)



TWO FAMILY INCOME. Excellent Downtown Farmington location. Rare, lovely, loaded with charm. You'll love living in it or renting it out. \$129,000 851-1900 (GFA)



UPDATING 3 BEDROOM RANCH. Freshly painted, Natural fireplace and new picture window in living room. Hardwood floors. Updated country kitchen includes all appliances, newer roof, finished basement. \$89,900 851-1900 (ND)

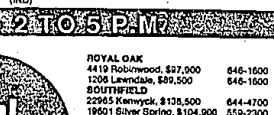

ROYAL OAK 4419 Robinwood, \$27,000 846-1600
1206 Leewardale, \$69,500 846-1600
SOUTHFIELD 22965 Kenyalk, \$138,500 644-4700
18601 Silver Spring, \$104,000 559-2300
15201 Pennsylvania, \$14,500 559-2300
15305 Pennsylvania, \$84,500 559-2300
24540 Tempier, \$73,500 559-2300

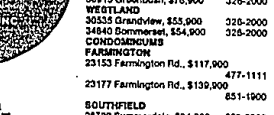

WAYNE 36915 Greenbush, \$76,900 326-2000
WESTLAND 30332 Grandview, \$55,900 326-2000
34840 Somerset, \$54,900 326-2000
CONDO/BOUNDS FARMINGTON 23153 Farmington Rd., \$117,900 477-1111
23177 Farmington Rd., \$139,900 851-1900
SOUTHFIELD 21222 Summerdale, \$94,900 559-2300

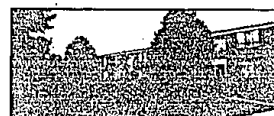

RIVER GLEN CONDO. Downtown Farmington — convenient to everything. Sharp 2 bedroom upper unit with central air and appliances. Move-in condition. Quick occupancy. \$62,500 851-1900 (GFA)

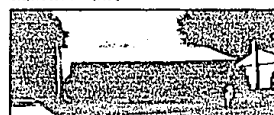

MAINTENANCE-FREE EXTERIOR surrounded by neat, well kept yard. Walking distance from South Lyon churches, schools, shopping. Established family sub. Vinyl clad replacement windows. Hardwood floors under carpeting! Must see! \$83,000 348-6430



UPDATES GALORE. Sharp 3 bedroom brick ranch with 4th bedroom in finished basement. New kitchen, vinyl windows, doors, roof, central air, recently painted and Birmingham Schools too! \$92,500 559-2300



RECENTLY REMODELED 3 bedroom Ranch, new refrigerator, air cleaner, new disposal, lifetime warranty furnace, 60 gallon water heater less than 4 years old, unfinished basement. Home Warranty, fenced yard. \$57,600 559-2300



CHARMING BRICK RANCH. Move into neat Ranch with 4th bedroom in finished basement. Great family neighborhood. South of 18 mile Road and East of Van Dyke. \$84,000 844-4700



SPRAWLING RANCH. Approximately 1800 sq. ft. Ranch set on .523 acres. 5 bedrooms, 2 baths, den, game room, Remodeled kitchen, 1st floor laundry, all new USA triple windows. Attached garage, large patio. \$89,000 559-2300



A PERFECT GEM! Tired setting — Mini condos and newly traded decorated home make this a winner. Center entrance Colonial offers family room with natural fireplace plus lovely den. \$115,900 851-1900 (GFA)