

## Design separates areas

Multi-paned windows in the entryway and cedar scales beneath the gable add street appeal to the tri-level Dilbeck. In this floor plan, garage, utilities and family room are on the lowest level. The three bedrooms are on the highest level, up another half-flight.

Vaulted ceilings add to the sense of spaciousness in the combined living room/dining room that features fireplace.

The dining room and kitchen are partially separated by an eating bar.

handy for meals on the run. Other kitchen conveniences include Lazy Susan shelving in a corner cupboard, and a step-in pantry that allows the stocking of kitchen shelves from behind.

Utilities are close by, half a flight down, in a room they share with a toilet, lavatory and a built-in counter for folding clothes.

The family room, also on the lower level, has a small storage closet and is brightened by sliding glass doors that open onto a patio.

All three bedrooms are on the upper level. The master suite has sliding glass doors that open onto a private balcony overlooking the backyard. Other amenities include a walk-in closet and a private bathroom. The two other bedrooms face the street and share a bathroom with a tub. Linen storage is in the hallway.

For a study plan of the Dilbeck (401-16), send \$7.50 to Landmark Designs, P.O. Box 2307, Eugene, Ore. 97402, including the plan name and number.

OVERALL DIMENSIONS:  
50'-0" X 37'-0"  
LIVING: 1728 square feet  
GARAGE: 576 square feet

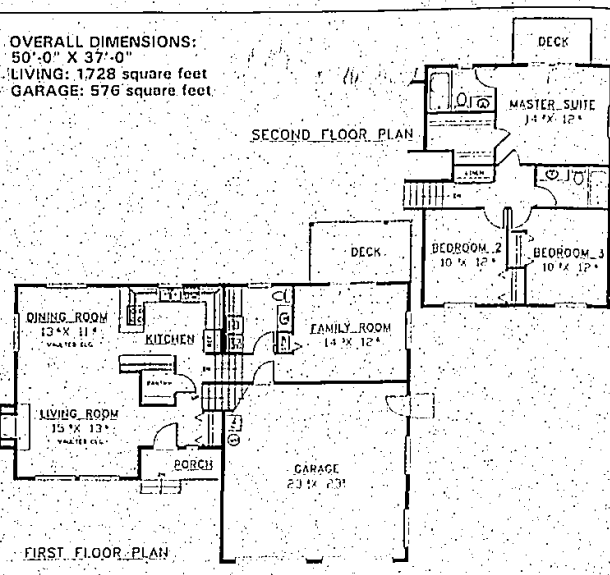

## Lilley Pointe condominiums

A PRIVATE COMMUNITY IN AN  
AWARD WINNING PARKLIKE ENVIRONMENT

- 1, 2, 3, 4 Bedrooms, 2 Bath Units
- 3, 4, 5, 6, 7, 8, 9, 10, 11, 12, 13, 14, 15, 16, 17, 18, 19, 20, 21, 22, 23, 24, 25, 26, 27, 28, 29, 30, 31, 32, 33, 34, 35, 36, 37, 38, 39, 40, 41, 42, 43, 44, 45, 46, 47, 48, 49, 50, 51, 52, 53, 54, 55, 56, 57, 58, 59, 60, 61, 62, 63, 64, 65, 66, 67, 68, 69, 70, 71, 72, 73, 74, 75, 76, 77, 78, 79, 80, 81, 82, 83, 84, 85, 86, 87, 88, 89, 90, 91, 92, 93, 94, 95, 96, 97, 98, 99, 100, 101, 102, 103, 104, 105, 106, 107, 108, 109, 110, 111, 112, 113, 114, 115, 116, 117, 118, 119, 120, 121, 122, 123, 124, 125, 126, 127, 128, 129, 130, 131, 132, 133, 134, 135, 136, 137, 138, 139, 140, 141, 142, 143, 144, 145, 146, 147, 148, 149, 150, 151, 152, 153, 154, 155, 156, 157, 158, 159, 160, 161, 162, 163, 164, 165, 166, 167, 168, 169, 170, 171, 172, 173, 174, 175, 176, 177, 178, 179, 180, 181, 182, 183, 184, 185, 186, 187, 188, 189, 190, 191, 192, 193, 194, 195, 196, 197, 198, 199, 200, 201, 202, 203, 204, 205, 206, 207, 208, 209, 210, 211, 212, 213, 214, 215, 216, 217, 218, 219, 220, 221, 222, 223, 224, 225, 226, 227, 228, 229, 230, 231, 232, 233, 234, 235, 236, 237, 238, 239, 240, 241, 242, 243, 244, 245, 246, 247, 248, 249, 250, 251, 252, 253, 254, 255, 256, 257, 258, 259, 260, 261, 262, 263, 264, 265, 266, 267, 268, 269, 270, 271, 272, 273, 274, 275, 276, 277, 278, 279, 280, 281, 282, 283, 284, 285, 286, 287, 288, 289, 290, 291, 292, 293, 294, 295, 296, 297, 298, 299, 300, 301, 302, 303, 304, 305, 306, 307, 308, 309, 310, 311, 312, 313, 314, 315, 316, 317, 318, 319, 320, 321, 322, 323, 324, 325, 326, 327, 328, 329, 330, 331, 332, 333, 334, 335, 336, 337, 338, 339, 340, 341, 342, 343, 344, 345, 346, 347, 348, 349, 350, 351, 352, 353, 354, 355, 356, 357, 358, 359, 360, 361, 362, 363, 364, 365, 366, 367, 368, 369, 370, 371, 372, 373, 374, 375, 376, 377, 378, 379, 380, 381, 382, 383, 384, 385, 386, 387, 388, 389, 390, 391, 392, 393, 394, 395, 396, 397, 398, 399, 400, 401, 402, 403, 404, 405, 406, 407, 408, 409, 410, 411, 412, 413, 414, 415, 416, 417, 418, 419, 420, 421, 422, 423, 424, 425, 426, 427, 428, 429, 430, 431, 432, 433, 434, 435, 436, 437, 438, 439, 440, 441, 442, 443, 444, 445, 446, 447, 448, 449, 450, 451, 452, 453, 454, 455, 456, 457, 458, 459, 460, 461, 462, 463, 464, 465, 466, 467, 468, 469, 470, 471, 472, 473, 474, 475, 476, 477, 478, 479, 480, 481, 482, 483, 484, 485, 486, 487, 488, 489, 490, 491, 492, 493, 494, 495, 496, 497, 498, 499, 500, 501, 502, 503, 504, 505, 506, 507, 508, 509, 510, 511, 512, 513, 514, 515, 516, 517, 518, 519, 520, 521, 522, 523, 524, 525, 526, 527, 528, 529, 530, 531, 532, 533, 534, 535, 536, 537, 538, 539, 540, 541, 542, 543, 544, 545, 546, 547, 548, 549, 550, 551, 552, 553, 554, 555, 556, 557, 558, 559, 560, 561, 562, 563, 564, 565, 566, 567, 568, 569, 570, 571, 572, 573, 574, 575, 576, 577, 578, 579, 580, 581, 582, 583, 584, 585, 586, 587, 588, 589, 590, 591, 592, 593, 594, 595, 596, 597, 598, 599, 600, 601, 602, 603, 604, 605, 606, 607, 608, 609, 610, 611, 612, 613, 614, 615, 616, 617, 618, 619, 620, 621, 622, 623, 624, 625, 626, 627, 628, 629, 630, 631, 632, 633, 634, 635, 636, 637, 638, 639, 640, 641, 642, 643, 644, 645, 646, 647, 648, 649, 650, 651, 652, 653, 654, 655, 656, 657, 658, 659, 660, 661, 662, 663, 664, 665, 666, 667, 668, 669, 670, 671, 672, 673, 674, 675, 676, 677, 678, 679, 680, 681, 682, 683, 684, 685, 686, 687, 688, 689, 690, 691, 692, 693, 694, 695, 696, 697, 698, 699, 700, 701, 702, 703, 704, 705, 706, 707, 708, 709, 710, 711, 712, 713, 714, 715, 716, 717, 718, 719, 720, 721, 722, 723, 724, 725, 726, 727, 728, 729, 730, 731, 732, 733, 734, 735, 736, 737, 738, 739, 740, 741, 742, 743, 744, 745, 746, 747, 748, 749, 750, 751, 752, 753, 754, 755, 756, 757, 758, 759, 760, 761, 762, 763, 764, 765, 766, 767, 768, 769, 770, 771, 772, 773, 774, 775, 776, 777, 778, 779, 780, 781, 782, 783, 784, 785, 786, 787, 788, 789, 790, 791, 792, 793, 794, 795, 796, 797, 798, 799, 800, 801, 802, 803, 804, 805, 806, 807, 808, 809, 810, 811, 812, 813, 814, 815, 816, 817, 818, 819, 820, 821, 822, 823, 824, 825, 826, 827, 828, 829, 830, 831, 832, 833, 834, 835, 836, 837, 838, 839, 840, 841, 842, 843, 844, 845, 846, 847, 848, 849, 850, 851, 852, 853, 854, 855, 856, 857, 858, 859, 860, 861, 862, 863, 864, 865, 866, 867, 868, 869, 870, 871, 872, 873, 874, 875, 876, 877, 878, 879, 880, 881, 882, 883, 884, 885, 886, 887, 888, 889, 890, 891, 892, 893, 894, 895, 896, 897, 898, 899, 900, 901, 902, 903, 904, 905, 906, 907, 908, 909, 910, 911, 912, 913, 914, 915, 916, 917, 918, 919, 920, 921, 922, 923, 924, 925, 926, 927, 928, 929, 930, 931, 932, 933, 934, 935, 936, 937, 938, 939, 940, 941, 942, 943, 944, 945, 946, 947, 948, 949, 950, 951, 952, 953, 954, 955, 956, 957, 958, 959, 960, 961, 962, 963, 964, 965, 966, 967, 968, 969, 970, 971, 972, 973, 974, 975, 976, 977, 978, 979, 980, 981, 982, 983, 984, 985, 986, 987, 988, 989, 990, 991, 992, 993, 994, 995, 996, 997, 998, 999, 1000

1991 Recipient of  
Canton Twp.  
Beautification Award.

From  
**\$68,500**

12-5 Daily • Closed Thursday  
**981-6550**

SALES BY CENTURY 21, HARTFORD SOUTH, INC.

### Send Your Love Around The World.

All you have to do is call the toll-free number below and Christian Children's Fund will send you information about how you can help one of the world's needy children. Reach out. There's a child waiting for you. A child who desperately needs food, clothing or medical attention. And the brighter future your love can provide.

1-800-776-6707  
(Toll Free)

Christian  
Children's  
Fund, Inc.

## Grand Opening - Final Phase



*Laurd gardens*  
Luxury Condominiums  
ANN ARBOR

### Consider The Advantages

**The Location:** Adjacent to the U. of M. Biological Gardens, minutes from the center of town and freeway access — yet nestled in a peaceful country setting.

**The Choices:** Innovative ranch and two-story homes. Large rooms, wooden decks and enthralling views. Elegant appointments include designer kitchens and bathrooms with whirlpool tubs, fireplaces, soaring ceilings, and more!

**The Community:** From the moment you enter this distinguished gatehouse community, Laurel Gardens will become more than your private home. It will be your private resort, offering tennis courts, swimming pool and plush landscaped grounds.

**The Values:** From just \$169,500, Laurel Gardens is Ann Arbor's finest condominium buy.

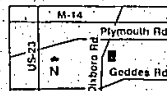

West 12345 21 daily, Closed Thursday  
Located on Division between  
Geddes and Plymouth  
Sales Center: 791 E. 557  
Brokers welcome  
Immediate Occupancy

The *Hometown* and *Observer* and *Eccentric* "Creative Living" section has the largest selection of suburban display real estate ads in the metro area.

## Now You Have Two Choices For Custom Quality Homes In Novi.

Singh Development Co., Ltd. has brought a commitment to quality to their two latest communities — Bradford of Novi and Westminister Village. Each exemplifies a philosophy that each community is more than just a place to live, it is a place for living.

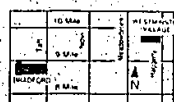

Bradford of Novi and  
Westminister Village  
Sales Offices

Open Daily 12-6,  
Closed Thursday

Singh Development Co., Ltd., Birmingham, MI • (313) 435-1100



- Four Distinctive Floor Plans, Including Ranches, Cape Cods and Colonials
- Estate Sized Half Acre
- Lots with Common Park Areas
- Vaulted & Cathedral Ceilings
- Bedrooms, 9', 10', 11', Attached 3 Car Garages
- Master Suites with Walk-in Closets and Whirlpool Tubs
- Great Northville Schools

**BRADFORD**  
(OF NOVI)

Call for info  
South of 10 Mile  
(313) 480-8008  
Prices from \$264,900



- Five Distinctive Floor Plans Including Ranches, Cape Cods and Colonials
- 3 & 4 Bedrooms, 2 1/2 Baths
- Dramatic Cathedral Ceilings
- Living, Family and Dining Rooms' Library
- Island Kitchen with Sock
- 2 Car Attached Garage
- Great Novi Schools

**Westminister  
Village**

Call for info  
South of 10 Mile  
(313) 442-2626  
Prices from \$164,900

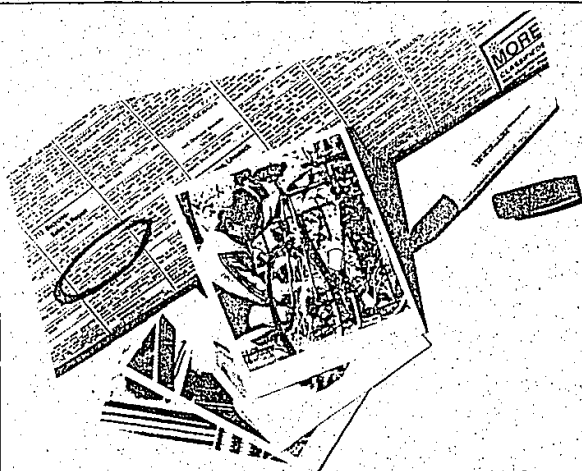

Classified makes life  
a lot more enjoyable.

The great outdoors. A weekend ride. A little exercise.  
And above all, a lot of fun.

Classified helps make it possible.  
Check our columns regularly  
for all types of recreational equipment  
ranging from bikes and boats to golf clubs and campers.

Enjoy!

**Observer & Eccentric**

CLASSIFIED ADVERTISING

644-1070 OAKLAND COUNTY 591-0900 WAYNE COUNTY  
852-3222 ROCHESTER ROCHESTER HILLS