

## The Green Thumb

By GEORGE ABRAHAM

**Snails and Slugs:** This is a good time to be on the watch for slugs or snails. Slugs are snails without shells. A snail is capable of withdrawing its body inside a hard shell. Slugs don't have the hard shell. Both lay eggs in masses of from a few to 40 or more, in a moist location, and one pest alone can lay as many as 100 eggs.

Snails do heavy damage because of the many "teeth" they have to satisfy their hungry appetite. One common slug in a garden or greenhouse has 85 teeth in a single row, and there are 100 rows, making a total of 8,500 teeth in a single critter.

Slugs live where there is dampness, since these night marauders like it moist during the day, when they hide under boards, leafy trash or stones. At night they do their dirty work. Slugs and snails travel along with a sliding movement on their "foot" exuding a slimy mucus to lubricate their trail. That silvery track you see on the ground or on plants is the mucus secreted by these gruesome pests.

**CONTROL:** Grow tomatoes on wire fence to keep them off the ground. In the garden or strawberry patch, place dampened shingles, boards, etc. between the rows so the pests will hide under them during the day, then go out and scrape them off and destroy.

Beer in pie plates around the tomato vines will attract and kill slugs. Beer is cheaper and safer to use than poisonous baits.

**CUCUMBERS AGAIN:** I've had many letters asking why cucumbers tend to produce nubbins or misshapen fruits. Nubbins and crooks among cucumbers, as we mentioned recently, are the result of improper pollination. Do not move the vines any more than necessary while cultivating or picking fruit. Moving the vines destroys blossoms, drives away bees, results in kinking and matting of vines, and tends to increase the number of misshapen fruits.

Cukes are very shallow rooted and sometimes roots will extend beyond the tips of the vines. That means after the vines have started to ramble freely, cultivation should stop. Bitter taste among cucumbers can be blamed on weather changes. Sharp drop in temperature following a warm spell causes bitterness.

**GREEN THUMB CLINIC:** A reader writes: "Please tell me what pulled my tomato and pepper plants out? I noticed they had been pulled right out of the ground, and some of the tips were snapped off."

Answer: Starlings or

grackles were probably responsible. They'll swoop down and snap the tips off, or even pull the plants out of the soil. Cover plants with bushel baskets or crates.

## Build-Your-Own Play Areas Inexpensive

Play areas needn't be lavish layouts with an array of expensive equipment. Many play items most children seem to enjoy can be built easily at home with western wood, as a way to keep children from roaming too far in search of fun.

One basic for smaller children is a sandbox. It should be big enough for several tots to move about in without crowding.

A solid box can be built of 2x12-inch western pine or fir,

on 4x4-inch posts set 18 inches in the ground. The wood should be surfaced to avoid splinters and treated with a preservative to resist decay.

**SEATING** can be added with a cap of eight of 10-inch boards around the box or on two sides, or by adding triangular pieces at corners. These also will lend strength to the box.

A sandbox should be built where it will be in the shade of a building or tree during the hottest part of the day.

A cover of plywood or chicken wire on a lightweight wood frame will keep cats out at night.

A variation is the sand table, about five by three feet, and set on 4x4-inch posts about coffee table height. The sides are of 1x6-inch boards, with a 1x2-inch cap. Bottom is 3/4-inch plywood.

The table can be moved into carport or garage on rainy days.

**ANOTHER** attraction children look for is something to climb, swing on, and jump from. This can be a simple L-shaped or rectangular frame of 4x4 or 4x6-inch fir or pine posts and beams, set securely in concrete.

Ropes can be secured to the beams for climbing, and ladders of 2x2-inch wood built onto the ends. A row of heavy dowels or pipes between two

## Pinch To Avoid Spindly Mums

Avoid long and spindly chrysanthemums this fall by proper pinching now, recommends a Michigan State University floriculturist.

William Carpenter says that pinching mums removes the young, growing tips. This makes the plants branch out. Plants don't get so long and spindly, and they produce more flowers, adds the floriculturist.

Pinching mums isn't difficult, he says. Just remove the top half inch of each shoot. This is usually done by pinching a shoot between the

thumb and forefinger, and then removing it.

A few days later, new side branches will start to form, explains the floriculturist. When side branches become about six inches long, pinch them.

Continue this procedure until about June 15 for early flowering varieties, July 1 for mid-season varieties and July 10 for late flowering varieties. After these dates, flower buds will be starting to form.

So remember, for better mums this year, pinch now.

**GREEN THUMB CLINIC:** A reader writes: "Please tell me what pulled my tomato and pepper plants out? I noticed they had been pulled right out of the ground, and some of the tips were snapped off."

Answer: Starlings or

grackles were probably responsible. They'll swoop down and snap the tips off, or even pull the plants out of the soil. Cover plants with bushel baskets or crates.

**SEATING** can be added with a cap of eight of 10-inch boards around the box or on two sides, or by adding triangular pieces at corners. These also will lend strength to the box.

A sandbox should be built where it will be in the shade of a building or tree during the hottest part of the day.

A cover of plywood or chicken wire on a lightweight wood frame will keep cats out at night.

**RUSTIC A-FRAME** — This easy-to-build vacation home combines year-round comfort and convenience. Fireplace is focal point of spacious living room. This is one of 20 designs previewed in "Great Ideas for Second Homes" which includes information on where to buy the plans. Portfolio is available for 50 cents from the American Plywood Association, 1119 A St., Tacoma, Wash. 98401. Ask for Form 69-610.

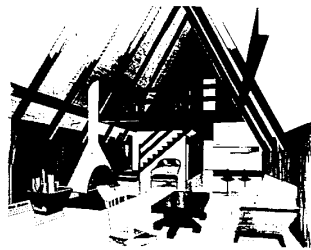

**ENJOY THE LUXURY OF RELAXING IN YOUR OWN BACK YARD**  
MAKE FUN A FAMILY AFFAIR with the investment that returns so much in health & physical fitness

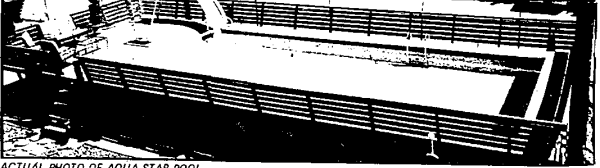

ACTUAL PHOTO OF AQUA STAR POOL  
16x32 SWIM AREA — 4-7 FOOT DEPTH  
BUY DIRECT — MANUFACTURED LOCALLY  
**AQUA STAR POOLS**  
425-8830  
OPEN: DAILY 9-9  
SUN. 10-7

**ALL NECESSARY ACCESSORIES INCLUDED**  
These pools, completely installed, including electric wiring, never require painting as they feature aluminum siding with baked enamel finish. All pure lead-free, pre-stained and sealed. Carpeted walk around deck and 8 foot patio for cool feet, sun which to choose. Enjoy year around fun, swim and skate on the strongest and most beautiful pool made. You furnish only the water.

**AVOID POLLUTION - TRAFFIC HAZARDS - CROWDED BEACHES**  
Enjoy healthy family fun with your own private RECREATION CENTER

SEE OUR DISPLAY AT 28875 JOY ROAD, WESTLAND  
3 Blocks East of Middlebelt  
PHONE 425-8830 • BANK TERMS AVAILABLE

**WHERE LUMBER is still the BOSS!**

**REDFORD CASHWAY LUMBER**

CASH OR CARD

ROYAL OAK 548-2153  
803 SOUTH MAIN  
Corner of Lincoln

LIVONIA 261-5110  
9770 FARMINGTON ROAD  
Between Schofield & Plymouth

WARREN 775-7000  
24620 SCHOENBERG ROAD  
Just South of 16 Mile Rd.

Royal Oak Warren Fri. 'til 8:30  
Nite 'til 8:30  
Livonia Thurs., Fri. 'til 8:30

**WRAP YOUR HOME IN ENDURING BEAUTY**

WITH

**REDFORD'S Aluminum SIDING**

THE NICEST THING YOU CAN DO FOR YOUR HOME... IS TO WRAP IT IN THE BEAUTY OF

- No Painting
- No Peeling
- No Rusting
- For PERMANENCE
- For BEAUTY
- For Added VALUE

• Fully Guaranteed LESS BACKER 25<sup>95</sup>

• Made from Reynolds Alum. 100 WITH 29<sup>95</sup> Sq. Ft. BACKER 100

FOR LAWN, PATIO AND GARDEN 4x6 SANTA ROSA ROUGH-SAWN REDWOOD 47<sup>95</sup> ft.

**MULE HIDE ROOFING**

Reg. 235 lb. \$9.79 Square Square-100 sq. ft. BUNDLE \$3<sup>27</sup>

Self-Seal 240 lb. \$10.39 Square Square-100 sq. ft. BUNDLE \$3<sup>47</sup>

Black and White in Standard Shingle  
Black, White plus 5 Pastel Colors in Sealdowns

**SAVE! Adjusted WROUGHT IRON**

4' Section \$5<sup>99</sup> ea. Other Sizes Available

**HARDBOARD**  
1/4" 4x8 Std. \$1.89  
1/2" 4x8 Temp. \$2.89

**PEGBOARD**  
1/8" 4x8 Std. \$2.39  
1/8" 4x8 Temp. \$3.29

**WHITE PINE SHELVING**  
1"x12" 17<sup>95</sup> ft.

**REDFORD LEADS THE WAY**

FULLY ASSEMBLED—GENUINE CALIFORNIA REDWOOD FENCE—BEST OF ALL—LOW EVERYDAY PRICES

Horizontal Weave Mill Treated With Pigmented Water Repellent Genuine Redwood

4x8 11<sup>85</sup>  
6x8 13<sup>85</sup>  
6x8 15<sup>85</sup>

3'x5' REDWOOD GATES 16<sup>95</sup>

1"x8" Woodface Top \$5.95

**YOU'LL LIKE OUR NEW SUMMER PRICES**

REDFORD — GARAGES

14'x20' HIP 20'x20' HIP  
16" OC. No. O/H 16" OC. No. O/H  
LOW AS 399<sup>00</sup> LOW AS 519<sup>00</sup>

• Grade marked Const. and Std. Lumber • D.V. redwood siding • 235-lb. Shingles • Trim — Over 30 Styles and Sizes.

**DUO-TEMP ALUMINUM COMB. DOORS**

PRE-HUNG SATURN MILL FINISH

2'x6" 24<sup>95</sup>  
2'x8" 24<sup>95</sup>  
3'x6" 24<sup>95</sup>

SATURN WHITE FINISH

2'x6" 24<sup>95</sup>  
2'x8" 24<sup>95</sup>  
3'x6" 24<sup>95</sup>

Our Most Popular Colonial Crossbuck

2'x6" 34<sup>95</sup>  
3'x6" 34<sup>95</sup>

PACEMAKER MILL FINISH

2'x6" 21<sup>95</sup>  
3'x6" 21<sup>95</sup>

**ASSOCIATION GRADE STAMPED CONSTRUCTION & STANDARD DIMENSION LUMBER**

	2x4	2x6	2x8	2x10	2x12	4x4
6'	83	98	1.62	1.97	1.68	1.68
8'	75	1.22	1.69	2.21	3.02	2.24
10'	1.31	1.47	2.24	2.88	3.94	2.89
12'	1.34	2.03	3.36	4.08	4.82	3.36
14'	1.58	2.37	3.58	4.81	5.52	4.92
16'	1.78	3.10	4.05	5.39	6.30	4.74

LONG LENGTHS AVAILABLE UP TO 26' IN MOST SIZES

**REDDI-DECK** FROM EP

READY TO INSTALL REDWOOD PATIO SECTIONS DO IT YOURSELF. BEAUTIFUL REDWOOD SQUARES. ASSEMBLE TO YOUR OWN DESIGN.

Nominal Size 2x2 4<sup>95</sup>

Nominal Size 3x3 7<sup>95</sup>

**PLYWOOD GOOD 1 SIDE**

	Interior	Exterior
1/4"-4x8	3.39	3.79
3/8"-4x8	4.49	4.79
1/2"-4x8	5.79	6.29
5/8"-4x8	6.79	7.29
3/4"-4x8	7.69	8.39

**DRY-WALL**

	1/2"	5/8"	1"
4x7	3.69	1.79	1.79
4x8	1.69	1.89	1.89
4x10	2.69	2.89	2.89

**PARTICLE BOARD UNDER LAYMENT**  
Save on Quantity Price

	4x8	PIECE	25 up
3/8"	2.89	2.79	
1/2"	3.09	2.99	
5/8"	3.39	3.29	
3/4"	5.79	5.69	

**WHITE PINE SHORTS**

	6'	8'
1x4	.35	.49
1x6	.55	.69
1x8	.69	.89

**Utility 2" x 4" 8' 69<sup>00</sup>**

**In The Way A Room Looks, Too... WHAT'S UP TOP**

Makes a Big Difference!

**SUSPENDED CEILING**

COMPLETE with HEAVY DUTY GRID SYSTEM

COMPARE OUR LOW PRICE AND YOU WON'T GO ANYWHERE ELSE! Includes everything you need — white ceiling panels, grid system main runners and tees, suspension hangers and hanger wire — and it's easy to install. Accented and patterned panels also available.

PLAIN WHITE 9'ea. 18<sup>00</sup> sq. ft.

ACoustical 12'ea.

**COMBINATION DOORS**

	ALUMINUM 32x88 and 32x96	CROSSBUCK 32x88 and 32x96
Pre Hung	\$19 <sup>95</sup>	\$39 <sup>95</sup>

**ALLEN LUMBER CO**

21645 GRAND RIVER 27540 MICHIGAN (near Lahser) KE 2-0805 (at Inkster) LO 3-1600

OPEN DAILY 8:30-5:30 SAT. 10-5 P.M. OPEN DAILY 8:30-5:30 SAT. 10-5 P.M.

BANKAMERICARD • MASTER CHARGE • INSTANT CREDIT