

EXHIBITIONS

Send calendar items about Oakland County art gallery exhibitions to The Observer, 805 E. Maple, Birmingham 48003, fax 844-1214. Send items about Wayne County exhibitions to The Observer, 36251 Schoolcraft, Livonia 48150, fax 591-7279. Attention: Creative Living editor.

MEADOWBROOK VILLAGE

Friday, Oct. 15 — A display of photography by Observer & Eclectic columnist Monte Nagler continues to Oct. 24. Reception for the artist 7-9 p.m. Friday. A portion of all proceeds from this exhibit will be donated to the Rainbow Connection, a Michigan-based, non-profit organization that grants wishes to children with life-threatening illnesses. Nagler will be in attendance during the exhibit. Hours are 10 a.m. to 9 p.m. Monday-Saturday, noon to 5 p.m. Sunday. Walton at Adams in Rochester Hills.

LAWRENCE STREET GALLERY Friday, Oct. 15 — "Allegorical Work," an exhibit of paintings by Detroit psychologist Arnold Dreifuss, continues through Nov. 12. Opening reception for the artist 6-9 p.m. Friday. Dreifuss' award-winning paintings represent attempts to resolve problems of opposing forces. Hours are 11 a.m. to 4 p.m. Tuesday-Thursday, 11 a.m. to 9 p.m. Friday, 29 W. Lawrence, Pontiac 334-6716.

ALEXA LEE GALLERY Friday, Oct. 15 — "Grand Opening Exhibition: Part I" continues to Nov. 13, showcasing artists represented by the gallery (printmakers Fred Hagstrom of Minnesota and Bruce Thayer of Mason, Mich., painter Lila Kadel of Detroit, sculptor Lincoln Shatz of Chicago and the New Edition prints from Tandem Press in Wisconsin). Reception 6-8 p.m. Friday. The new gallery offers fine art, custom framing and art services. Hours are 10 a.m. to 6 p.m. Tuesday-Saturday and by appointment, above the post office at 201 Nickels Arcade in Ann Arbor, 663-8800.

DETROIT ARTISTS MARKET Friday, Oct. 15 — "Still Life: Motif — 10 Painters" will run through Nov. 12. Opening 5-8 p.m. Friday. Curated by Robert Wilbert, the exhibit features works by Mary Ann, Elizabeth Crank, Peter Gillman, Lila Kadel, Michael Mahoney, Nancy Mitter, Jens Plum, Julie Sereny, Athir Shayota and Claudia Shepard. The artists were selected because their work "is marked by a sustained belief in the continuing relevance of this traditional motif." Hours are 11 a.m. to 5 p.m.

Tuesday-Thursday and Saturday, 11 a.m. to 8 p.m. Friday, 300 River Place, Suite 1650, Detroit, 393-1770.

SUSANNE HILBERY GALLERY Saturday, Oct. 16 — An exhibit of new paintings by native Detroit John Corbin will continue through Nov. 13. Dialogue between Corbin and poet Lynn Crawford 8 p.m. reception to meet the artist 6-8 p.m. Saturday. Corbin creates unusual and exciting paintings using the jigsaw puzzle. Hours are 11 a.m. to 6 p.m. Tuesday-Saturday, 555 S. Woodward, Birmingham, 642-8230.

SYBARIAN GALLERY Saturday, Oct. 16 — A one-person exhibit of new fiber works by Gerhard Knodel, including a site-specific installation, will continue through Nov. 13. Reception for the artist 6-8 p.m. Saturday. Knodel, artist-in-residence and head of the fiber department at the Cranbrook Academy of Art in Bloomfield Hills since 1970, initiated the genre of modular suspended fabric environments that played on cloth's flexibility, mobility and sensitivity to light. Hours are 11 a.m. to 5 p.m. Tuesday-Saturday, 202 E. Third, Royal Oak 544-3388.

UNIVERSITY OF MICHIGAN MUSEUM OF ART To Nov. 28 — "From Mother Earth: Pueblo Pottery Along the Rio Grande," a selection of black ware pottery from the pueblos of Santa Clara and San Ildefonso, with works by Maria Martinez and other renowned potters, is featured. Also, photo-collage works by David artist Hannah Hoch are shown to Nov. 28, and German expressionist graphics from the museum collection are displayed to Dec. 6. Events related to the Hoch exhibit are a cabaret evening Oct. 16, a lecture and reception Oct. 17, tours Oct. 24 and 31, art videos Oct. 20 and a lecture Nov. 19. Call for information. Hours are 10 a.m. to 5 p.m. Tuesday-Saturday, noon to 5 p.m. Sunday, 525 S. State, Ann Arbor, 764-0295.

DETROIT INSTITUTE OF ARTS Sunday, Oct. 17 — "Step Lively: The Art of the Folk Cane" continues through Nov. 28, featuring 92 canes from the collection of Bloomfield Hills attorney George Meyer. Meyer and his wife, Kay White Meyer, wrote the award-winning catalog, "American Folk Art Canes — Personal Sculpture." "Defining the African-American Cane," a free, slide-illustrated talk by Art Institute of Chicago associate curator Ramon Austin, will take place 2 p.m. Sunday in the Lecture Hall. The

Meyers will present a free, slide-illustrated lecture, "Handcarved American Canes: Personal Sculpture that Took into History," 2 p.m. Sunday, Nov. 28, in the Lecture Hall. A book signing will follow the Meyers' talk. Also, "Once Upon a Matrix: The Variable Nature of Prints," a didactic exhibit illustrating the diverse choices and conditions that influence the final appearance of a print, continues through Jan. 2. Included are more than 100 woodcuts, engravings, etchings and lithographs from the permanent collection, featuring duplicate line drawings and blocks and plates from which prints are pulled. Douglas Semivan, artist and assistant professor of art at Madonna University, will give a gallery talk in the exhibit 2 p.m. Sunday, Oct. 5. Hours are 11 a.m. to 4 p.m. Wednesday-Friday, 11 a.m. to 6 p.m. weekends, 5200 Woodward, Detroit. Recommended admission is \$4 for adults; \$1 for children, seniors and students; free for members. Call 833-7300.

ELIZABETH STONE GALLERY Sunday, Oct. 18 — A collection of original art by Massachusetts book illustrator Michael McCurdy will be showcased at the gallery's new location, 536 N. Woodward in Birmingham. Grand opening reception for the artist 7-10 p.m. Sunday. Call 647-7040.

THE COMMUNITY HOUSE Wednesday, Oct. 20 — The eighth annual Our Town Art Exhibition and Sale will present works by 199 artists from around Michigan Thursday-Sunday, Oct. 21-24. Special events are a gala preview Wednesday, a breakfast with a talk by juror Allen Rubiner of the Rubiner Gallery in West Bloomfield, a luncheon with a tour of private art collections in the Birmingham-Bloomfield area, a party with live jazz, a children's workshop and an artists reception and awards ceremony. Exhibit hours are 10 a.m. to 5 p.m., 380 S. Bates, Birmingham. Admission to the show is free. Call 644-5832 for special events information and reservations.

BIRMINGHAM-BLOOMFIELD ART ASSOCIATION To Oct. 15 — The 1993 Birmingham Society of Women Painters exhibit, "Environments," continues. This year the show includes a separate, non-juried section entitled "For Love of the BBA," for which each member of the BSWP donated a small painting, with all proceeds to benefit the BBA building expansion. Also, paintings by French artist Madeleine Ginot are exhibited to Oct. 30. In brilliant colors, Ginot

portrays scenes of daily life, marketplaces and landscapes of the South of France. Her paintings convey her own fascination in people interacting at work, in the streets, at markets and in cafes. Hours are 9:30 a.m. to 4:30 p.m. Monday-Saturday, 1516 S. Cranbrook Road, Birmingham, 644-0968.

SOUTHWEST CIVIC CENTER Through Oct. 15 — Michigan Outdoor Sculpture IV exhibits sculpture by 20 Michigan artists at 2500 Evergreen between 10 Mile and 11 Mile.

LILA Through Oct. 16 — Stephen Lisky of Detroit is the first artist to exhibit at the new gallery, which is owned and operated by Royal Oak artist and antique dealer Lulu Cameron. Hours are 11 a.m. to 5 p.m. Monday-Saturday, to 9 p.m. Thursday, 405 N. Main, Royal Oak, 542-6464.

G.R. N'AMDI GALLERY To Oct. 17 — The works of Detroit native Ali Loving are exhibited, along with prints by internationally renowned artist Jacob Lawrence. Hours are 11 a.m. to 4 p.m. Tuesday-Saturday, 1-4 p.m. Sunday, 161 Townsend, Birmingham, 642-7000.

CREATIVE ARTS CENTER Through Oct. 21 — An exhibit of work by eight Latin American artists commemorates Hispanic Heritage Month while acknowledging and celebrating the Year of the Indian. In conjunction, a series of interdisciplinary classes and educational tours will be offered. Hours are 10 a.m. to 4 p.m. Tuesday-Friday, 47 Williams, Pontiac, 333-7849.

JEAN PAUL SLUSSER GALLERY Through Oct. 22 — An exhibit of recent work by distinguished University of Michigan alumnus William Lewis, in conjunction with the 1993 Distinguished Alumnus Award, continues. Award presentation and special lecture by the artist 3:30-5 p.m. Oct. 22 at the School of Art, Room 2104, followed by a reception at the gallery 5-6 p.m. Hours are 11 a.m. to 5 p.m. Tuesday-Saturday, Art and Architecture Building, the U-M School of Art, 2000 Bonisteel Blvd., Ann Arbor, 764-0337.

HABATAT GALLERIES Through Oct. 23 — Laminated, cut and polished glass and granite sculpture by American artist William Carlson, and colorful, fused sculpture by master Australian artist Klaus Moja, are exhibited. Hours are 10 a.m. to 6 p.m. Tuesday-Saturday, 32255 Northwest Highway, Farmington Hills, 851-9090.

RUBINER GALLERY To Oct. 24 — Landscape paintings are exhibited. Introducing romantic realist watercolor canvases by Stephen Dinamore of Minneapolis and dimensional constructions by Mark Mahosky of Allentown, Pa. Also, a series of new bench paintings by John Ross Michaels and recent landscape paintings by Lowell Bellows, Vicki Best, Ingrid Capozzoli, Marjorie Hecht, Rick Stevens, Andrew Paezco, Nancy Thayer and Carol Summers. Hours are 11 a.m. to 5 p.m. Tuesday-Saturday or by appointment, 7001 Orchard Lake Road, Suite 400A, West Bloomfield, 626-3111.

MATRIX GALLERY Through Oct. 24 — "Spirit and Place: Landscape as Meditation," art as contemplative encounter by Jim Mott of New York, continues. Hours are 2-7 p.m. Friday, noon to 5 p.m. Saturday-Sunday, 212 Miller, 1-1/4 blocks west of Main in Ann Arbor, 663-7775.

HABATAT/SHAW GALLERY To Oct. 30 — An exhibit of sculpture by Graham Marks continues. Hours are 10 a.m. to 6 p.m. Tuesday-Saturday, 32255 Northwest Highway, Farmington Hills, 851-8767.

ROCHESTER HILLS CITY HALL Through October — Paint Creek Center for the Arts students, Elise Pedersen display their paintings, part of the Art in Public Places program sponsored by the PCCA. Hours are 8 a.m. to 5 p.m. Monday-Friday, 1000 Rochester Hills Drive off Avon Road. For more information, call the PCCA at 851-4110.

JANICE CHARACH EPSTEIN MUSEUM/GALLERY Through Oct. 31 — "Rescuers of the Holocaust," portraits by Gay Block, continues. This acclaimed photo documentary features extraordinary people who provided shelter and safety to Jews during the desperate times of Nazi terror. A videotape accompanies the exhibit. The second-floor gallery explores the emotional experiences of the Hidden Children now living in the metropolitan area, through photographs and personal accounts recorded on videotape. Docent tours are available for the exhibit. The museum/gallery is in the Jewish Community Center, 600 W. Maple, Royal W. Maple, 354-1272, for information or tour reservations.

PRIVATE COLLECTION GALLERY Through Oct. 31 — Glass tables

by Joan Irving are featured. Hours are 11 a.m. to 5 p.m. Monday-Saturday, noon to 3 p.m. Sunday, 6736A Orchard Lake Road, West Bloomfield, 737-4050.

WARREN CITY HALL GALLERY To Oct. 31 — Photography by Herbert Wolf of Detroit is displayed. Hours are 9 a.m. to 5 p.m. Monday-Friday, 29500 Van Dyke Road.

LA BELLE PROVENCE During October — The European antiques and interior design store will donate 10 percent of all sales of Quimper pottery and Limoges porcelain boxes to Orchards Children's Services. La Belle Provence is at 119 N. Center in Northville. Call 347-4333.

ARIANA GALLERY To Nov. 1 — Torn and stitched watercolor constructions by Kate Ward Thacker are exhibited. Thacker is a colorist, involved in constant experimentation with color combinations contained in simple geometric shapes. Her paper quilts develop illusions of movement, space, transparency, depth and shimmer. Hours are 10 a.m. to 6 p.m. Monday-Saturday, 386 E. Maple, Birmingham, 647-6405.

OAKLAND COUNTY GALLERY Through Nov. 1 — "Point of View 1993," works by the Palette and Brush Club, continues. Watercolor, acrylics and oils by metropolitan Detroit artists are featured. Robert Sharp, a professor of drawing and painting at Eastern Michigan University, was juror for the display. Hours are 8:30 a.m. to 5 p.m. Monday-Friday, in the County Service Center, 1200 N. Telegraph in Pontiac. Call the Office of Cultural Affairs at 858-0145 for more information.

PARK WEST GALLERY To Nov. 4 — An exhibit of more than 40 impressionist paintings by Claude Cambrour continues. The French artist's style is characterized by shimmering sunlight and pure, luminous colors. Hours are 10 a.m. to 6 p.m. Monday-Wednesday, 10 a.m. to 9 p.m. Thursday-Friday, 11 a.m. to 6 p.m. Saturday-Sunday, 29469 Northwestern Highway, Southfield, 354-2343.

1st Metro MORTGAGE

30 yr. FIXED - 6.75% A.P.R. 6.95%
15 yr. FIXED - 6.25% A.P.R. 6.48%
1 Year Arm - 3.875% A.P.R. 5.4%

O Closing Cost Loans Available

\$200 OFF Closing Costs With This Ad

CALL LOU BOUDREAU • 851-3440
 5635 W. MAPLE • WEST BLOOMFIELD

SECURITY home loan

Mc Clemens • Troy • Southfield • Walled Lake
 "Call us after you have called everyone else"

CURRENT JUMBO RATES*

	APR
30 yr 7.000 / 0 pts	7.005
30 yr 7.125 / No Cost	7.125
30 yr 7.250 / FREE	7.255
15 yr 6.500 / 0 pts	6.505
15 yr 6.625 / No Cost	6.625
ARM 4.000 / 0 pts	4.005

CALL 1-800-968-2019 NOW

FOR THE BEST RATES

*RATES SUBJECT TO CHANGE WITHOUT NOTICE
 NO INTEREST ADJ. NO ESCROW FEES. CALL FOR
 DETAILS. AVAILABLE ON ALL LOANS

Century 21
 East, Inc.

2700 South Rochester Road
 Rochester Hills, Michigan 48307

299-6200

1992 CENTURY 21 International Award Winning Office



LAND CONTRACT TERMS, 2000 Sq. Ft. contemporary home overlooking all sports Long Lake. 3 bedrooms, 2 baths, hot tub, sun porch, extensive decking, all appliances, 2 story garage, \$125,000 (BOL) 299-6200

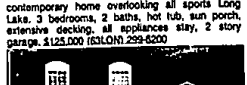

GREAT PRICE! Sharp brick/aluminum 2 story, finished basement, family room, fireplace, conditioning, deck, many extras. \$132,900 (25PRO) 299-6200



UNMATCHED QUALITY, 3200 Sq. Ft. of custom construction on 1.9 acres of unenclosed privacy, 4 bedrooms, 2 1/2 baths, 3 car garage, built on a beautiful wooded lot. \$310,000 (800R) 299-6200

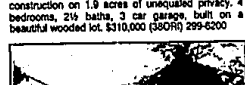

QUALITY BUILT RANCH, On 2 acres, 4 bedrooms, 2 1/2 baths, finished walk-out cathedral ceilings, skylights, security alarm and much more. \$134,900 (4WAL) 299-6200

EXPLORE A NEW CAREER
 Where Effort = Income
 One Hour Could Change Your Life
 Wednesday Evening 7 P.M.
 Limited Seating - Call Today

299-6200

EACH OFFICE IS INDEPENDENTLY OWNED AND OPERATED



MOVE-IN CONDITION. Best describes this 3 bedroom ranch with basement, 2 car garage, deck, patio, air conditioning, many extras. \$117,900 (66AL) 299-6200

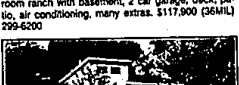

MINT CONDITION. Perfect for 1st time buyers. 3 bedrooms, home and landscaping spotless, many updates, 1st floor laundry and air conditioning, heated solid garage, big fenced yard. \$29,500 (4PRN) 299-6200

MORTGAGE RATE UPDATE

ADVANCE MORTGAGE CORP. 732-2323

15 yr. Fi. 6.50 0.00 30 day 3.99 0.13apr
 15 yr. Fi. 6.75 0.00 30 day 4.29 0.13apr
 15 yr. Fi. 7.00 0.00 30 day 4.59 0.13apr
 15 yr. Fi. 7.25 0.00 30 day 4.89 0.13apr
 15 yr. Fi. 7.50 0.00 30 day 5.19 0.13apr
 15 yr. Fi. 7.75 0.00 30 day 5.49 0.13apr
 15 yr. Fi. 8.00 0.00 30 day 5.79 0.13apr
 15 yr. Fi. 8.25 0.00 30 day 6.09 0.13apr
 15 yr. Fi. 8.50 0.00 30 day 6.39 0.13apr
 15 yr. Fi. 8.75 0.00 30 day 6.69 0.13apr
 15 yr. Fi. 9.00 0.00 30 day 6.99 0.13apr
 15 yr. Fi. 9.25 0.00 30 day 7.29 0.13apr
 15 yr. Fi. 9.50 0.00 30 day 7.59 0.13apr
 15 yr. Fi. 9.75 0.00 30 day 7.89 0.13apr
 15 yr. Fi. 10.00 0.00 30 day 8.19 0.13apr
 15 yr. Fi. 10.25 0.00 30 day 8.49 0.13apr
 15 yr. Fi. 10.50 0.00 30 day 8.79 0.13apr
 15 yr. Fi. 10.75 0.00 30 day 9.09 0.13apr
 15 yr. Fi. 11.00 0.00 30 day 9.39 0.13apr
 15 yr. Fi. 11.25 0.00 30 day 9.69 0.13apr
 15 yr. Fi. 11.50 0.00 30 day 9.99 0.13apr
 15 yr. Fi. 11.75 0.00 30 day 10.29 0.13apr
 15 yr. Fi. 12.00 0.00 30 day 10.59 0.13apr
 15 yr. Fi. 12.25 0.00 30 day 10.89 0.13apr
 15 yr. Fi. 12.50 0.00 30 day 11.19 0.13apr
 15 yr. Fi. 12.75 0.00 30 day 11.49 0.13apr
 15 yr. Fi. 13.00 0.00 30 day 11.79 0.13apr
 15 yr. Fi. 13.25 0.00 30 day 12.09 0.13apr
 15 yr. Fi. 13.50 0.00 30 day 12.39 0.13apr
 15 yr. Fi. 13.75 0.00 30 day 12.69 0.13apr
 15 yr. Fi. 14.00 0.00 30 day 12.99 0.13apr
 15 yr. Fi. 14.25 0.00 30 day 13.29 0.13apr
 15 yr. Fi. 14.50 0.00 30 day 13.59 0.13apr
 15 yr. Fi. 14.75 0.00 30 day 13.89 0.13apr
 15 yr. Fi. 15.00 0.00 30 day 14.19 0.13apr
 15 yr. Fi. 15.25 0.00 30 day 14.49 0.13apr
 15 yr. Fi. 15.50 0.00 30 day 14.79 0.13apr
 15 yr. Fi. 15.75 0.00 30 day 15.09 0.13apr
 15 yr. Fi. 16.00 0.00 30 day 15.39 0.13apr
 15 yr. Fi. 16.25 0.00 30 day 15.69 0.13apr
 15 yr. Fi. 16.50 0.00 30 day 15.99 0.13apr
 15 yr. Fi. 16.75 0.00 30 day 16.29 0.13apr
 15 yr. Fi. 17.00 0.00 30 day 16.59 0.13apr
 15 yr. Fi. 17.25 0.00 30 day 16.89 0.13apr
 15 yr. Fi. 17.50 0.00 30 day 17.19 0.13apr
 15 yr. Fi. 17.75 0.00 30 day 17.49 0.13apr
 15 yr. Fi. 18.00 0.00 30 day 17.79 0.13apr
 15 yr. Fi. 18.25 0.00 30 day 18.09 0.13apr
 15 yr. Fi. 18.50 0.00 30 day 18.39 0.13apr
 15 yr. Fi. 18.75 0.00 30 day 18.69 0.13apr
 15 yr. Fi. 19.00 0.00 30 day 18.99 0.13apr
 15 yr. Fi. 19.25 0.00 30 day 19.29 0.13apr
 15 yr. Fi. 19.50 0.00 30 day 19.59 0.13apr
 15 yr. Fi. 19.75 0.00 30 day 19.89 0.13apr
 15 yr. Fi. 20.00 0.00 30 day 20.19 0.13apr
 15 yr. Fi. 20.25 0.00 30 day 20.49 0.13apr
 15 yr. Fi. 20.50 0.00 30 day 20.79 0.13apr
 15 yr. Fi. 20.75 0.00 30 day 21.09 0.13apr
 15 yr. Fi. 21.00 0.00 30 day 21.39 0.13apr
 15 yr. Fi. 21.25 0.00 30 day 21.69 0.13apr
 15 yr. Fi. 21.50 0.00 30 day 21.99 0.13apr
 15 yr. Fi. 21.75 0.00 30 day 22.29 0.13apr
 15 yr. Fi. 22.00 0.00 30 day 22.59 0.13apr
 15 yr. Fi. 22.25 0.00 30 day 22.89 0.13apr
 15 yr. Fi. 22.50 0.00 30 day 23.19 0.13apr
 15 yr. Fi. 22.75 0.00 30 day 23.49 0.13apr
 15 yr. Fi. 23.00 0.00 30 day 23.79 0.13apr
 15 yr. Fi. 23.25 0.00 30 day 24.09 0.13apr
 15 yr. Fi. 23.50 0.00 30 day 24.39 0.13apr
 15 yr. Fi. 23.75 0.00 30 day 24.69 0.13apr
 15 yr. Fi. 24.00 0.00 30 day 24.99 0.13apr
 15 yr. Fi. 24.25 0.00 30 day 25.29 0.13apr
 15 yr. Fi. 24.50 0.00 30 day 25.59 0.13apr
 15 yr. Fi. 24.75 0.00 30 day 25.89 0.13apr
 15 yr. Fi. 25.00 0.00 30 day 26.19 0.13apr
 15 yr. Fi. 25.25 0.00 30 day 26.49 0.13apr
 15 yr. Fi. 25.50 0.00 30 day 26.79 0.13apr
 15 yr. Fi. 25.75 0.00 30 day 27.09 0.13apr
 15 yr. Fi. 26.00 0.00 30 day 27.39 0.13apr
 15 yr. Fi. 26.25 0.00 30 day 27.69 0.13apr
 15 yr. Fi. 26.50 0.00 30 day 27.99 0.13apr
 15 yr. Fi. 26.75 0.00 30 day 28.29 0.13apr
 15 yr. Fi. 27.00 0.00 30 day 28.59 0.13apr
 15 yr. Fi. 27.25 0.00 30 day 28.89 0.13apr
 15 yr. Fi. 27.50 0.00 30 day 29.19 0.13apr
 15 yr. Fi. 27.75 0.00 30 day 29.49 0.13apr
 15 yr. Fi. 28.00 0.00 30 day 29.79 0.13apr
 15 yr. Fi. 28.25 0.00 30 day 30.09 0.13apr
 15 yr. Fi. 28.50 0.00 30 day 30.39 0.13apr
 15 yr. Fi. 28.75 0.00 30 day 30.69 0.13apr
 15 yr. Fi. 29.00 0.00 30 day 30.99 0.13apr
 15 yr. Fi. 29.25 0.00 30 day 31.29 0.13apr
 15 yr. Fi. 29.50 0.00 30 day 31.59 0.13apr
 15 yr. Fi. 29.75 0.00 30 day 31.89 0.13apr
 15 yr. Fi. 30.00 0.00 30 day 32.19 0.13apr
 15 yr. Fi. 30.25 0.00 30 day 32.49 0.13apr
 15 yr. Fi. 30.50 0.00 30 day 32.79 0.13apr
 15 yr. Fi. 30.75 0.00 30 day 33.09 0.13apr
 15 yr. Fi. 31.00 0.00 30 day 33.39 0.13apr
 15 yr. Fi. 31.25 0.00 30 day 33.69 0.13apr
 15 yr. Fi. 31.50 0.00 30 day 33.99 0.13apr
 15 yr. Fi. 31.75 0.00 30 day 34.29 0.13apr
 15 yr. Fi. 32.00 0.00 30 day 34.59 0.13apr
 15 yr. Fi. 32.25 0.00 30 day 34.89 0.13apr
 15 yr. Fi. 32.50 0.00 30 day 35.19 0.13apr
 15 yr. Fi. 32.75 0.00 30 day 35.49 0.13apr
 15 yr. Fi. 33.00 0.00 30 day 35.79 0.13apr
 15 yr. Fi. 33.25 0.00 30 day 36.09 0.13apr
 15 yr. Fi. 33.50 0.00 30 day 36.39 0.13apr
 15 yr. Fi. 33.75 0.00 30 day 36.69 0.13apr
 15 yr. Fi. 34.00 0.00 30 day 36.99 0.13apr
 15 yr. Fi. 34.25 0.00 30 day 37.29 0.13apr
 15 yr. Fi. 34.50 0.00 30 day 37.59 0.13apr
 15 yr. Fi. 34.75 0.00 30 day 37.89 0.13apr
 15 yr. Fi. 35.00 0.00 30 day 38.19 0.13apr
 15 yr. Fi. 35.25 0.00 30 day 38.49 0.13apr
 15 yr. Fi. 35.50 0.00 30 day 38.79 0.13apr
 15 yr. Fi. 35.75 0.00 30 day 39.09 0.13apr
 15 yr. Fi. 36.00 0.00 30 day 39.39 0.13apr
 15 yr. Fi. 36.25 0.00 30 day 39.69 0.13apr
 15 yr. Fi. 36.50 0.00 30 day 39.99 0.13apr
 15 yr. Fi. 36.75 0.00 30 day 40.29 0.13apr
 15 yr. Fi. 37.00 0.00 30 day 40.59 0.13apr
 15 yr. Fi. 37.25 0.00 30 day 40.89 0.13apr
 15 yr. Fi. 37.50 0.00 30 day 41.19 0.13apr
 15 yr. Fi. 37.75 0.00 30 day 41.49 0.13apr
 15 yr. Fi. 38.00 0.00 30 day 41.79 0.13apr
 15 yr. Fi. 38.25 0.00 30 day 42.09 0.13apr
 15 yr. Fi. 38.50 0.00 30 day 42.39 0.13apr
 15 yr. Fi. 38.75 0.00 30 day 42.69 0.13apr
 15 yr. Fi. 39.00 0.00 30 day 42.99 0.13apr
 15 yr. Fi. 39.25 0.00 30 day 43.29 0.13apr
 15 yr. Fi. 39.50 0.00 30 day 43.59 0.13apr
 15 yr. Fi. 39.75 0.00 30 day 43.89 0.13apr
 15 yr. Fi. 40.00 0.00 3