

PLYMOUTH
BIRMINGHAM
ANN ARBOR
DETROIT
ROCHESTER

200 N. MAIN ST.
200 N. WOODWARD
200 N. HARTZ RD.
1200 W. HARTZ RD.
1200 W. HARTZ RD.

PL 313-455-6000
PL 313-455-6000
PL 313-455-6000
PL 313-455-6000
PL 313-455-6000



SPLISH-SPLASH
Spend summer afternoons in a built-in Gunite pool, or relax in your private yard on your patio. The large family room has a wood-burning stove and newer carpeting. 3 bedrooms and 2 full baths are waiting for you! ML#528418
\$99,800 (313) 455-6000



VINTAGE HOME
Extensively updated on nearly one acre. Immediately available for home or potential office zoning. Very well constructed and maintained. ML#507095
\$215,000 (313) 455-6000



OUTSTANDING QUALITY AND DETAIL AROUND
In this 4 bedroom Garish built Tudor. Ceramic tile front porch w/double beveled glass entry, large deck overlooking mature grounds. Updates: surround sound, carpet, and custom mirror work. ML#527886
\$299,900 (313) 455-6000



EXQUISITE!!!
Four bedroom, 3 full & 2 half bath Tudor in Plymouth's prestigious Woodlone North. Soaring ceilings, 2 staircases, fabulous master bedroom & bath, walkout basement...A must see!! ML#515116
\$465,000 (313) 455-6000



AIRY & ELEGANT!!!
This condo awaits the sophisticated buyer seeking a golf course community with a court & pool. 2100 sq. ft. of perfection! Jacuzzi bath, soaring ceilings, creamy carpeting, custom mirror work. ML#528089
\$229,900 (313) 455-6000

I want an "exciting career"!
WHAT'S INVOLVED IN BECOMING A REAL ESTATE AGENT... CALL TO ATTEND OUR SEMINAR ON OUR "FREE" TRAINING PROGRAM & LEARN ABOUT BUSINESS EXPENSES AND THE INCOME POTENTIAL
Call for an appointment for our June 20th seminar.
CALL 313-455-6000
Ask for Phyllis or Pat

Master suite in this house plan isolated from day-to-day living

If the privacy of a well-isolated master suite is important to you, consider the Kearney. The master suite and second bedroom couldn't be much farther apart. For the couple with an older child still at home, or empty nesters who need a spare room for guests, this arrangement is beneficial.

Luxuries in the master suite, where a large bay window brings the sunshine inside, include a skylight bathroom with separate toilet and twin basins, a large closet, and private access to a small back patio, where an optional spa can ease away the cares of the day.

Dining room and family room flow together, with a wide hearth to take away the chill. This bright skylight area, with built-in entertainment center, is a great place for family and friends to gather for hours of fun watching television, listening to music or just enjoying each others company. A full bathroom, with dual access, separates the family room and second bedroom.

The large, vaulted living room has a big bay window looking out over the covered porch to the front yard. This room also flows into the dining area, enhancing the open feeling of the house.

For the cook in the house, the spacious walk-in kitchen is sure to please. Conveniently located for easy serving, the kitchen has all the built-ins plus a pantry and room for a washer and dryer. With direct passage to the two-car garage, groceries can be easily brought inside. Extra room is available in the garage for storage or it can be used as a workshop for the do-it-yourself person that likes to tackle tough projects.

For the lazy days of summer, there is a large back deck. Here friends and relatives can fire up the barbecue and savor each other's company along with the sunshine and food.

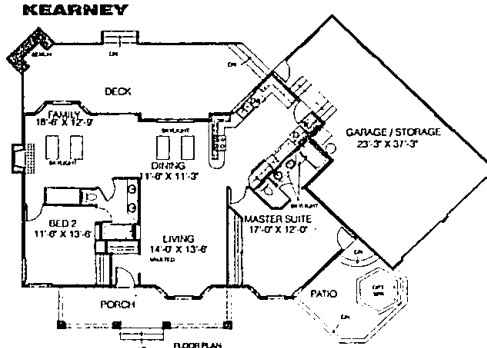
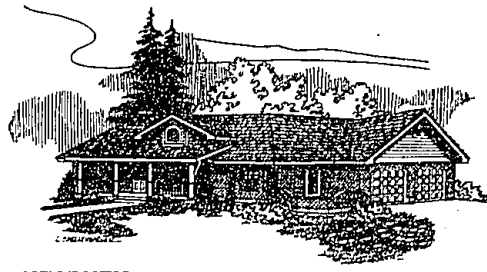

The Kearney: Overall dimensions of the Kearney are 77 feet 6 inches by 48 feet 9 inches.

For a study kit of the KEARNEY (334-060), send \$9. to Landmark Designs, P.O. BOX 2307-0E48, Eugene, OR 97402 (Be sure to specify plan name & number)

For a collection of plan books featuring Landmark's most popular house plans, send \$20 to Landmark.

GRAND OPENING

ISN'T IT
TIME
YOU PUT
DOWN
SOME
ROOTS?



Introducing Pinewood At Pheasant Run, Robertson Brothers' luxurious new community of single-family homes



Prestigiously located in rapidly growing Canton, Pinewood features everything you'd expect from a Robertson Brothers community. Luxuriously appointed 3 and 4 bedroom, 2-1/2 bath colonial and 1-1/2 story models with cathedral ceilings and flowing floor plans. Gorgeous grounds that include open areas, sidewalks and tree-lined streets. And a location that can't be beat. Pinewood is just minutes away from Canton's newest recreational center, Summit on the Park, the beautiful Pheasant Run Golf Course, Canton/Plymouth schools and major expressways. With all this to offer, we're sure you'll agree that Pinewood is indeed the ideal place to put down some roots.

Pinewood
AT PHEASANT RUN

Visit the Pinewood Sales Center for more information on this exceptional community or please call 313-455-1577. Pinewood is located at the southeast corner of Glengarry Blvd and Beck Rd. Priced from the \$230,000's.

ROBERTSON BROTHERS GROUP **Rb**



UNIQUE SINGLE FAMILY HOMES...

Westhaven Estates

Ranches & Bungalow homes with the best in location, style & price.

Only minutes from Westland Mall.

Features include:

- First Floor Master Suite
- Breakfast Nook
- Two-Car Attached Garage
- First Floor Laundry
- Alcove Dining
- Full Basement

FOR INFORMATION CALL
810-642-7800

From: \$134,400

The Chawney Group, Inc.
DEVELOPERS • BUILDERS • REALTORS • DESIGNERS

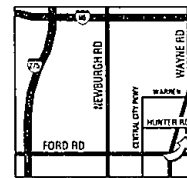

Looking to buy or rent?
Come Home to Southfield.



Central location, a variety of housing choices, excellent public and private schools, award-winning parks & recreation programs.

Free services include:

- Community information
- Mortgage options
- Rental information

Southfield Housing Service
(810) 354-4968

