

# Power takes homeowner into the 21st century

Electricity. It accounts for almost four out of every 10 new patents. It boosts our economy more than any other single commodity. During the next five years, new electric appliances will give home owners greater choices than ever for comfort, convenience, safety and environmental protection, according to the Edison Electric Institute and the National Rural Electric Cooperative Association, representing America's electric utilities.

Let's take a look at just a few of the innovative, electric appliances that are becoming available:

## Horizontal Axis Washer

This washer cleans clothes by tumbling them, just like your dryer. But the tumbling is on its side. This way, the machine can clean with up to 66 percent less water. Since less water is needed, less energy is needed to heat it. It also uses about one fourth of the detergent that a standard washer needs. And, it's faster spin speeds mean less drying time.

## Microwave Clothes Dryer

The speed of microwave cooking comes to your laundry room. The microwave targets just the water molecules within the fabric, removing moisture faster, more gently, and at a cooler temperature—lessening the chance of shrinkage.

## Induction Cooktop

The 21st century way to cook. It uses up to 65% less energy than other cooktops, and offers precise control. It enables the pan to become the heat source, not the cooktop. It's safer, too, with instant on and off features. Save money on energy, and enjoy a cooler kitchen.

## Electric Fireplace

Do what the builder didn't install this fireplace virtually anywhere in your house. It pro-

vides cozy warmth without a chimney or vent. And, it's non-polluting.

## Super Efficient (SEER) Refrigerator

Whirlpool's new refrigerator uses up to half the energy of today's models. A computer chip tells it when to defrost. And, it's environmentally friendly. You'll save on your electric bill, while helping the environment.

## Cordless, Electric Riding Mower

Now you can have all the benefits of a cordless, electric lawn mower in a ride-on unit. Its batteries provide enough power to run the vehicle for about two hours on a full charge. A full charge uses about \$1 worth of electricity, depending on your electricity rates.

## Electric Barbecue Grill

These smokeless grills use no more energy than a hair dryer. They're insulated for energy efficiency and heat retention, sealing in flavor and moisture for terrific taste. And, they emit fewer air pollutants.

## Home Automation System

Program one system to fit your lifestyle, and save on energy costs. Controls heating and cooling temperature settings, lights, appliances and other areas.

## Switchable Privacy Glass

Get instant privacy at the flick of a switch. No drapes, no shades. Diffuses harsh, direct sunlight with limitless design possibilities. And, it eliminates about 99 percent of the UV rays that fade carpeting and furniture.

## Electric vehicles

You'll charge your electric car in your garage overnight. You'll drive at least 5 miles on one charge, and power up at a recharging station. You'll enjoy little routine maintenance — and the environment will enjoy zero emissions. For more information, call your electric utility's residential marketing department.

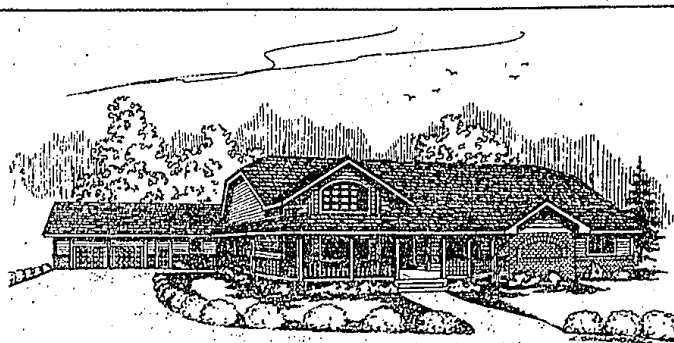

OVERALL DIMENSIONS: 116'-0" X 58'-0"  
LIVING: 3182 square foot  
GARAGE: 760 square foot

VARDELL (402-60)  
By Landmark Designs, Inc.

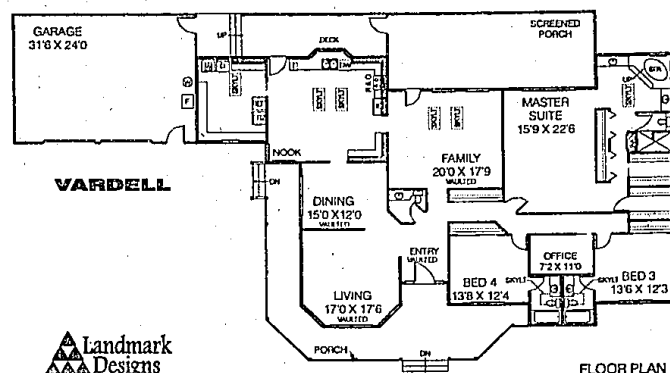

Landmark  
Designs

## This house is for a growing family

For a study hit of the VardeLL (402-60), send \$10. to Landmark Designs, P.O. BOX 2307-0E48, Eugene, OR 97402 (Be sure to specify plan name & number) For a collection of plan books featuring our most popular home plans, send \$20 to Landmark.

The country style VardeLL is a 3,182-square-foot house built for a growing family that requires lots of living space. The two-car garage is placed at the rear of the property, allowing the beauty of the VardeLL to shine through. A wrap-around porch, covered and raised, accents the attractive wood and brick exterior.

Directly inside the vaulted entry are a closet and a half-bath for the convenience of your guests. To the right of the entry are two good-sized bedrooms. Each is fitted with a skylit

private bathroom, and closet space is ample. Separating the two bedrooms is a small home office. There is room here for a personal computer to maintain household accounts and serve school-age children working on class assignments.

Across the hall, maintaining privacy but still near enough to check on the young ones, is the luxurious master suite. In addition to the huge sleeping area, there is a long standard closet and two walk-ins. Other amenities include linen storage and a private skylit bathroom, with twin basins and a raised spa for soothing relaxation after a long day.

The vaulted family room, with double skylights, opens onto a large screened porch. Summer time will find the whole gang out here with a pitcher of lemonade, enjoying the

coolness of the evening. An adjacent deck is a good spot to set up the barbecue and grill some hamburgers.

The spacious skylit kitchen will be a favorite with the cook in the house. Meals may be prepared and easily served at the corner breakfast nook or in the adjoining dining room. There is also a nice garden window and door to the deck.

Conveniently placed next to the kitchen is a generous utility room. Besides the washer and dryer, there is a freezer and extra refrigerator. A skylight brightens the entire area.

At the front of the VardeLL, and affording an excellent view, is the vaulted living room. This is the ideal spot for catching up on your reading or just taking a few quiet moments for yourself.

**FARMINGTON HILLS**  
**TREED LOTS AVAILABLE**

WALK TO TOWN  
• 2-4 Bedrooms  
• Full Basement  
• Attached 2 car garage  
• First floor laundry

From \$162,000  
(810) 618-4113  
Open Daily 12-5 • Closed Thursday  
S. of Grand River, E. of Drake

Another Fine Community by TRIANGLE DEVELOPMENT, INC.

**GRAND OPENING**  
**NEW MODEL**  
**IN FABULOUS**  
**FRANKLIN VILLAGE**  
**BIRMINGHAM SCHOOLS!**

Over 3,300 Sq. Ft., from \$299,900  
On beautiful wooded lots.

**COUNTRYSIDE LIVING, INC.**  
At 13 Mile Rd., 1/2 mile west of  
Telegraph, on Bruce Lane.  
Open 12 to 5:30, except Thurs. & Fri.  
Call LOUIS (810) 539-4668

**FARMINGTON HILLS**  
**GRAND OPENING**  
**SAVE UP TO**  
**\$5000**  
**DURING OUR**  
**SNEAK PREVIEW OF PHASE II**

3-6 bedrooms  
A side-saddle community  
Drake Rd. N. of Grand River  
Full basement  
IMMEDIATE OCCUPANCY

from \$165,900  
(810) 479-6888

**Beautiful**  
**West**  
**Bloomfield**  
**Location!**

**LUXURY SINGLE**  
**FAMILY DETACHED**  
**CONDOMINIUM COMMUNITY**

• 22 BEAUTIFUL SITES  
• ROCK EXTERIOR  
• 1ST FLOOR LAUNDRY  
• FULL BASEMENT  
• PRIVATE GATED ENTRY  
• SPEC HOMES NOW AVAILABLE FROM SEPTEMBER MONTH-ON

• INTRODUCING A SPECTACULAR FLOOR PLAN  
• LANDSCAPING & SPONSORSHIP SYSTEMS INCLUDED  
• REPLACEMENT  
• CITY WATER & SEWER  
• WEST BLOOMFIELD SCHOOLS

**Priced From \$209,900**

**MODEL OPEN**  
Daily & Weekends  
1-5 p.m.  
Call Adri Zachar  
(810) 681-1900  
Voice Mail (810) 490-4383

**Sales by... REAL ESTATE ONE**

**LOOK WHAT'S**  
**AROUND THE**  
**CORNER!**

**Our 2 Bedroom & 1-1/2 Bath**  
**Condominium features:**

- Built in 1994
- Full Basement
- Mini-Blink
- Central Air
- Ceramic Tile
- Garage
- Washer/Dryer
- Pully equipped Kitchen with refrigerator, range, hood, dishwasher and disposal
- Private Wood Deck
- Carport

**FROM \$89,900** **ONE LEFT!**

**BIRMINGHAM**  
**CORNER**

**CONDOMINIUMS**  
123 Coolidge  
Open Sundays  
1-4 p.m.  
or call for Appointment  
1-6 p.m.  
(Closed Thursday)

**(810) 645-2520**  
ANOTHER MICHIGAN CONDOMINIUM COMMUNITY  
(810) 775-5757

**PARK RIDGE**

**BROOKSTONE**  
**VILLAGE**

**MAGNIFICENT**  
**COMMUNITIES**  
**PRESENTED**  
**To You By**  
**ACOHEN**  
**ASSOCIATES, INC.**

**Hillsborough**  
*Less Like Woods*

**PARK RIDGE**  
Luxurious family homes, heavily wooded horsetracks, protected nature areas, and riding arenas for workouts. Spec homes available.  
From the 270,000's  
810-663-1070  
Built in conjunction with The Selective Group

**Hillsborough**  
Hurry! Only a few homes remain in the first phase of Wilson's fastest selling community. Quick occupancy in a tranquil country setting.  
From the \$180,000's  
810-660-0770

**West Bloomfield**  
Wilson's most picturesque wooded neighborhood with all sports like privileges.  
From the \$200,000's  
810-660-0770

**ACOHEN ASSOCIATES, INC.**

**NOVI**  
A village atmosphere, winding sidewalks and a great location with exemplary local schools.  
Models now open. From the \$270,000's  
810-647-7888  
Built in conjunction with Creative Builders

**Northville**  
Pre-construction energy and Northville's acclaimed schools. Minutes from Laurel Park Plaza. Hurry for the best horizontal.  
From the \$230,000's. Prices increase soon.  
313-420-1145