

Even before you get out of the car it speaks to you. Inside, an inviting warmth draws you from room to room. You can picture your family here. Homework spread out on the kitchen table. The soft flicker of light from the hearth. Laughter drifts down the stairs, a mixture of déjà vu and intuition. Then you just know, it's the home you've been waiting for. Or has it been waiting for you?

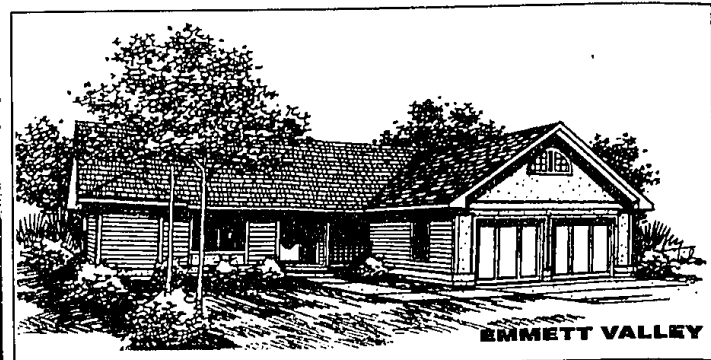

Sometimes you just know.

COHEN REALTY INC.



EMMETT VALLEY

Small but roomy: This compact house is designed to be an informal house but with a spacious feeling, especially the expansive great room. Please see plan below.

Compact house feels spacious

The Emmett Valley is a compact, informal home with an open spacious feeling. Designed to meet the needs of a single person, or a couple with no children, this single level plan could also be adapted to accommodate a wheelchair.

Most of the exterior is lap siding with stucco relief trim. A small porch bounded by a wooden railing adds curb appeal. Inside, these slender windows, along with the oval window in the door, brighten the entry. A double-wide closet is around the corner to the right.

Straight ahead is the comfortable great room - a large bright kitchen. Three wide windows fill most of the back wall and more light spills down from above through four rectangular

skylights. A sliding glass door opens onto the large railed deck that is also accessible from the master suite.

In the great room, a hearth of brick and tile transects one corner, creating a warm focal point. The large, open kitchen fills the other corner. A raised eating bar is all that separates the dining area from the kitchen.

Friends and neighbors will enjoy lingering here to chat while the owners deal with food preparation and cleanup. The dishwasher is raised to minimize bending. Counter space is ample, and a large walk-in pantry augments the available storage capacity.

Utilities are just a few steps away in a pass through utility room, complete with cabinets and a counter for

folding clothes. The garage, too, has built-in cabinets and a long L-shaped workbench.

The isolated master suite provides complete privacy in an attractive atmosphere. Amenities include a walk-in closet, twin basins, separately enclosed shower and toilet.

The guest room and office are at the other end of the house. The guest bedroom has a set of built-in bookshelves. The office can also be used for guests.

For a study kit of the Emmett Valley (404-46), send \$10 to Landmark Designs, P.O. Box 2307-0E48, Eugene, OR 97402. (Be sure to specify plan name and number). For a collection plan books featuring our most popu-

NOVA

A village atmosphere, winding sidewalks and a great location with exemplary Nova schools. Beautifully decorated models now open - several homes currently under construction for quick occupancy.

From the \$270,000's
810-347-7855

Built in conjunction with Creative Builders

NOVA



RODSTONE

Pre construction savings and Northville's acclaimed schools. Minutes from Laurel Park Place Models under construction. Hurry for the best homesites!

From the \$290,000's
313-420-1145

RODSTONE



PARK RIDGE

Luxurious family homes heavily wooded homesites, protected nature areas, and rolling terrain for workouts. Spec homes available.

From the \$270,000's
810-669-1070

Built in conjunction with The Selective Group

PARK RIDGE



WOODSIDE SWANSON

A picturesque wooded neighborhood with all sports lake privileges. New model plans now available.

From the Low \$300,000's
810-960-0770

WOODSIDE SWANSON



Hillsborough

Hurry! Only a few homesites remain in the final phase of this hot selling community. Quick occupancy in a tranquil country setting.

From the \$190,000's
810-960-0770

HILLSBOROUGH

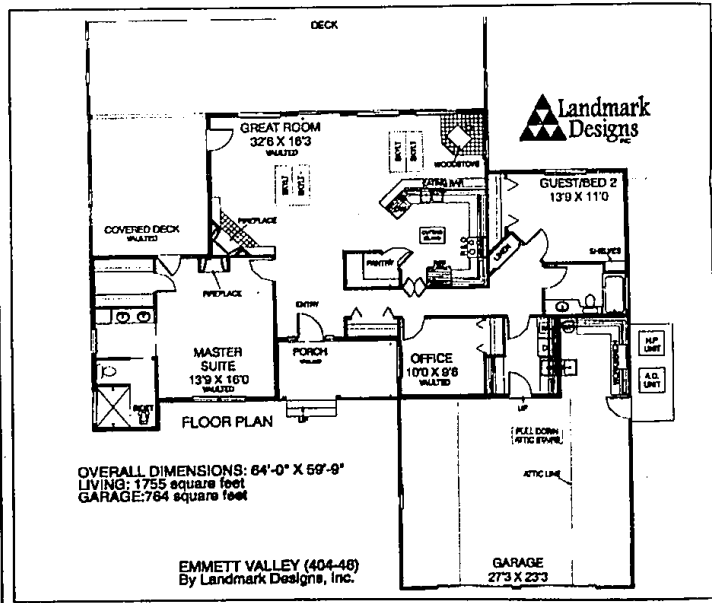

AN INDUSTRY FIRST... Tri-Mount

MANY LOCATIONS... ONE PROMISE... BEST PRICE AND QUALITY!

Fine COMMUNITIES Offered by Tri-Mount

ANN ARBOR

From **\$196,900**

Dhu Varnon

Wonderful New Colonial • Beautiful Curved Staircase Colonial • Spectacular Cape Cod • Walkouts And Daylights Available

RALPH BOLHOUSE
313-865-1885

Located on the South side of Dhu Varnon Road between Nelson and Forling Trail. Dhu Varnon Road to be paved Spring '96.

ANN ARBOR SCHOOLS

Ashford Village From the '140's

EXCEPTIONAL VALUES!

STANDARD FEATURES: Brick & Vinyl Exterior, Insulated Windows & Screens, Whirlpool Dishwasher, Oak Cabinets, 1st Floor Laundry, Fireplace, Full Basement

NEW FEATURES: Large Lots, Paved Asphalt Streets, Car Water & Sewer, Sidewalks, Private Park Area, Walking Distance To Golf Course

DOLLY FISHER
313-434-0981

Located off of Texella Road, East of Carpenter Rd.

PLYMOUTH

Plymouth Commons II From \$292,900

THREE QUARTER ACRE LUXURY LOTS W/ WONDROUS COLORPAINT & SPACIOUS GARAGE COO!

Walkouts & Daylights Available • Spec Homes Available From \$299,900 Total

VALINDA TURNER
313-455-1073

Located on the west side of Ridge Road South of North Territorial north of Powell.

MILFORD

Huron Meadows "Selling Quickly" From \$168,990

A PERFECT LOCATION

27 Sites Walkouts Available • Full basements • Brick & Vinyl Exterior • Near Camp Desborn & Kensington Park

PAUL BROWNE
810-685-0908

Located on the west side of Milford Road, Four miles north of I-96 south of GM Road.

MILFORD

Milford Place From \$102,900

WHAT A WONDERFUL PLACE TO LIVE IMMEDIATE MOVE IN AVAILABLE

2 Bedrooms • 2 Baths • Garage • Basements • Central Air • Decks • Private Entrances • Whirlpool Appliances

SHIRLEY PLSKA
810-684-2281

Located on the east side of Milford Road, four miles north of I-96 south of GM Road. Not included in the warranty offer.