

Lakewood's design adapts to your lifestyle

The covered porch with a waist high railing leads to the entry of the 2608-square-foot Lakewood. This house is versatile and adaptable to a variety of lifestyles and family sizes.

The vaulted living room and dining room are the sunniest rooms of this home. Wide multipaned windows span most of the rear-facing wall, allowing full appreciation of a vista of landscaped yard.

The entryway also has a lofty vaulted ceiling, brightened by two skylights. Windows rim the right wall of a combination family

room/kitchen, expanded by a bayed eating nook. The kitchen work area is designed to minimize steps, with a deep sink, refrigerator, range and oven placed close together. Face framing on the walk-in pantry allows direct access to some of the shelves.

Features in the utility room include a storage area, a sink and space for the washer and dryer.

French doors open into the spacious den, that shares a bathroom with the living area. The den can be used as a home office or study area.

The vaulted master suite has a large walk-in closet and security system panel. Luxury amenities in the master bathroom include an oversized garden tub with space for tropical plants in the tub alcove and a basin in the vanity outside the bathroom.

Two additional bedrooms share a third bath, with tub and shower combination. This single-story home could be adapted for wheelchair accessibility.

For a study kit of the Lakewood (404-33), send \$10 to Landmark Designs, P.O. Box 2307-0E48, Eugene, OR 97402. Be sure to specify name and number. For a collection of plan books featuring the most popular home plans, send \$20 to Landmark, or call 1-800-562-1151.

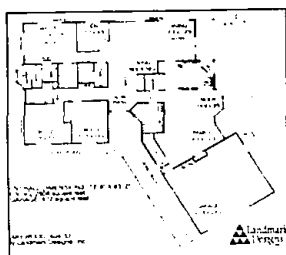
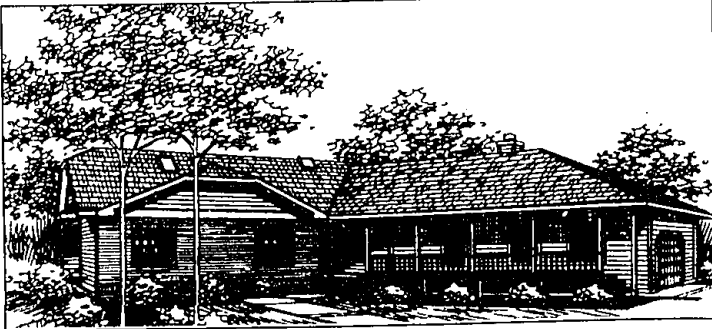

The Lakewood: This versatile home design can be adapted to any size family. It's a practical home with luxurious amenities. See design left.

Put Your Life On Course... SURROUND YOURSELF WITH GOLF

The Award-Winning Residential Golf Community

"One of America's Top 75 Upscale Courses" Golf Digest 1996

THE ORCHARDS INVITATIONAL CLOSE OUT SPECIAL!
DON'T MISS OUT! Only 4 lots left! Beautifully designed detached condominiums, combining the privacy of single-family living with maintenance-free condo conveniences. From \$193,900

THE ORCHARDS TOURNAMENT
Magnificent luxury lifestyle homes on rolling, wooded 1.2 acre lots. From \$305,000

THE ORCHARDS WEDGEWOOD COMING SOON!
From \$180,900

Golf Course Sites Available! Call Our Model at (810) 786-6132

COLEMAN & SCHWEITZER REAL ESTATE
ARCADIA REALTY

Visit our models daily from 12 noon to 6 p.m. or by appointment. Conveniently located South of 29 Mile Road, just West of Van Dyke in Washington Township.

AN INDUSTRY FIRST! Now offering a **2 YEAR WARRANTY**

The Most Beautiful and Affordable Homes in Lake Orion

Forest Hills
4 Exciting Plans
Colonial-Ranch-Cape Cod
1634 - 2273 Sq. Ft.

Beautifully Wooded • 4 Nature Preserve Areas
Walkouts & Daylights Available

SILVERBELL OAKS
3 Luxurious Plans
2 Colonials • 1 Cape Cod
2700 - 3100 Sq. Ft.

121 Sites • Beautifully Wooded Area
Golf Course View Available • Walkouts Available

Model (810) 391-3472
OPEN 1-4 P.M. DAILY

Offered by... **Tri-Mount**
"Making dream homes Affordable"

SERENE COUNTRY LIVING
Custom Homes in Milford's Exclusive

HERITAGE HILL

Heritage Hill is the last phase of a luxury custom home community located in the charming Village of Milford. It features 27 wooded half-acre homesites with city water & sewer. Our beautiful floor plans include colonials, cape code and ranches or bring us your plans and we'll build to suit. Located just south of historic downtown Milford, just moments from Kensington Metro Park, I-96 and M-59 and just minutes from Novi, Livonia, Southfield and Farmington.

From the \$250's Quick Occupancy! Cul-de-sac and walkout sites!

(810) 684-3436
Brokers Welcome

Presented by: Greenspan Partners Building Homes Since 1946

OPEN DAILY 1 - 6 (CLOSED THURSDAY)

COHEN & SELECTIVE ASSOCIATES INC.

KNOCKOUT WALKOUTS

Own A 4,000 Square Foot Home In West Bloomfield For A 3,000 Square Foot Price!

Park Ridge's rolling terrain is ideal for walk-out designs providing humongous additional living space you can finish now or in the future. Spacious four-bedroom homes offer a wide choice of floor plans designed for contemporary living. Plus unspoiled woodlands, neighborhood sidewalks, beautiful private parks, children's playground, even our own private pathway to the wonderful elementary school next door. Visit today!

Single-family homes priced from the \$270,000's
Beautiful spec homes available for Summer occupancy
(810) 669-1070

Specialist furnished models open now to 6 p.m. 7 days a week. Home prepared & has been sold. Not to be advertised.

Presented by: Coleman Associates, Inc. & The Selective Group

Located in the prestigious lakes region of Pontiac Trail, west of Halsted.

PARK RIDGE

PRESTWICK VILLAGE GOLF CLUB

SPRING OPEN HOUSE

Saturday, June 8 & Sunday, June 9 (Noon to 6PM) Both Days

Prestwick Village offers an exclusive collection of 1/2 + acre custom homesites in a private club community which encompasses 426 acres of natural rolling terrain, woodlands & picturesque lakes. Amenities include a world class championship golf course, pool & tennis center, magnificent clubhouse, unparalleled golf practice facilities, cross country skiing & more.

Spring Open House:

- * Tours of exciting new custom built homes.
- * Community & Golf Course Tours.

Stop by and see why Prestwick Village is becoming Metropolitan Detroit's premiere master planned community.

Custom Homes With A World Class Backyard.
For Information Call: (810)889-1433

On M-59, 1 Mile West of Milford Road.