

# RALPH MANUEL

## ASSOCIATES • REALTORS



**WING LAKE PRIVILEGES.** Wonderful property. Great potential in this 2 bath, 3 bedroom ranch with family room and 2 car attached garage. central air, gas forced air opportunity! \$191,500. 647-7100



**BLOOMFIELD HILLS.** Fabulous detached condo with 3 bedrooms. First floor master, 3 baths, 2 lavs, gourmet island kitchen, finished walk-out lower level includes kitchen, office, exercise room, 2 car garage. \$710,000. 647-7100



**PRICED TO SELL FAST!** Spectacular custom contemporary in an excellent neighborhood. Dramatic 2 story marble foyer, great room with cathedral ceilings, Euro-style kitchen, finished lower level. \$695,000. SHD-608828 851-6900



**CONTEMPORARY TOBOCMANI** Spacious rooms with quality materials, clean lines, 12 ceilings, large gourmet kitchen with granite island, custom master suite and 1st floor in-law suite. Bloomfield schools. \$675,000. WEK-657476 851-6900



**GREAT LOCATION!** This 4 bedroom colonial is situated on a quiet court in desirable subdivision. Family room has full brick wall fireplace, formal living room, nice deck, full basement, central air. \$159,900. 647-7100



**PRESTIGIOUS MARTELL DRIVE** on acre hilltop setting. Gracious foyer boasts grand bridal staircase. Spacious kitchen with large breakfast room. 4 bedrooms, 3 1/2 baths, wet plaster, cove ceilings, hardwood floors. \$789,000. 647-7100



**SPECTACULAR CHAMBORD CONTEMPORARY** sitting on a private lot offering marble foyer, spacious 4 bedrooms, 3 full + 2 half baths, dream kitchen, finished walk-out lower level and more. \$845,000. PAK-650764 851-6900



**THIS LOVELY NEW CONSTRUCTION** 4 bedroom Novi Colonial is waiting for you to move right in. Offers a 2-story foyer, walk-out basement, 3 car garage and backs to a wooded ravine. \$400,000. WOR-613569 851-6900



**THIS WONDERFUL RANCH** is ready for new owners. Great room sizes, full height fireplace in family room, new carpet and paint. Just move in. \$249,900. 647-7100



**BEAUTIFUL COLONIAL** w/open, gracious floor plan. Hardwood floors flow thru 2-story foyer, powder room, kitchen & family room. Separate library, gourmet kitchen, 4 bedrooms, luxurious master. Large deck, quiet cul-de-sac. \$419,900. 647-7100



**BUILDER'S OWN DREAM HOME** great for entertaining with over 5000 sq. ft. Garden room, top of the line everything, fabulous master suite plus guest bedroom and bath! Move-in condition. MIN-64 851-6900



**STUNNING TRANSITIONAL** Over 4000 sq. ft. in Maplewoods North. 2 story family room with bridge, white ceramic foyer, open and bright and neutral throughout. Offered at \$369,900. BAC-663851 851-6900



**LATHRUP VILLAGE.** Own this fabulous, authentic English tudor with 6 bedrooms, 3 1/2 baths, family room, 3 fireplaces, 2 car attached garage plus so much more! \$275,000. LAD 647-7100



**SPACIOUS RANCH.** Many updates in this corner home with large family room, kitchen remodeled '96, 2 car attached garage, private deck plus two fireplaces. \$112,000. HUY 647-7100



**ENGLISH TUDOR ESTATE!** Henry Ford crafted this estate with elegance and sophistication in mind. 8 outstanding acres of natural beauty, stable, riding ring, pool and pond. \$559,900 TEN-607350 851-6900



**SPECIAL RANCH!** Fabulous, newly decorated 4 bedroom home boasts neutral hardwood floors PLUS a finished lower level. Full wall of windows and art deco family room. Bloomfield Hills schools. \$318,000. WOD-664864 851-6900



**FRANKLIN** Elegant Tudor in historic Franklin Village. This 5 bedroom, 3 1/2 bath home is situated on a private, beautifully landscaped lot. Gracious two story foyer with circular staircase. \$428,000. MEW 647-7100



**SPACIOUS, UPDATED** brick ranch on beautiful park-like acre lot. Open floor plan, redone kitchen, beautiful wood floors, studio 32x19 above oversized garage, 3 bedrooms, 2 1/2 baths, family room, Florida room, Birmingham schools. \$279,900. 647-7100



**SOUTHFIELD COLONIAL!** Beautiful 3 bedroom home with attached garage and central air. Newly painted and carpeted. Finished lower level, 2 car garage and fireplace in living room. \$115,000. DOT-654887 851-6900



**STUNNING DETACHED CONDO!** Three bedroom Contemporary with fabulous features including white kitchen, hardwood floors, bay window, large master suite and whirlpool tub in main bath. Must see! \$162,500. BET-665088 851-6900



**LAKE FRONT.** Exclusive, private all-sports Walnut Lake front featuring 4 bedrooms, 2 baths, walk-out basement, personal gardens, wooded lot, Birmingham schools. \$415,000. 647-7100



**CUSTOM BUILT** sharp ranch on a quiet, tree-lined cul-de-sac. Fabulous newer Euro-style kitchen, 3-4 bedrooms, pegged hardwood floors in living room & dining room, Terrazzo tile in foyer, sprinkler/fire alarm system, finished basement. Great location. \$277,500. 647-7100



**DREAM STARTER!** Beautifully maintained 3 bedroom brick ranch with aluminum trim, finished basement, 2 car garage and more on a nice lot. Convenient Oak Park location! \$99,900. RIE-663859 851-6900



**NEED SPACE?** This 5 bedroom, 2 1/2 bath Southfield Colonial has the space you need. Over 2000 sq. ft. of living space plus a finished basement. Never carpet in family room and updated kitchen. \$149,900. NAT-66 851-6900



**TWO HOMES & two deeded properties** to be sold as a package. One home with pond view leading to Simpson Lake. Both homes currently rented. Can be split. Total price of \$399,000. 647-7100



**SHARP, CLEAN,** maintenance-free exterior! Updates in this 4 bedroom, 2 1/2 bath home includes freshly painted interior, newer furnace and new air conditioning and new deck. \$264,900. 647-7100



**BREATHTAKING VIEWS!** Super home built with superior quality - 5 bedrooms, 1st floor guest suite, dream master suite and kitchen that opens to family room. Finished lower level, indoor pool and more. \$1,800,000. BRE-664563 851-6900

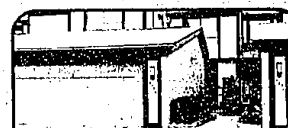

**POTOMAC TOWNE CONDO!** Hard to find 4 bedroom, 2 1/2 bath Townhouse. Overlooks pond, updated kitchen with all new white appliances, West Bloomfield schools and more. Offered at \$144,500. POC-664090 851-6900

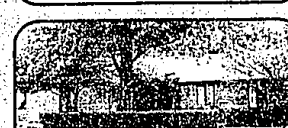

**PINE LAKE BEACH** privileges & dock! 3,564 ft. walk-out ranch in Bloomfield Hills schools. 4 bedrooms, 3 1/2 baths, 1st floor master, marble foyer, cathedral ceiling in living room, 2-level docks to wooded lot. \$429,000. 647-7100

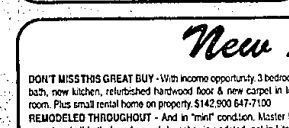

**ROLLING OAKS!** Soft contemporary with many updates, private library

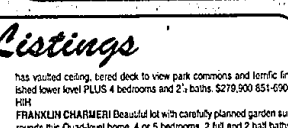

has vaulted ceiling, tiered deck to view park commons and terrific finished lower level PLUS 4 bedrooms and 2 1/2 baths. \$279,900 851-6900 HSH



**TOTALLY UPDATED!** Wonderful Colonial renovated in late 93 from stem to stern. Bright, open and neutral floor plan. Full basement and fenced yard. Southfield location. \$144,900. FOA-656169 851-6900

### New Listings

**DON'T MISS THIS GREAT BUY** - With income opportunity 3 bedrooms, bath, new kitchen, refinished hardwood floors & new carpet in living room. Plus small rental home on property. \$142,900 647-7100

**REMODELED THROUGHOUT** - And in "mint" condition. Master bedroom has half bath, brand new dishwasher in updated, eat-in kitchen, low heat bills with new furnace and insulation. \$133,000 647-7100

**WELL MAINTAINED COLONIAL** offering updated kitchen, formal dining room, family room with fireplace overlooking dock, 1st floor laundry and full basement. Show and sell! \$137,500 851-6900 ROT

has vaulted ceiling, tiered deck to view park commons and terrific finished lower level PLUS 4 bedrooms and 2 1/2 baths. \$279,900 851-6900 HSH

**FRANKLIN CHARMER!** Beautiful lot with carefully planned garden surrounds this Quad-level home. 4 or 5 bedrooms, 2 full and 2 half baths, family room, library, 2 fireplaces and more. \$312,000 851-6900 CHT

**WRY RENTY** When this 1 bedroom, 1 bath freshly decorated Condo could be yours. Neutral tones, mirrored bi-folds and terrific location. \$54,900 851-6900 TWE

647-7100

1821 W. Maple  
Birmingham-Bloomfield

851-6900

32961 Middlebelt  
Farmington Hills-West Bloomfield

