

Polls open Tuesday; AV ballots available

Absentee ballots for the Aug. 4 primary are available at Farmington and Farmington Hills city halls.

Voters can get them at both city clerk offices until 2 p.m. Saturday, Aug. 4, and they must be returned at those offices by 8 p.m. Election Day.

Along with the gubernatorial race, Farmington and Farmington Hills voters will decide a \$11.7 million library millage and two key Oakland County Commission district races.

"Many people obtain absentee ballots because they have plans to be out of town and most of our ballots are returned before a couple of days or more and sometimes a couple of weeks before an election," according to Patsy Cantrell, Farmington clerk/treasurer.

During the last gubernatorial primary there were 624 absent ballots with a total of 30 percent voter turnout. As of Tuesday there were 562 absentee applications requested.

"Based on that we would

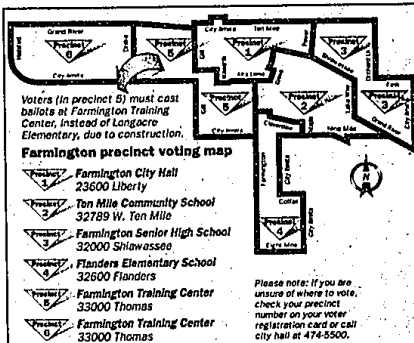

Voters (in precinct 5) must cast ballots at Farmington Training Center, instead of Longfellow Elementary, due to construction.

Farmington precinct voting map

- Farmington City Hall 23600 Liberty
- Ten Mile Community School 32789 W. Ten Mile
- Farmington Senior High School 32000 Shilawasse
- Flanders Elementary School 32600 Flanders
- Farmington Training Center 33000 Thomas
- Farmington Training Center 33000 Thomas

Please note: If you are unsure of where to vote, check your precinct number on your voter registration card or call city hall at 474-8500.

expect a 30 percent or higher turnout," Cantrell said.

Kathy Dornan, Farmington Hills city clerk, noted that the earlier the clerk's office receives the absentee ballots, the easier it is for election workers to process the application, which includes a lot of steps.

As of Tuesday afternoon, some 6,800 Farmington Hills voters requested absentee ballots, which is an average request, she said, for a primary involving a governor's race.

"I was hoping the library issue would generate some interest,"

Dornan said noting that primary elections traditionally have a low voter turnout.

"I'm guessing there will be between an 18 and 20 percent turnout," she said. "I wish everyone would vote. We build up for weeks getting ready for elections and it's the same no matter how many people vote. It would be nice if it were the American way that more people exercised their right and voted and I don't know how to encourage that, but I try."

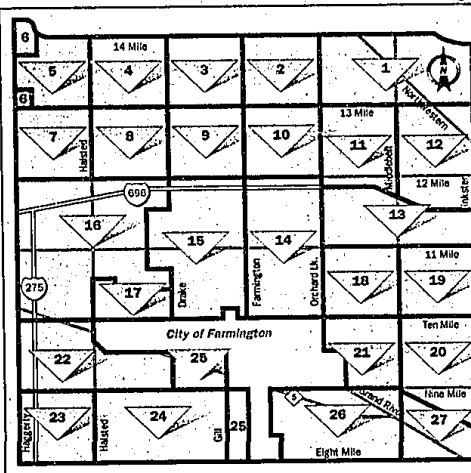

City of Farmington Hills PRECINCT VOTING MAP

- 1. Fairview School + 28520 Oak Crest
- 2. N. Farmington High School + 32920 Thomson Mar
- 3. Forest Elementary School + 34545 Oak Center
- 4. First Covenant Church + 25145 Fairview Mar
- 5. Grace Church + 25245 Forest Mar
- 6. N. Congregational Church + 36520 Ten Mile (shown at top left)
- 7. Hope Lutheran Church + 32020 W. Ten Mile
- 8. First Station #1 + 28711 Drake
- 9. Church of the Nazarene + 32800 Ten Mile Mar
- 10. Kettering Elementary School + 32530 Harvey Mar
- 11. Holy Trinity Catholic Church + 30115 Impression
- 12. Woodview Elementary School + 28420 Harvest
- 13. Farm Hills Activity Center + 36020 Elm Mar
- 14. Alameda School + 32400 Alameda
- 15. First Presbyterian Church + 36165 Farmington
- 16. Kettering Elementary School + 36021 Elm Mar
- 17. Grace Church + 27198 Harvest
- 18. East Middle School + 32000 Lakeside
- 19. East Middle School + 32000 Lakeside
- 20. East Middle School + 32000 Lakeside
- 21. East Middle School + 32000 Lakeside
- 22. East Middle School + 32000 Lakeside
- 23. East Middle School + 32000 Lakeside
- 24. East Middle School + 32000 Lakeside
- 25. East Middle School + 32000 Lakeside
- 26. St. Paul's Lutheran Church + 28025 Midpoint
- 27. St. Alexander's Church + 27835 Streamside

Ta Dah!

New HENRY FORD HOSPITAL CAMPUS

Introducing the new Henry Ford Hospital Campus

We've transformed health care right before your eyes. Presenting the new Henry Ford Hospital Campus.

Now, with an additional 185,000-square-foot, four-story facility. We've even improved the way patients are cared for, with new technology to help you get better, faster. We've added more parking, making it easier and safer to find your way. Plus, we have new Kidney Failure and Bone Marrow Transplant facilities, and a "brand-spanking-new" mom and baby unit. The new Henry Ford Hospital Campus is going to change the way you experience health care. For more information call 1-888-Henry Ford.



Expect more from Henry Ford Hospital.

www.henryfordhealth.org

Shanty Creek Golf
SPECIAL
\$59 per person, based on double occupancy.
INCLUDES guest room and one round on The Summit Golf Club with shared cart.
Call for Details:
1-800-678-4111
Shanty Creek
Briarcliff, Michigan 48115
www.shantycreekgolf.com info@shantycreekgolf.com

D&N Advantage CD
6.01%^{APY}
11-MONTH ADVANTAGE CD
Earn higher interest with D&N's Advantage CD when you open and maintain a D&N checking account with an \$100 minimum opening balance. 11-Month Certificate of Deposit requires a deposit of \$5,000 or more. Annual Percentage Yield as of 7/14/98. Substantial penalty for early withdrawal. Personal accounts only.
Call or visit D&N Bank today! **1-800-236-9252**
D&N BANK
Auburn Hills • Brighton • Canton • Clawson • Fowlerville • Hartland
Holland • Pontiac • Romeo • South Lyon • St. Clair Shores • Troy
Internet <http://www.dn.bank>
© 1998 D&N Bank

PUBLIC ADVISORY COMMITTEE ON JUDICIAL CANDIDATES
An Independent Committee of the Oakland County Bar Association

JUDICIAL CANDIDATE RATINGS

- **COURT OF APPEALS - 2nd DISTRICT**
Martin M. Doctoroff - OUTSTANDING
Pamela Gilbert O'Sullivan - QUALIFIED
- **SIXTH JUDICIAL CIRCUIT COURT - NON-INCUMBENT POSITION**
Steven M. Kaplan - OUTSTANDING
Richard D. Kuhn, Jr. - NOT RECOMMENDED - INSUFFICIENT EXPERIENCE
Colleen A. O'Brien - OUTSTANDING
- **43rd DISTRICT COURT - Ferndale, Madison Heights and Hazel Park**
Joseph Longo - OUTSTANDING
Stephen M. Taratuta - NOT RECOMMENDED - INSUFFICIENT EXPERIENCE
W. Ann Warner - NOT RECOMMENDED
Kimberly S. Wilson - QUALIFIED, BUT NOT RECOMMENDED
- **60th DISTRICT COURT - Pontiac**
Michael C. Martinez - WELL QUALIFIED
Joan Marsh Simmons - NOT RECOMMENDED
Preston G. Thomas - WELL QUALIFIED
- **52nd DISTRICT COURT - Novi, South Lyon, Walled Lake and Wixom**
Michael Batchik - OUTSTANDING
John W. Knight - QUALIFIED

RATINGS

The following criteria were used to evaluate each candidate's qualifications:

1. Full participation in the Committee process, completing the questionnaire in full, signing the waiver form, authorizing the release of medical, Attorney Grievance and Judicial Tenure records, appearing for the interview and submitting all other requested materials;
2. Legal ability, including scholarship, writing and speaking skills;
3. Experience, taking into account the length of time the candidate has been an attorney/judge and the nature of his or her practice/docket;
4. Reputation for wisdom, intellect, insight and impartiality and conduct as a lawyer/judge and as a member of the community;
5. Demeanor and temperament;
6. Health, both physical and mental;
7. The manner in which the candidate conducts his or her campaign; and
8. Other factors that are relevant to the particular office that the candidate is seeking;

Participation in civic, charitable, religious or political activities, bar associations or other professional organizations may also be considered.

WHAT THE RATINGS MEAN

1. **OUTSTANDING.** This rating signifies that the candidate satisfied the criteria set forth above in the highest degree.
2. **WELL QUALIFIED.** This rating signifies that the candidate satisfied the criteria set forth above in a substantial degree.
3. **QUALIFIED.** This rating signifies that the candidate satisfied the criteria set forth above.
4. **NOT RECOMMENDED - INSUFFICIENT EXPERIENCE.** This rating signifies that the candidate satisfies some of the criteria set forth above, but in the judgment of the Committee, has not had sufficient experience to be recommended for judicial office. This rating only indicates that the candidate is not recommended for the judicial office that he or she presently seeks. The rating should in no way be construed as an adverse reflection on the candidate's qualifications as an attorney or for any position that he or she might presently hold, unless the candidate is running as an incumbent, or may seek in the future.
5. **QUALIFIED, BUT NOT RECOMMENDED.** This rating signifies that the candidate satisfies 1, 2, and 3 of the above criteria, but in the judgment of the Committee, based upon the remaining criteria, cannot be recommended. This rating indicates that the candidate is not recommended for the judicial office that he or she presently seeks. The rating should in no way be construed as an adverse reflection on the candidate's qualifications as an attorney or for any position that he or she might presently hold, unless the candidate is running as an incumbent, or may seek in the future.
6. **NOT RECOMMENDED.** This rating signifies that the candidate does not sufficiently satisfy the above criteria. This rating indicates that the candidate is not recommended for the judicial office that he or she presently seeks. The rating should in no way be construed as an adverse reflection on the candidate's qualifications as an attorney or for any position that he or she might presently hold, unless the candidate is running as an incumbent, or may seek in the future.

If a candidate did not timely complete the questionnaire in full, sign the waiver form, authorize the release of medical, Attorney Grievance and Judicial Tenure records and appear for the interview, the candidate was rated "Not Recommended."

ALL RATINGS REFLECT THE COMMITTEE'S CONSIDERED OPINION AS TO THE CANDIDATE'S QUALIFICATIONS FOR THE JUDICIAL OFFICE SOUGHT AT THE TIME OF THIS EVALUATION ONLY. IT DOES NOT CONSTITUTE THE COMMITTEE'S OPINION AS TO THE CANDIDATE'S SUITABILITY (1) FOR ANY OFFICE PRESENTLY HELD, UNLESS THE CANDIDATE IS RUNNING AS AN INCUMBENT, (2) FOR ANY OFFICE AT ANY OTHER TIME, (3) AS AN ATTORNEY, OR (4) FOR ANY OTHER ENDEAVOR.