

Implement and Machine Shed

By H. H. MUSSELMAN, Instructor in Farm Mechanics, Michigan Agricultural College

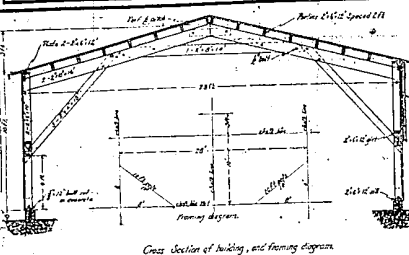

Cross section of building, and framing diagram.

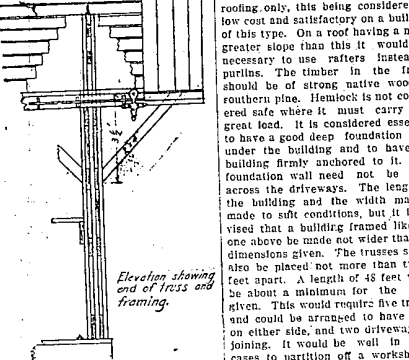

Elevation showing of roof and framing.

An implement and machine shed, a truss, and details of which are shown in the accompanying drawings, is designed with three things in mind: viz., suitability to the purpose for which it is to be used, ease of construction, and low cost.

At the outset it is assumed that a clear spanned building unobstructed by posts and beams would be especially desirable for the purpose in view. Many of the machines and implements to be stored in the building are of considerable weight, and a great deal of space and can be stored most economically by crowding together those likely to be in use at the same time. This can be done with very little loss of space, which allows them to be stored in any direction to the best advantage. Another thing to be considered in this connection is the dimensions of doors and openings. It is not considered advisable to make the doors less than twelve feet wide and ten high. Perhaps the ideal construction would be doors arranged to be continuous or so that they might be opened at any convenient point, and in taking out machinery the pieces used are framed in such a way that little extra work or careful fitting is required to obtain a reasonably tight joint. The trusses can be built good job. The trusses can be built out and assembled on the ground and are not so heavy but, that they can be erected by four or five men without difficulty. The weight per truss ready to erect will be from 600 to 1,200 pounds. The trusses being set up and braced temporarily, the plates, braces, and girts are easily put up and spiked in place. To make the trusses align properly, it is essential that all the trusses be made after the same pattern; and to do this the following method is suggested, for which the framing diagram accompanying the truss is intended. First, a level spot, say a barn floor, or plot of ground which can be carefully leveled off, and planks laid down and held in place by stakes driven in the ground. Then procure a ten-foot pole, chalk and line. Strike black No. 1 line in the diagram at the center, and then the width of the truss. Through points on this line the same distance apart as the width of the truss strike lines at right angles to line No. 1, measuring by means of the ten-foot pole, using the lengths 6, 8, and 10 feet as shown in the diagram. Strike another line parallel to No. 1 at a distance equal to the height of the post (including the sill and plate) from No. 1. A fifth line is then struck in the center at right angles to No. 1, upon which is marked at the proper point the peak of the truss. The diagram having been completed by the lines with their other edges touching the lines. The pieces upon which the trusses are laid may then be placed on the diagram and the proper bevels scribbled off. Care should be taken to scribble to allow for placing the plating so that the roof boards will strike both the girts and the edge of the plate. Complete the truss and then the others from the same diagram. The members should be bolted together, as shown in the cut, and all other joints nailed or spiked. If the truss is to be a full truss, it is bolted to a good deep foundation wall by means of bolts set in the concrete when placing the same for the foundation. The truss is shown in the center piece extending between the two chord members of the truss and the ends of the remaining two spiked between the plates making up the post.

The building is designed with a very

PERSIANS PREPARE TO RESIST RUSSIA

ARE FRENZIED AT SLAUGHTER OF WOMEN AND CHILDREN AT TABRIZ.

WHITE FLAG IS NO SHIELD TO PERSIANS.

Slaves Continue Invasion After Little Nation Has Yielded to Demands Made on Her by Russia.

Despite the fact that the government of little Persia is surrounded by Russia to the east, and by the sea to the west, the Persian people are not only overawed by the power of the Russian empire, but are being massacred there, according to reports received.

A telegram from the vice-governor of Tabriz gives an appalling picture of the situation in that city as a result of Russian aggression. The text reads: "Before God, the innocent women and children are being butchered in cold blood."

The vice-governor estimates the number of Persians killed in Tabriz as 500, and adds: "The Russians ignore our overtures for the cessation of hostilities."

The recent, Nayir Ali Mulk, acting in agreement with the cabinet, declared the national council dissolved. The war minister sent troops to prevent the deputies from entering the parliament building.

Russians Continue Slaughter. After a 24-hour slaughter in Resht, capital of the Persian province of Gilan, in which approximately 1,200 Persian men, women and children were slain by Russian Cossacks, the soldiers continued their bloody work by sending detachments of troops to sheet down the refugees who were fleeing from the city.

Inside Resht the cry of blood still went on. Details of the massacre were received by a courier who traveled the 120 miles of country between Resht and the capital by horseback. The messenger brought a plea for aid from the governor of Gilan, who declared that the Russian soldiers were slaughtering men, women and children in Amul, Masula and Arbil as well as in Resht.

GENERAL REYES SURRENDERS Mexican Leader, Completely Discouraged, Gives Up Revolt.

Defeated and stripped of former armaments and aid, Gen. Bernardo Reyes, Mexico's sometime greatest military leader and more recently leader of the revolt that threatened to tear the country from border to border, surrendered at Linares, but later received his liberty on his word that he would not leave the city.

He surrendered officially to Gen. Trevino, a personal enemy of years. The surrender of Gen. Bernardo Reyes at Linares, Nuevo Leon, it is believed, marks the end of the most serious revolt yet endangering the Madero government. Scarcely all over the country recently have sprung small revolts, and most of them were in the name of the former military leader of the country.

China Republic Near. Premier Yuan Shikai has submitted to the more prominent Japanese and British the proposal of a special national assembly to decide on the future of the country. The assembly should be adopted for China. This is the first time that the government has taken such a national assembly would decide in favor of a republic.

If the Manchus will not adopt the suggestion their decision to do so will be promulgated as an edict.

Pope Can't Stop War. An effort on the part of the papal to enlist the aid of the pope to persuade Italy to enter Turkey that way in the peace proposals which Germany is urging at Constantinople has met with complete failure. In submitting the proposal the German minister at the Vatican stated that the pope's influence the king of Italy. The minister is credited with being greatly astonished when the pope shook his head and refused to co-operate in the scheme.

Yuan Opposes China Republic. The refusal of the Chinese Republic to accept a republican form of government is a categorical reply to a communication made to him from Shanghai by his representative, Sun Yat-sen, after the meeting of the conference between delegates of the imperial government and revolutionary held in Peking.

Negro Chopped to Pieces. King David, a negro who shot and killed Frederick A. Schwarz (white), was shot by a white man in Maryland, was taken from the Brooklyn, Md., jail and killed by a mob. David was chopped to death with hatchets.

The Ann Arbor railroad has ordered five new catalytic motor engines.

Washington Hadley, aged 94, who claimed to be the oldest bank president in active service in the United States, is dead at his home in White Plains, N. Y. He was born in Gilford county, North Carolina, in 1817, and at the time of his death was president of the savings bank.

Fire Marshal James H. Hays and 23 of his men who lost their lives with him in the stockyards fire in Chicago one year ago, were remembered by a service of the Holy Name cathedral and the placing of a tablet to the memory of the victims at the door of the fire marshal's office in the city hall.

LOSING ON TWINE PLANT

Warden Simpson Shows That Plant Is a Losing Proposition.

At the meeting of the board of control of Jackson prison in Lansing, Warden Nathan P. Simpson demonstrated that instead of being a financial success, as has generally been supposed, the binder twine plant of the state penitentiary has in reality been a losing proposition.

The books of the prison show that during the past four years the binder twine plant has paid into the state treasury \$55,000, but the warden says that in a private business enterprise labor would be charged against this account, the depreciation of the property and machinery would be shown, interest on the investment and the cost of power and light would be taken into consideration. However, these things have not been charged against the binder twine plant, and had they been there would have been a loss in the past four years of \$1,200.

By a resolution of the board it was decided to transfer \$1,000, which is now in the revolving fund to the general fund credited to the institution. This fund has accumulated through money saved by legislative appropriations for new buildings and equipment, and will be utilized to pay running expenses of the big institution.

Gov. Osborn expressed himself as being well pleased with the board as constituted at present, claiming that the members are representative business men in whom he is justified in placing the confidence. Warden Simpson appears to have the solid backing of the board in his effort to place Jackson prison on a better basis and the board and the warden appear to be working in the utmost harmony.

Admiral George Dewey, the hero of Manila bay, received the felicitations of President Taft, members of the cabinet, army and navy officials and friends, the occasion being his 74th birthday anniversary. Admiral Dewey is in the best of health.

THE MARKETS

LIVE STOCK. CATTLE.—Market steady. Good beef steers, 10 to 12 lbs. live weight, \$10.00 to \$10.50. Good beef steers, 12 to 14 lbs. live weight, \$10.50 to \$11.00. Good beef steers, 14 to 16 lbs. live weight, \$11.00 to \$11.50. Good beef steers, 16 to 18 lbs. live weight, \$11.50 to \$12.00. Good beef steers, 18 to 20 lbs. live weight, \$12.00 to \$12.50. Good beef steers, 20 to 22 lbs. live weight, \$12.50 to \$13.00. Good beef steers, 22 to 24 lbs. live weight, \$13.00 to \$13.50. Good beef steers, 24 to 26 lbs. live weight, \$13.50 to \$14.00. Good beef steers, 26 to 28 lbs. live weight, \$14.00 to \$14.50. Good beef steers, 28 to 30 lbs. live weight, \$14.50 to \$15.00. Good beef steers, 30 to 32 lbs. live weight, \$15.00 to \$15.50. Good beef steers, 32 to 34 lbs. live weight, \$15.50 to \$16.00. Good beef steers, 34 to 36 lbs. live weight, \$16.00 to \$16.50. Good beef steers, 36 to 38 lbs. live weight, \$16.50 to \$17.00. Good beef steers, 38 to 40 lbs. live weight, \$17.00 to \$17.50. Good beef steers, 40 to 42 lbs. live weight, \$17.50 to \$18.00. Good beef steers, 42 to 44 lbs. live weight, \$18.00 to \$18.50. Good beef steers, 44 to 46 lbs. live weight, \$18.50 to \$19.00. Good beef steers, 46 to 48 lbs. live weight, \$19.00 to \$19.50. Good beef steers, 48 to 50 lbs. live weight, \$19.50 to \$20.00. Good beef steers, 50 to 52 lbs. live weight, \$20.00 to \$20.50. Good beef steers, 52 to 54 lbs. live weight, \$20.50 to \$21.00. Good beef steers, 54 to 56 lbs. live weight, \$21.00 to \$21.50. Good beef steers, 56 to 58 lbs. live weight, \$21.50 to \$22.00. Good beef steers, 58 to 60 lbs. live weight, \$22.00 to \$22.50. Good beef steers, 60 to 62 lbs. live weight, \$22.50 to \$23.00. Good beef steers, 62 to 64 lbs. live weight, \$23.00 to \$23.50. Good beef steers, 64 to 66 lbs. live weight, \$23.50 to \$24.00. Good beef steers, 66 to 68 lbs. live weight, \$24.00 to \$24.50. Good beef steers, 68 to 70 lbs. live weight, \$24.50 to \$25.00. Good beef steers, 70 to 72 lbs. live weight, \$25.00 to \$25.50. Good beef steers, 72 to 74 lbs. live weight, \$25.50 to \$26.00. Good beef steers, 74 to 76 lbs. live weight, \$26.00 to \$26.50. Good beef steers, 76 to 78 lbs. live weight, \$26.50 to \$27.00. Good beef steers, 78 to 80 lbs. live weight, \$27.00 to \$27.50. Good beef steers, 80 to 82 lbs. live weight, \$27.50 to \$28.00. Good beef steers, 82 to 84 lbs. live weight, \$28.00 to \$28.50. Good beef steers, 84 to 86 lbs. live weight, \$28.50 to \$29.00. Good beef steers, 86 to 88 lbs. live weight, \$29.00 to \$29.50. Good beef steers, 88 to 90 lbs. live weight, \$29.50 to \$30.00. Good beef steers, 90 to 92 lbs. live weight, \$30.00 to \$30.50. Good beef steers, 92 to 94 lbs. live weight, \$30.50 to \$31.00. Good beef steers, 94 to 96 lbs. live weight, \$31.00 to \$31.50. Good beef steers, 96 to 98 lbs. live weight, \$31.50 to \$32.00. Good beef steers, 98 to 100 lbs. live weight, \$32.00 to \$32.50. Good beef steers, 100 to 102 lbs. live weight, \$32.50 to \$33.00. Good beef steers, 102 to 104 lbs. live weight, \$33.00 to \$33.50. Good beef steers, 104 to 106 lbs. live weight, \$33.50 to \$34.00. Good beef steers, 106 to 108 lbs. live weight, \$34.00 to \$34.50. Good beef steers, 108 to 110 lbs. live weight, \$34.50 to \$35.00. Good beef steers, 110 to 112 lbs. live weight, \$35.00 to \$35.50. Good beef steers, 112 to 114 lbs. live weight, \$35.50 to \$36.00. Good beef steers, 114 to 116 lbs. live weight, \$36.00 to \$36.50. Good beef steers, 116 to 118 lbs. live weight, \$36.50 to \$37.00. Good beef steers, 118 to 120 lbs. live weight, \$37.00 to \$37.50. Good beef steers, 120 to 122 lbs. live weight, \$37.50 to \$38.00. Good beef steers, 122 to 124 lbs. live weight, \$38.00 to \$38.50. Good beef steers, 124 to 126 lbs. live weight, \$38.50 to \$39.00. Good beef steers, 126 to 128 lbs. live weight, \$39.00 to \$39.50. Good beef steers, 128 to 130 lbs. live weight, \$39.50 to \$40.00. Good beef steers, 130 to 132 lbs. live weight, \$40.00 to \$40.50. Good beef steers, 132 to 134 lbs. live weight, \$40.50 to \$41.00. Good beef steers, 134 to 136 lbs. live weight, \$41.00 to \$41.50. Good beef steers, 136 to 138 lbs. live weight, \$41.50 to \$42.00. Good beef steers, 138 to 140 lbs. live weight, \$42.00 to \$42.50. Good beef steers, 140 to 142 lbs. live weight, \$42.50 to \$43.00. Good beef steers, 142 to 144 lbs. live weight, \$43.00 to \$43.50. Good beef steers, 144 to 146 lbs. live weight, \$43.50 to \$44.00. Good beef steers, 146 to 148 lbs. live weight, \$44.00 to \$44.50. Good beef steers, 148 to 150 lbs. live weight, \$44.50 to \$45.00. Good beef steers, 150 to 152 lbs. live weight, \$45.00 to \$45.50. Good beef steers, 152 to 154 lbs. live weight, \$45.50 to \$46.00. Good beef steers, 154 to 156 lbs. live weight, \$46.00 to \$46.50. Good beef steers, 156 to 158 lbs. live weight, \$46.50 to \$47.00. Good beef steers, 158 to 160 lbs. live weight, \$47.00 to \$47.50. Good beef steers, 160 to 162 lbs. live weight, \$47.50 to \$48.00. Good beef steers, 162 to 164 lbs. live weight, \$48.00 to \$48.50. Good beef steers, 164 to 166 lbs. live weight, \$48.50 to \$49.00. Good beef steers, 166 to 168 lbs. live weight, \$49.00 to \$49.50. Good beef steers, 168 to 170 lbs. live weight, \$49.50 to \$50.00. Good beef steers, 170 to 172 lbs. live weight, \$50.00 to \$50.50. Good beef steers, 172 to 174 lbs. live weight, \$50.50 to \$51.00. Good beef steers, 174 to 176 lbs. live weight, \$51.00 to \$51.50. Good beef steers, 176 to 178 lbs. live weight, \$51.50 to \$52.00. Good beef steers, 178 to 180 lbs. live weight, \$52.00 to \$52.50. Good beef steers, 180 to 182 lbs. live weight, \$52.50 to \$53.00. Good beef steers, 182 to 184 lbs. live weight, \$53.00 to \$53.50. Good beef steers, 184 to 186 lbs. live weight, \$53.50 to \$54.00. Good beef steers, 186 to 188 lbs. live weight, \$54.00 to \$54.50. Good beef steers, 188 to 190 lbs. live weight, \$54.50 to \$55.00. Good beef steers, 190 to 192 lbs. live weight, \$55.00 to \$55.50. Good beef steers, 192 to 194 lbs. live weight, \$55.50 to \$56.00. Good beef steers, 194 to 196 lbs. live weight, \$56.00 to \$56.50. Good beef steers, 196 to 198 lbs. live weight, \$56.50 to \$57.00. Good beef steers, 198 to 200 lbs. live weight, \$57.00 to \$57.50. Good beef steers, 200 to 202 lbs. live weight, \$57.50 to \$58.00. Good beef steers, 202 to 204 lbs. live weight, \$58.00 to \$58.50. Good beef steers, 204 to 206 lbs. live weight, \$58.50 to \$59.00. Good beef steers, 206 to 208 lbs. live weight, \$59.00 to \$59.50. Good beef steers, 208 to 210 lbs. live weight, \$59.50 to \$60.00. Good beef steers, 210 to 212 lbs. live weight, \$60.00 to \$60.50. Good beef steers, 212 to 214 lbs. live weight, \$60.50 to \$61.00. Good beef steers, 214 to 216 lbs. live weight, \$61.00 to \$61.50. Good beef steers, 216 to 218 lbs. live weight, \$61.50 to \$62.00. Good beef steers, 218 to 220 lbs. live weight, \$62.00 to \$62.50. Good beef steers, 220 to 222 lbs. live weight, \$62.50 to \$63.00. Good beef steers, 222 to 224 lbs. live weight, \$63.00 to \$63.50. Good beef steers, 224 to 226 lbs. live weight, \$63.50 to \$64.00. Good beef steers, 226 to 228 lbs. live weight, \$64.00 to \$64.50. Good beef steers, 228 to 230 lbs. live weight, \$64.50 to \$65.00. Good beef steers, 230 to 232 lbs. live weight, \$65.00 to \$65.50. Good beef steers, 232 to 234 lbs. live weight, \$65.50 to \$66.00. Good beef steers, 234 to 236 lbs. live weight, \$66.00 to \$66.50. Good beef steers, 236 to 238 lbs. live weight, \$66.50 to \$67.00. Good beef steers, 238 to 240 lbs. live weight, \$67.00 to \$67.50. Good beef steers, 240 to 242 lbs. live weight, \$67.50 to \$68.00. Good beef steers, 242 to 244 lbs. live weight, \$68.00 to \$68.50. Good beef steers, 244 to 246 lbs. live weight, \$68.50 to \$69.00. Good beef steers, 246 to 248 lbs. live weight, \$69.00 to \$69.50. Good beef steers, 248 to 250 lbs. live weight, \$69.50 to \$70.00. Good beef steers, 250 to 252 lbs. live weight, \$70.00 to \$70.50. Good beef steers, 252 to 254 lbs. live weight, \$70.50 to \$71.00. Good beef steers, 254 to 256 lbs. live weight, \$71.00 to \$71.50. Good beef steers, 256 to 258 lbs. live weight, \$71.50 to \$72.00. Good beef steers, 258 to 260 lbs. live weight, \$72.00 to \$72.50. Good beef steers, 260 to 262 lbs. live weight, \$72.50 to \$73.00. Good beef steers, 262 to 264 lbs. live weight, \$73.00 to \$73.50. Good beef steers, 264 to 266 lbs. live weight, \$73.50 to \$74.00. Good beef steers, 266 to 268 lbs. live weight, \$74.00 to \$74.50. Good beef steers, 268 to 270 lbs. live weight, \$74.50 to \$75.00. Good beef steers, 270 to 272 lbs. live weight, \$75.00 to \$75.50. Good beef steers, 272 to 274 lbs. live weight, \$75.50 to \$76.00. Good beef steers, 274 to 276 lbs. live weight, \$76.00 to \$76.50. Good beef steers, 276 to 278 lbs. live weight, \$76.50 to \$77.00. Good beef steers, 278 to 280 lbs. live weight, \$77.00 to \$77.50. Good beef steers, 280 to 282 lbs. live weight, \$77.50 to \$78.00. Good beef steers, 282 to 284 lbs. live weight, \$78.00 to \$78.50. Good beef steers, 284 to 286 lbs. live weight, \$78.50 to \$79.00. Good beef steers, 286 to 288 lbs. live weight, \$79.00 to \$79.50. Good beef steers, 288 to 290 lbs. live weight, \$79.50 to \$80.00. Good beef steers, 290 to 292 lbs. live weight, \$80.00 to \$80.50. Good beef steers, 292 to 294 lbs. live weight, \$80.50 to \$81.00. Good beef steers, 294 to 296 lbs. live weight, \$81.00 to \$81.50. Good beef steers, 296 to 298 lbs. live weight, \$81.50 to \$82.00. Good beef steers, 298 to 300 lbs. live weight, \$82.00 to \$82.50. Good beef steers, 300 to 302 lbs. live weight, \$82.50 to \$83.00. Good beef steers, 302 to 304 lbs. live weight, \$83.00 to \$83.50. Good beef steers, 304 to 306 lbs. live weight, \$83.50 to \$84.00. Good beef steers, 306 to 308 lbs. live weight, \$84.00 to \$84.50. Good beef steers, 308 to 310 lbs. live weight, \$84.50 to \$85.00. Good beef steers, 310 to 312 lbs. live weight, \$85.00 to \$85.50. Good beef steers, 312 to 314 lbs. live weight, \$85.50 to \$86.00. Good beef steers, 314 to 316 lbs. live weight, \$86.00 to \$86.50. Good beef steers, 316 to 318 lbs. live weight, \$86.50 to \$87.00. Good beef steers, 318 to 320 lbs. live weight, \$87.00 to \$87.50. Good beef steers, 320 to 322 lbs. live weight, \$87.50 to \$88.00. Good beef steers, 322 to 324 lbs. live weight, \$88.00 to \$88.50. Good beef steers, 324 to 326 lbs. live weight, \$88.50 to \$89.00. Good beef steers, 326 to 328 lbs. live weight, \$89.00 to \$89.50. Good beef steers, 328 to 330 lbs. live weight, \$89.50 to \$90.00. Good beef steers, 330 to 332 lbs. live weight, \$90.00 to \$90.50. Good beef steers, 332 to 334 lbs. live weight, \$90.50 to \$91.00. Good beef steers, 334 to 336 lbs. live weight, \$91.00 to \$91.50. Good beef steers, 336 to 338 lbs. live weight, \$91.50 to \$92.00. Good beef steers, 338 to 340 lbs. live weight, \$92.00 to \$92.50. Good beef steers, 340 to 342 lbs. live weight, \$92.50 to \$93.00. Good beef steers, 342 to 344 lbs. live weight, \$93.00 to \$93.50. Good beef steers, 344 to 346 lbs. live weight, \$93.50 to \$94.00. Good beef steers, 346 to 348 lbs. live weight, \$94.00 to \$94.50. Good beef steers, 348 to 350 lbs. live weight, \$94.50 to \$95.00. Good beef steers, 350 to 352 lbs. live weight, \$95.00 to \$95.50. Good beef steers, 352 to 354 lbs. live weight, \$95.50 to \$96.00. Good beef steers, 354 to 356 lbs. live weight, \$96.00 to \$96.50. Good beef steers, 356 to 358 lbs. live weight, \$96.50 to \$97.00. Good beef steers, 358 to 360 lbs. live weight, \$97.00 to \$97.50. Good beef steers, 360 to 362 lbs. live weight, \$97.50 to \$98.00. Good beef steers, 362 to 364 lbs. live weight, \$98.00 to \$98.50. Good beef steers, 364 to 366 lbs. live weight, \$98.50 to \$99.00. Good beef steers, 366 to 368 lbs. live weight, \$99.00 to \$99.50. Good beef steers, 368 to 370 lbs. live weight, \$99.50 to \$100.00. Good beef steers, 370 to 372 lbs. live weight, \$100.00 to \$100.50. Good beef steers, 372 to 374 lbs. live weight, \$100.50 to \$101.00. Good beef steers, 374 to 376 lbs. live weight, \$101.00 to \$101.50. Good beef steers, 376 to 378 lbs. live weight, \$101.50 to \$102.00. Good beef steers, 378 to 380 lbs. live weight, \$102.00 to \$102.50. Good beef steers, 380 to 382 lbs. live weight, \$102.50 to \$103.00. Good beef steers, 382 to 384 lbs. live weight, \$103.00 to \$103.50. Good beef steers, 384 to 386 lbs. live weight, \$103.50 to \$104.00. Good beef steers, 386 to 388 lbs. live weight, \$104.00 to \$104.50. Good beef steers, 388 to 390 lbs. live weight, \$104.50 to \$105.00. Good beef steers, 390 to 392 lbs. live weight, \$105.00 to \$105.50. Good beef steers, 392 to 394 lbs. live weight, \$105.50 to \$106.00. Good beef steers, 394 to 396 lbs. live weight, \$106.00 to \$106.50. Good beef steers, 396 to 398 lbs. live weight, \$106.50 to \$107.00. Good beef steers, 398 to 400 lbs. live weight, \$107.00 to \$107.50. Good beef steers, 400 to 402 lbs. live weight, \$107.50 to \$108.00. Good beef steers, 402 to 404 lbs. live weight, \$108.00 to \$108.50. Good beef steers, 404 to 406 lbs. live weight, \$108.50 to \$109.00. Good beef steers, 406 to 408 lbs. live weight, \$109.00 to \$109.50. Good beef steers, 408 to 410 lbs. live weight, \$109.50 to \$110.00. Good beef steers, 410 to 412 lbs. live weight, \$110.00 to \$110.50. Good beef steers, 412 to 414 lbs. live weight, \$110.50 to \$111.00. Good beef steers, 414 to 416 lbs. live weight, \$111.00 to \$111.50. Good beef steers, 416 to 418 lbs. live weight, \$111.50 to \$112.00. Good beef steers, 418 to 420 lbs. live weight, \$112.00 to \$112.50. Good beef steers, 420 to 422 lbs. live weight, \$112.50 to \$113.00. Good beef steers, 422 to 424 lbs. live weight, \$113.00 to \$113.50. Good beef steers, 424 to 426 lbs. live weight, \$113.50 to \$114.00. Good beef steers, 426 to 428 lbs. live weight, \$114.00 to \$114.50. Good beef steers, 428 to 430 lbs. live weight, \$114.50 to \$115.00. Good beef steers, 430 to 432 lbs. live weight, \$115.00 to \$115.50. Good beef steers, 432 to 434 lbs. live weight, \$115.50 to \$116.00. Good beef steers, 434 to 436 lbs. live weight, \$116.00 to \$116.50. Good beef steers, 436 to 438 lbs. live weight, \$116.50 to \$117.00. Good beef steers, 438 to 440 lbs. live weight, \$117.00 to \$117.50. Good beef steers, 440 to 442 lbs. live weight, \$117.50 to \$118.00. Good beef steers, 442 to 444 lbs. live weight, \$118.00 to \$118.50. Good beef steers, 444 to 446 lbs. live weight, \$118.50 to \$119.00. Good beef steers, 446 to 448 lbs. live weight, \$119.00 to \$119.50. Good beef steers, 448 to 450 lbs. live weight, \$119.50 to \$120.00. Good beef steers, 450 to 452 lbs. live weight, \$120.00 to \$120.50. Good beef steers, 452 to 454 lbs. live weight, \$120.50 to \$121.00. Good beef steers, 454 to 456 lbs. live weight, \$121.00 to \$121.50. Good beef steers, 456 to 458 lbs. live weight, \$121.50 to \$122.00. Good beef steers, 458 to 460 lbs. live weight, \$122.00 to \$122.50. Good beef steers, 460 to 462 lbs. live weight, \$122.50 to \$123.00. Good beef steers, 462 to 464 lbs. live weight, \$123.00 to \$123.50. Good beef steers, 464 to 466 lbs. live weight, \$123.50 to \$124.00. Good beef steers, 466 to 468 lbs. live weight, \$124.00 to \$124.50. Good beef steers, 468 to 470 lbs. live weight, \$124.50 to \$125.00. Good beef steers, 470 to 472 lbs. live weight, \$125.00 to \$125.50. Good beef steers, 472 to 474 lbs. live weight, \$125.50 to \$126.00. Good beef steers, 474 to 476 lbs. live weight, \$126.00 to \$126.50. Good beef steers, 476 to 478 lbs. live weight, \$126.50 to \$127.00. Good beef steers, 478 to 480 lbs. live weight, \$127.00 to \$127.50. Good beef steers, 480 to 482 lbs. live weight, \$127.50 to \$128.00. Good beef steers, 482 to 484 lbs. live weight, \$128.00 to \$128.50. Good beef steers, 484 to 486 lbs. live weight, \$128.50 to \$129.00. Good beef steers, 486 to 488 lbs. live weight, \$129.00 to \$129.50. Good beef steers, 488 to 490 lbs. live weight, \$129.50 to \$130.00. Good beef steers, 490 to 492 lbs. live weight, \$130.00 to \$130.50. Good beef steers, 492 to 494 lbs. live weight, \$130.50 to \$131.00. Good beef steers, 494 to 496 lbs. live weight, \$131.00 to \$131.50. Good beef steers, 496 to 498 lbs. live weight, \$131.50 to \$132.00. Good beef steers, 498 to 500 lbs. live weight, \$132.00 to \$132.50. Good beef steers, 500 to 502 lbs. live weight, \$132.50 to \$133.00. Good beef steers, 502 to 504 lbs. live weight, \$133.00 to \$133.50. Good beef steers, 504 to 506 lbs. live weight, \$133.50 to \$134.00. Good beef steers, 506 to 508 lbs. live weight, \$134.00 to \$134.50. Good beef steers, 508 to 510 lbs. live weight, \$134.50 to \$135.00. Good beef steers, 510 to 512 lbs. live weight, \$135.00 to \$135.50. Good beef steers, 512 to 514 lbs. live weight, \$135.50 to \$136.00. Good beef steers, 514 to 516 lbs. live weight, \$136.00 to \$136.50. Good beef steers, 516 to 518 lbs. live weight, \$136.50 to \$137.00. Good beef steers, 518 to 520 lbs. live weight, \$137.00 to \$137.50. Good beef steers, 520 to 522 lbs. live weight, \$137.50 to \$138.00. Good beef steers, 522 to 524 lbs. live weight, \$138.00 to \$138.50. Good beef steers, 524 to 526 lbs. live weight, \$138.50 to \$139.00. Good beef steers, 526 to 528 lbs. live weight, \$139.00 to \$139.50. Good beef steers, 528 to 530 lbs. live weight, \$139.50 to \$140.00. Good beef steers, 530 to 532 lbs. live weight, \$140.00 to \$140.50. Good beef steers, 532 to 534 lbs. live weight, \$140.50 to \$141.00. Good beef steers, 534 to 536 lbs. live weight, \$141.00 to \$141.50. Good