

# 'Flowers Are Forever' showcases Plymouth's green thumbs

Keep an eye out for colorful maypoles in Plymouth. They're signposts for the seventh annual "Flowers are Forever Garden Walk."

Presented each year by the Trailwood Garden Club, the Plymouth garden tour is scheduled noon to 8 p.m. Tuesday, June 25.

Making up the tour this year are seven home gardens, and three gardens on the grounds of the Fox Hills Golf and Banquet Center - a certified Audubon Sanctuary.

"The biggest garden that we have is a half acre. We try to get people who do their own gardens themselves," said Georgia Randinitis, president of the Trailwood Garden Club, which has about 25 members and was founded in 1976.

"These are not estate gardens. We like to have what we call 'do-able' gardens."

That way, novice gardeners leave with feasible

ideas and treatments for their own yards, said Randinitis.

Trailwood Garden Club, a member of the Women's National Farm and Garden Association, does plantings in downtown Plymouth and sponsors the Perennial Exchange at the Plymouth Fall Festival.

Garden walk highlights include English cottage flowers, a large pond with koi, alpine plants, a bog and bonsai.

Unusual garden accents are a point of interest in Mary Ann Mountain's garden where automotive antiques - a gas pump, tire pump, old parking meter and street signs - have been combined with flowers and plants.

"His interest is cars and the automotive industry. My interest is flowers," said Mountain.

"So we put the two together and this is what we



**Color and water:** For a healthy dose of color, Karen Gorman adds annuals to her Plymouth garden, which primarily contains native Michigan species.

got."

Another stop on the walk, Roy and Nancy Chapman's home, features mother and daughter gardens.

Karen Gorman's garden, which is less than one block from downtown Plymouth, blends the ease of natural wildlife.

Gorman, a landscape architect, has planted an abundance of Michigan native species in her garden in an attempt to transform it into a natural habitat.

"If we encourage people to plant native plants, we're creating habitats for birds, butterflies and other wildlife," said Gorman. "So many natural areas are shrinking because of building and construction."

Contrary to popular belief, natural gardens needn't look wild or forgo aesthetics, Gorman said, describing her garden as "highly ornamental and decorative."

"I'm trying to encourage people to plant native species and non-native plants that don't compete with indigenous species, so future generations have wildlife to enjoy."



**Gardener and ferns:** Karen Gorman poses in a patch of *Ostrich ferns* in her Plymouth garden.

## GARDEN CALENDAR

■ **Tollgate Gardens** at Michigan State University's Tollgate Education Center will have an open house 10 a.m. to 3 p.m. Saturday, June 22, to celebrate the Year of the Rose.

The MSU Tollgate Education Center is at 28115 Meadowbrook Road in Novi. Call (248) 347-3860 for information.

Mini seminars on roses, enabling garden, xeriscape garden, children's garden, and growing roses in Michigan will be conducted between 11 a.m. and 1 p.m. Volunteers will be available throughout the gardens to answer questions and guide visitors.

Winter hardy roses will be for sale along with garden art. Master gardeners will be on site to answer gardening questions.

Admission is free and refreshments will be served.

■ **The Michigan Regional Lily Society** Garden Tour will take place 10 a.m. Saturday, June 22.

A docent-led tour of the multi-acre Michigan State Demonstration Gardens will be included, with guests having the option of seeing the Butterfly Garden and Children's Garden on their own. Two home garden tours at members' gardens in Williamston and Mason, full of majestic hybrid lilies will also be featured.

Call Dick at (248) 349-3267 or Eileen at (248)

681-6453 for details.

■ **The Iris Club** of Southeast Michigan is sponsoring a mid-day bus tour of Enata Gardens in Kalamazoo 7 a.m. to 6 p.m. Saturday, June 29. The bus will leave from Southfield.

Cost is \$20 for the bus tour, and an additional \$6.50 for an all-you-can-eat buffet brunch at a restaurant. Seating is limited; to reserve your place on the bus, call Bob at (248) 646-5077. With 17 years of growing and selling Japanese and Siberian irises by mail order, Enata Gardens have the largest collection of Japanese varieties outside of Japan. Bring your camera. For a review of the gardens, visit [www.enata.com](http://www.enata.com).

■ **The Evening Herb Study Group** will have its monthly meeting 7 p.m. Monday, July 1. Group member Angie Smith will conduct a field trip to the Leslie Science Center Project Grow Gardens in Ann Arbor, which she volunteers to maintain.

Meet at 7 p.m. at the west parking lot of the University of Michigan Matthaei Botanical Gardens, 1800 Dixboro Road in Ann Arbor, to go as a group to the Leslie Science Center. Smith will give a tour of the gardens beginning at 7:30 a.m.

For more information, call H. Leland at (734) 459-8454 or e-mail [asmith@nsf.org](mailto:asmith@nsf.org).

## Design expert to speak at luncheon

Chris Madden, national design expert and author, will be at a luncheon at the 2002 Designer Show House Monday, June 24.

Madden will give a slide presentation, *From Oprah's Grounding Room to a Getaway in Vermont*, and sign her latest book, all sponsored by Borders Books & Music.

Tickets are \$50 and benefit the Suite Dreams Project, a non-profit organization that transforms bedrooms of chronically ill children into special places where they can rest and recover. The tickets include the presentation, a boxed lunch and a private tour of the show house.

The event will begin at 11:30 a.m., when the show house will open exclusively for event atten-

dees to tour at their leisure. At 1 p.m. the lunch will be served and Madden will give her presentation. After her talk, she will sign copies of her book and attendees may tour the house until 4 p.m.

Space is limited for the presentation and advance reservations are required.

For tickets for the luncheon, or for the public tours of the show house, call (248) 601-0799 or e-mail [sdp@generalsports.com](mailto:sdp@generalsports.com).

Borders Books & Music patrons may mention the Suite Dreams Project Friday, Saturday and Sunday, June 28, 29 and 30, and 15 percent of their purchases will benefit the organization.

At the show house, Madden will share interior design tips for turning homes into havens, and

answer questions about the latest design styles and techniques.

Her latest accomplishments include hosting HGTV's *Interior by Design* and writing columns in national newspapers.

She is the author of 14 books.

Sponsored by the Michigan Design Center, the Designer Show House is open to the public now to June 30.

Eighteen top local designers decorated the house, which is at 5566 Orchard Ridge Drive, south of Silverbell and east of Adams in the Orchard Ridge Development in Oakland Township.

Hours are 10 a.m. to 4 p.m. Tuesday-Sunday. Tickets for public tours are \$20 each, \$18 in advance.

## AS SEEN AT OTHER FURNITURE STORES AND EXPRESSES!

Introducing...

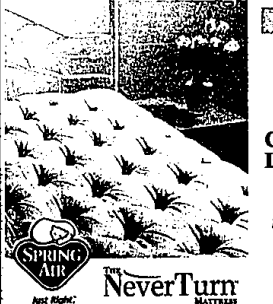

**ComfortFlex**  
The Mattress That Conforms To You™

OUR INTRODUCTORY LOW PRICE **\$998** queen set

reg. price \$2295 competition price \$1099

★ No Interest ★ No Payments  
★ No Money Down ★ For 12 Months  
with approved credit

NeverTurn DREAMSCAPE PLUSH BACK SUPPORTER		NeverTurn DREAMSCAPE RT. BACK SUPPORTER	
REGULAR	OUR PRICE	REGULAR	OUR PRICE
Twin	\$699/set	Twin	\$799/set
Full	\$799/set	Full	\$999/set
Queen	\$899/set	Queen	\$1099/set
King	\$1299/set	King	\$1499/set

NeverTurn EMPIRE PLUSH OR FIRM PREMIUM BACK SUPPORTER		NeverTurn NEWPORT X-FIRM OR PILLOW TOP PREMIUM BACK SUPPORTER	
REGULAR	OUR PRICE	REGULAR	OUR PRICE
Twin	\$899/set	Twin	\$1099/set
Full	\$1099/set	Full	\$1299/set
Queen	\$1299/set	Queen	\$1499/set
King	\$1699/set	King	\$1899/set

30 DAY HOME TRIAL



**THE MATTRESS SUPERSTORE**

**TROY** 1-800-668-MATS  
**NEW ROCHESTER** 1-800-579-MATS  
**WATERFORD** 1-800-929-MATS  
**ROYAL OAK** 1-800-339-MATS

## Spring Sale

This Month  
June  
**10% off**  
All Granite  
in stock  
sale items  
except

**Marble - Granite - Silkstone®**

Why buy countertops at retail when you can buy direct. Since we fabricate at our own locations, we beat the "Big Box" store pricing. We offer quick delivery and personalized service.

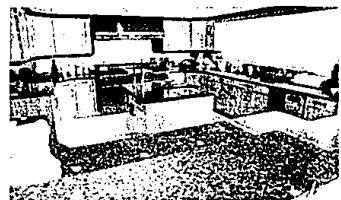

**Granite 3cm thick!**

\$45.95	S/F	Rosa Beta
\$45.95	S/F	Luna Pearl
\$45.95	S/F	Desert Gold
\$49.95	S/F	Impala Black
\$49.95	S/F	Verde Butterfly
\$52.95	S/F	Absolute Black

All prices include installation & measurement, straight polished edge 20 s/f minimum

**CERAMIC TILE INVENTORY BLOW-OUT SALE!**

**Tumbled Marble**

4x4 All Colors

8.75 S/F - 8.95 S/F

**Black Jack Slate**

12x12 1.99 S/F

**Introducing Silkstone!**

**\$29.95 s/f Installed!**

includes installation, measurements, straight polished edge, 20 s/f minimum.

**8 colors to choose from 2 cm Thick**

We stock over fifteen hundred slabs of Marble, Granite and Silkstone in over eighty unique colors. We stock the largest selection of imported ceramic tile in Michigan.

Check our prices first!



**Ceramic Tile Sales Inc.**  
**Marble & Granite Shop**

**Southfield**

23455 Telegraph Rd.

248-356-6430

**Farmington Hills**

24301 Indoplex Circle

(248) 426-0093

**Rochester**

1972 Star Batt Dr.

248-853-4654

Visit one of our Showrooms!

Installation includes Wayne, Oakland, and Macomb Counties. Others at additional cost. Offer not valid with any other discount. All previous orders excluded. Subject to stock on hand.

**Showroom Hours: M-T-Th 8:30-5:00; W-F 8:30-8:00; Sat 9:00-5:00**