

That NATURAL TOUCH!

What better way to complement nature than by selecting your outdoor furniture from Jimmies Rustics. And what a collection we have -- From Traditional to Contemporary styles, with colors that even Mother Nature will envy.

Casual furniture you'll love to live with -- and it folds! Rid-Jid casuuls

Here is casual furniture so beautiful it looks as much at home in your home as on your patio. And all these pieces fold flat for storage. The steel construction and special baked-on finish mean Rid-Jid can guarantee these casuuls against rust for five years. See our entire Rid-Jid collection soon. Available in Pompeian Green, Avocado, Satin White.

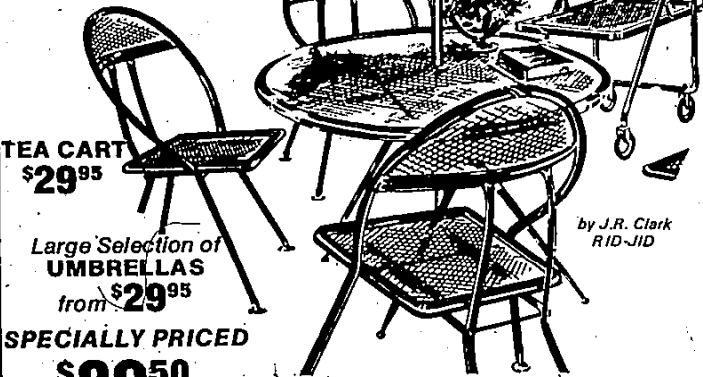

TEA CART
\$29⁹⁵

Large Selection of
UMBRELLAS
from \$29⁹⁵

SPECIALLY PRICED

\$89⁵⁰ (FOLDING TABLE AND 4 CHAIRS)

Genuine California
REDWOOD

2
INCHES
THICK

As sturdy as the tree itself -- fashioned by "VANDY CRAFT" to a smooth, clear appearance. Then pre-finished so that rain-drops just bounce off. Thick tufted canvas and vinyl-covered cushions for extra soft relaxation.

Sale
at \$159⁰⁰

Decorative & Practical
Cast Aluminum

FURNITURE



Cast aluminum furniture with lasting beauty. The perfect addition to any cared-for yard or patio

GRAPE SETTEE \$46⁰⁰

GRAPE CHAIRS \$24⁹⁵ ea.



NORTHWEST
18555 Jas. Couzens
2 Bks. S. of 7 Mile
on X-Way Service Dr.
Open Daily 9 to 5:30
DI 1-4000

BIRMINGHAM
221 Hamilton
North of 15 Mile
East of Woodward
Open Daily 9 to
5:30, Thurs. 9 to 3
MI 4-1919

LIVONIA
29500 W. 6 Mile
at Middlebelt
Open
Mon.-Tues.-Thurs.-Fri 9-9
Wed.-Sat. 9-5:30
Sun. 10-4
622-9200

LIVONIA STORE NOW OPEN SUN. - 10-4

Swinging Pleasure -- Fiber Craft
PATIO SWING



Keep Cool with this self-ventilating swing. Allows the breeze to blow through it.

Sale
at \$79⁹⁵



Outdoor Dining or Just
Relaxing With This:

5 PC. DINING SET

• Accent on elegance and durability
• Round umbrella table features generous 48" mesh top with double tubular steel legs.

Special \$169⁰⁰

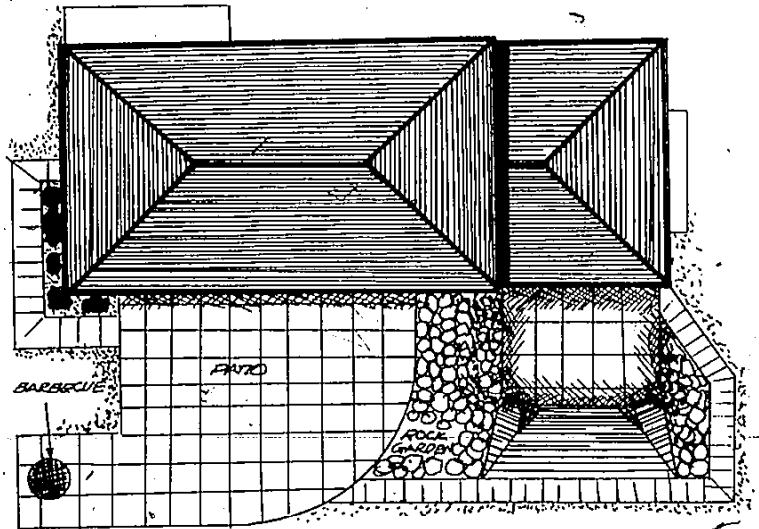

TO PLAN A PATIO allow an area for your barbecue, remember electrical outlets, take advantage of the beauty of existing trees and the natural terrain of your property.

PLANNING YOUR PATIO CAN BE PLEASURABLE

It used to be called a patio. These days, when more and more of the family activity and entertainment takes place there, it has become an extension of the home itself, and is the "party place."

According to the American Association of Nurserymen, the planning of an outdoor living area can be every bit as much fun as enjoying it later on. With outdoor living gaining prominent stature over recent years, the right kind of advance planning and preparation can be very worthwhile.

As one nursery industry leader puts it, "So many homes nowadays are built with a bare slab which serves as a patio. You can grill on it, you can sit on it, but it doesn't create any atmosphere which tends to expand the home. And that's where decorative planning usually begins." He's Robert Siebenthaler, an Ohio landscape expert who has had much experience in planning and installing outdoor living areas.

"The fact is," Siebenthaler says, "the same people who are very good at decorating the interior of their homes seem to doubt their own ability when it comes to decorating the room outside -- the patio or terrace."

THREE IMPORTANT ELEMENTS in the planning of a patio "party place," Siebenthaler thinks, are privacy, beauty, and environmental health. He suggests a simple and common-sense approach to accomplishing all three objectives.

"Even people who like big open spaces around their home seem to require a bit of privacy when it comes to decorating their patios or terraces," he says. "The way this is achieved depends on the setting. If you're sitting next to a two-story house that's looking right down on your outside party room, perhaps a shade tree is the best idea for the basic plan. In another case a hedge or shrub planting would provide the screening you need."

Along with the privacy, most people appreciate an open vista permitting a view of the more attractive areas of the yard or neighborhood surroundings, and this should be a part of the decorating plan.

"A part of the plan must account for the location of the patio or terrace party place," the AAN spokesman points out. "If the space is on the west side or exposed to the sun so the evening hour is sun-drenched to make a little oven there, then shade is much more important than if the area is situated where the sun is not a factor. These are the things the amateur decorator can handle," he says. "The need for particular kinds of privacy, shade, view -- all are accomplished by planting the right materials in the right places. And it doesn't have to be difficult or expensive."

COLOR SPOTS are a major consideration in decorating the outdoor party place. Potted plants or flower boxes of annuals or perennials often fill this need. Some may prefer the planting of flowering trees or bushes. "Maintenance should be considered in this connection," the Ohio landscape planner and installer says. "Frankly, if a homeowner's design is within his ability to maintain easily it's going to be better, in the long run, than a more elaborate design which may eventually look unkept."

The members of the American Association of Nurserymen are talking a great deal, these days, about the effect of plantings on the health of our environment, and this is a major point in the decorating of the outdoor party place. "Trees and bushes and plants are nature's gifts to improve the part of the world in which each of us lives," they say.

"Plant parts act to capture the impurities in the air, contributing to a breathable, livable atmosphere. They screen out noise pollution. They feed the earth."