

Fine Schools, Area Recreation

The Farmington School District serves the City and Township.

An excellent school system is available to the residents in the vicinity of this site. The Farmington

high school is less than 2,000 feet north of the site and the junior high is approximately three-quarters of a mile distance from the site in question.

The Cloverdale elementary school is due west of the site less than one-half mile away. Walking distance to this school by way of existing streets will be approximately three-quarters of a mile.

Community recreation facilities are well within walking distance. A large and well diversified recreation park with tennis courts, playground, picnic area, and other activity areas is within 2,000 feet of this site.

The schools previously mentioned are well suited for indoor recreational use as well as providing outdoor active sports areas which are utilized by the community at large.

Best Appliances In Every Unit

Westinghouse appliances were selected for Brookdale Club for their excellent reliability, quiet operation, and the availability of the complete line necessary.

Included in each and every apartment is a large Westinghouse refrigerator with freezer space and a 30 inch electric range. Also located in the kitchen is a Westinghouse garbage disposal.

Air conditioning is also by Westinghouse, and located under the picture window in each living room. Automatic clothes washer and dryer are built directly into each apartment bathroom, and provide a convenience for washing, quite unusual in apartment living.

The ranges provide high speed broiling, miracle sealed oven, appliance outlet, porcelain enamel over interior, single dial oven control, reversible oven rack, oven signal light, storage space, lift off door for easy cleaning, and lift up service units.

The refrigerator provides 77 pounds frozen food storage, plenty of shelf space, full width crisper, whisper quiet mechanism, total volume 11.6 cubic feet, frozen storage tray, and special two position shelf.

The air conditioning unit provides variable ventilation control, adjustable thermostat, filtered air, adjustable air, push button controls, two speed fan, and quiet operation.

Central Heating System Provided

Another fine feature to be found at Brookdale Club is the hot water baseboard heat provided by the management. This clean, quiet, and effective heating system, together with the air-conditioning units in central vacuum system, provide possibly the cleanest living available.

The hot water is also supplied to the apartment by management, and is a welcome addition to many residents. Individual controls for each apartment is still another advantage built in these units.

The resident can control, to the exact degree, the warmth of the apartment. Silent solenoid valves quietly and automatically maintain the proper temperature.

Churches

Detroit Council of Churches has been actively engaged in the promotion of facilities to serve all denominations.



OFF FROM THE swimming club and community room is a spacious patio area for relaxing and friendly conversation with other residents of the Brookdale Club. The

building is so designed that the swimming pool and community room area opens up onto the patio during the warm summer months.

Built in Vacuums Provided For All

New innovation and convenience to apartment residents is made available at Brookdale Club. A complete vacuum system has been installed by Grover Transutubes to provide dustless cleaning for the residents.

Regardless of how good a vacuum might be, it still emits fine particles of dust through the blower system or through the bag, as in upright models. The great advantage to the built-in system is primarily this complete avoidance of residual dust. Those that have had these expensive appliances installed in custom residences have been overwhelmingly pleased by the lack of

dusting necessary.

Another benefit to the resident is, of course, the elimination of an investment in a vacuum cleaner. Still another is the elimination of noise, as the power unit is located away from the apartment.

Noise is also eliminated when the halls and carpeting are vacuumed by the management, as there is an outlet provided in the hall for this purpose.

Still another benefit is the aggravation of a person's personal vacuum breaking down, and having to pay repair bills. One simply plugs the light and lengthy hose, provided by management, into the wall outlet, and this automatically turns on the unit.

The resident then proceeds with the cleaning of the apartment, and by simply unplugging the hose, the job is complete.

Well Lighted Whole Area

To see Brookdale Club Apartments during the light of day and enjoy the beauty of the surroundings is truly a pleasure, but to see it at night is fascinating.

From dusk till dawn 257 lights sparkle and light the entire area so that residents may wander about in the warmth of the evening in complete confidence and relaxation. This is one of the points most often requested by apartment residents. To be able to come home in the evening; come and go at will during the evening hours; and return to a well lighted parking area, walk area, and lobby entrance, is an item of great importance.

The picturesque post-lamps that march along the beautiful surrounding fence and wend their way through the valley beside the stream are delightful.

Additional postlanterns sprinkled throughout the general area, together with the chandeliers at both entrances to the lobbies, and the other Early American fixtures make walking a pleasure.

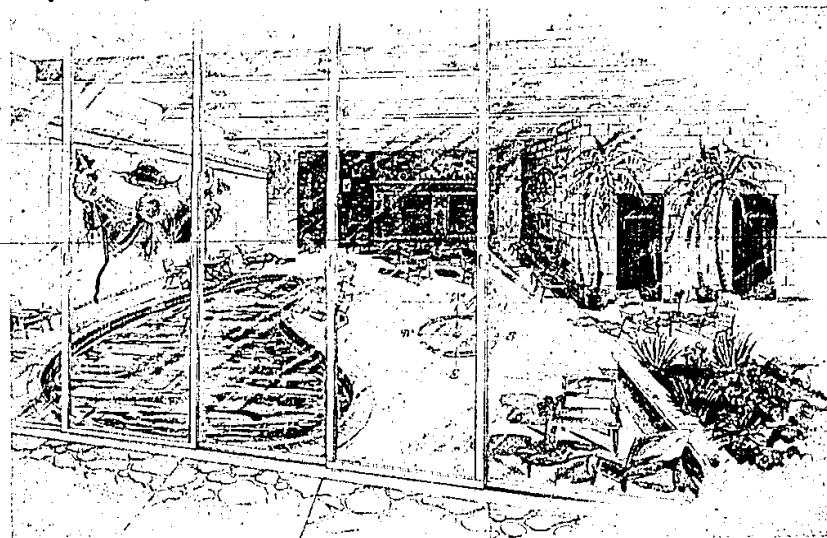

A YEAR AROUND indoor swimming pool and summer sun deck is a new innovation in apartment living at Brookdale Club. In addition to the kidney-shaped swimming

pool in the community house there is a huge barbecue fireplace for poolside parties. Locker room and bath facilities are all provided.

Apt. Carpets By Bigelow

Fine carpets by Bigelow grace the lobbies and apartments of Brookdale Club. Warm tweeds were selected for the lobbies and apartments at Brookdale, and provide quiet and luxurious hallways, lobbies, and private units.

The nuisance and expense of carpeting your apartment is eliminated at Brookdale Club. This usually considerable expense is omitted by the management, providing complete wall to wall carpeting, including the closets, for the residents.

After examining and testing many types of carpeting, Bigelow was chosen for its fine quality merchandise and reputation. The draperies were also selected from one of the finest lines in the country, and are all traverse and weighted cords are supplied to prevent the nuisance of finding a short end.

This is another rather sizeable item that Brookdale Club residents are treated to.

Also Offering Furnished Apts

Possibly one of the nicest features at Brookdale Club is the furnished apartment available for the person who so desires.

The furniture is of excellent quality, and nowhere can one find inexpensive furniture or appointments. Carpets by Bigelow, drapes by Desley, rods by Kirsch, lamps by Steffel and Phil-Mar, appliances by Westinghouse, vacuum system by Grover Transutubes, furniture by Heywood Wakefield, accessories by Fine Arts, hide-a-beds by Simmons, all provide a top quality and luxurious home for Brookdale Club residents.