

**306 Southfield-Lathrup**  
**OPEN SUN. 1-5**  
**LATHRUP VILLAGE**  
**IMMEDIATE OCCUPANCY**  
 2715 Getzle Gate Dr. West  
 N. of 11 Mile W. of Southfield, 3 bed-  
 room brick ranch, country kitchen, full  
 basement with rec. room, fireplace, liv-  
 ing room, huge handicapped lot, 2 car  
 attached garage, flexible land contract  
 terms. \$112,500. Call 659-4488

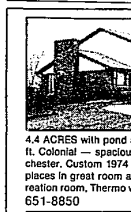

**CENTURY 21**  
 TODAY 559-4488

**4.4 ACRES** with pond and big 27' 10 sq.  
 ft. Colonial - spacious comfort in Ro-  
 chester. Custom 1974 home has 2 fire-  
 places in great room and walk-out rec-  
 room. Therm. windows.  
 651-8850 \$164,900



**EXCELLENCE!** Executive 3 bedroom, 4  
 bath ranch is beautifully decorated, has  
 new microwave kitchen, great fire-  
 placed family room, recreation room,  
 central air and...!  
 626-9100 \$119,900



**IMMEDIATE OCCUPANCY** of immacu-  
 late Farmington Hills home. Fireplaced  
 family room, finished recreation room  
 plus office, 4 bedrooms, super kitchen,  
 central air, circle drive.  
 851-8100 \$106,000

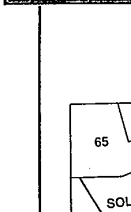

**VIEWES GREAT OAKS** golf course, has  
 heated indoor pool-vacation living in  
 Rochester. Palatial 4 bedroom home  
 with library, fireplaced family room,  
 prime SIMPLE ASSUMPTION.  
 851-8850 \$154,900

**COMMERCIAL LAKE** privileges, state  
 land in back enhance attractive 3 bed-  
 room, 1 1/2 bath home with fireplaced  
 family room, wood cathedral ceilings,  
 fenced yard.  
 626-9100 \$69,900

**FARMINGTON HILLS - FRANKLIN OFFICE** 626-9100  
**ROCHESTER OFFICE** 651-8850  
**WEST BLOOMFIELD OFFICE** 851-8100

**306 Southfield-Lathrup**  
**OPEN SUN. 1-5**  
**1855 KILBURN** Lathrup Village  
 3 1/2 miles W. of Southfield, 3 bed-  
 room brick ranch, country kitchen, full  
 basement with rec. room, fireplace, liv-  
 ing room, attached garage, large lot,  
 central air, immaculate condition. Ask  
 \$119,500



**CENTURY 21**  
 TODAY 559-4488

**BAVING SETTING** Custom built 3  
 bedroom Cape Cod with deck, 2 car gar-  
 age, walk-out basement and over 1  
 acre. Country living in the city. Land  
 contract terms available. Priced at  
 only \$89,900 Century 21. 333-4466

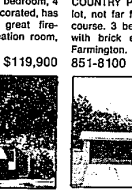

**306 Southfield-Lathrup**  
**SOUTHFIELD**  
**IMMEDIATE POSSESSION, 4**  
**bedroom Tri-Level with dining**  
**room, library, family**  
**room, fireplace, 2 1/2 baths. A**  
**lovely home - centrally locat-**  
**ed. \$83,900.**



**306 Southfield-Lathrup**  
**SOUTHFIELD**  
**UNIQUE RANCH IN BRILLIANT AREA.**  
**4 bedrooms, 2 1/2 baths, central**  
**air, fireplace, large deck, walk-**  
**out to pool, separate formal dining**  
**room, family room with outdoor ceiling**  
**fan, central air & sprinklers. LAND**  
**CONTRACT. \$114,500.**

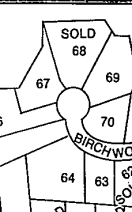

**306 Southfield-Lathrup**  
**REDDING**  
**Assoc. 569-7020**  
**PRESTIGIOUS**  
**LATHRUP VILLAGE**  
 Superbly maintained brick  
 ranch with attached garage  
 featuring lovely foyer, out-  
 standing kitchen, first floor  
 laundry, 3 bedrooms, 2 1/2  
 baths. Land contract in  
 qualified buyer. Super value  
 at \$92,500. Call 645-9700.

**306 Southfield-Lathrup**  
**SOUTHFIELD**  
**OPEN SUN. 2-5**  
**29234 FAIRFAX**  
 (N. of 11 W. of Crestfield)  
 Good looking contemporary 3 bedroom  
 brick ranch, newly decorated with love-  
 ly wallpaper & wood treatments.  
 fireplace in living room, appliances in  
 kitchen, stone refrigerator, microwave  
 dishwasher. \$142,900

**REDDING** 569-7020  
**PALMER** REALTORS

**308 Rochester-Troy**  
**ASSUME MORTGAGE** 2 1/2 - share  
 fireplace, 2 baths, 2 car garage.  
 \$23,900 Agent



**308 Rochester-Troy**  
**PREMIUM LOT**  
 4 bedrooms, 2 1/2 baths, great living  
 room with wood, living dining, fire-  
 place, central air, unique patio, professionally  
 landscaped. Call 651-8850  
 \$17,900  
 \$17,900  
 \$17,900

**308 Rochester-Troy**  
**ROCHESTER**  
**Att: Transferees**  
**SPECIAL LOW-NO-MONEY**  
**AVAILABLE**  
 For these luxury colonial, quad and  
 ranch with woodwork, granite, marble  
 and loaded with extras. Located in  
 beautiful Wood Hill Park on 1/2 acre. 10  
 ft. W. of Lawrence. Clearing  
 trees, must be seen. See 11/15/79. Call  
 for referral Willoughby Woodman  
 & Komer Building Co. 649-2800

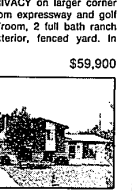

**308 Rochester-Troy**  
**ROCHESTER**  
 FOUR bedroom custom colonial in  
 Stratford Knolls, features air condi-  
 tioning, sprinkler system, family room  
 with fireplace, 2 1/2 baths, full floor  
 laundry and much more on a large main-  
 tenance lot.  
 \$184,500

**308 Rochester-Troy**  
**ROCHESTER**  
 ASSUME 2 1/2 - mortgage with only  
 \$24,875 on this 6 bedroom colonial with  
 library, neutral decor, in excellent con-  
 dition. Immediate possession. \$108,500

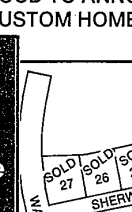

**308 Rochester-Troy**  
**ROCHESTER**  
 FOUR bedroom Williamsburg colonial,  
 settled in the woods in one of Roches-  
 ter's finest areas, superb landscaping,  
 deck, three out, call for personal showing  
 \$114,900

**308 Rochester-Troy**  
**ROCHESTER**  
 SHEPARD  
**GALLERY**  
**OF**  
**HOMES**  
 652-6900

**308 Rochester-Troy**  
**ROCHESTER**  
**MODEL CLOSOUT**  
**0.94 & 10%**  
**MORTGAGES**  
 4 bedroom, 2 1/2 bath, fireplace, full  
 floor laundry, full finished garage, full  
 11' x 11' lot. Immediate Occupancy. 10  
 Year Home Warranty \$13,900.  
 CALL JIM SEELY  
 AT 255-2650  
 Daily 12 to 6 PM

**308 Northville-Novi**  
**Attention:**  
**HORSE LOVERS**  
 Approx. 5 prime acres with wood  
 framed house, pool, all appliances,  
 separate 1 car garage, lots of trees and  
 excellent possibilities - plus completely  
 upgraded 5 bedroom ranch with fire-  
 placed living, 3 baths, family room, fire-  
 place, basement (fireplace and shower,  
 finished 2 car garage, full water.  
 Asking \$99,500 Call 459-5212

**ONE WAY**  
**Charming Colonial**  
 Located in beautiful  
 Novi. Only fireplace for cool fall nights.  
 First floor laundry. Only \$139,900

**308 Rochester-Troy**  
**ROCHESTER**  
**Att: Transferees**  
**SPECIAL LOW-NO-MONEY**  
**AVAILABLE**  
 For these luxury colonial, quad and  
 ranch with woodwork, granite, marble  
 and loaded with extras. Located in  
 beautiful Wood Hill Park on 1/2 acre. 10  
 ft. W. of Lawrence. Clearing  
 trees, must be seen. See 11/15/79. Call  
 for referral Willoughby Woodman  
 & Komer Building Co. 649-2800



**308 Rochester-Troy**  
**ROCHESTER**  
 FOUR bedroom custom colonial in  
 Stratford Knolls, features air condi-  
 tioning, sprinkler system, family room  
 with fireplace, 2 1/2 baths, full floor  
 laundry and much more on a large main-  
 tenance lot.  
 \$184,500

**308 Rochester-Troy**  
**ROCHESTER**  
 ASSUME 2 1/2 - mortgage with only  
 \$24,875 on this 6 bedroom colonial with  
 library, neutral decor, in excellent con-  
 dition. Immediate possession. \$108,500



**308 Rochester-Troy**  
**ROCHESTER**  
 FOUR bedroom Williamsburg colonial,  
 settled in the woods in one of Roches-  
 ter's finest areas, superb landscaping,  
 deck, three out, call for personal showing  
 \$114,900

**308 Rochester-Troy**  
**ROCHESTER**  
 SHEPARD  
**GALLERY**  
**OF**  
**HOMES**  
 652-6900

**308 Rochester-Troy**  
**ROCHESTER**  
**MODEL CLOSOUT**  
**0.94 & 10%**  
**MORTGAGES**  
 4 bedroom, 2 1/2 bath, fireplace, full  
 floor laundry, full finished garage, full  
 11' x 11' lot. Immediate Occupancy. 10  
 Year Home Warranty \$13,900.  
 CALL JIM SEELY  
 AT 255-2650  
 Daily 12 to 6 PM

**308 Northville-Novi**  
**Attention:**  
**HORSE LOVERS**  
 Approx. 5 prime acres with wood  
 framed house, pool, all appliances,  
 separate 1 car garage, lots of trees and  
 excellent possibilities - plus completely  
 upgraded 5 bedroom ranch with fire-  
 placed living, 3 baths, family room, fire-  
 place, basement (fireplace and shower,  
 finished 2 car garage, full water.  
 Asking \$99,500 Call 459-5212

**ONE WAY**  
**Charming Colonial**  
 Located in beautiful  
 Novi. Only fireplace for cool fall nights.  
 First floor laundry. Only \$139,900

**EARL**  
**KEIM**  
 Realty-Midwest 477-8080

**JAMESTOWN GREEN**  
**IMMEDIATE OCCUPANCY**  
 5% FINANCING  
**AVAILABLE**  
 Located in family room and  
 colonial in family room that may be  
 used. In beautiful Highland Lakes Sub-  
 division Northville, Michigan. Con-  
 tract to express \$39,900.

**308 Rochester-Troy**  
**ROCHESTER**  
**Att: Transferees**  
**SPECIAL LOW-NO-MONEY**  
**AVAILABLE**  
 For these luxury colonial, quad and  
 ranch with woodwork, granite, marble  
 and loaded with extras. Located in  
 beautiful Wood Hill Park on 1/2 acre. 10  
 ft. W. of Lawrence. Clearing  
 trees, must be seen. See 11/15/79. Call  
 for referral Willoughby Woodman  
 & Komer Building Co. 649-2800



**308 Rochester-Troy**  
**ROCHESTER**  
 FOUR bedroom custom colonial in  
 Stratford Knolls, features air condi-  
 tioning, sprinkler system, family room  
 with fireplace, 2 1/2 baths, full floor  
 laundry and much more on a large main-  
 tenance lot.  
 \$184,500

**308 Rochester-Troy**  
**ROCHESTER**  
 ASSUME 2 1/2 - mortgage with only  
 \$24,875 on this 6 bedroom colonial with  
 library, neutral decor, in excellent con-  
 dition. Immediate possession. \$108,500

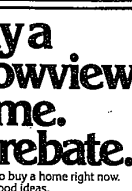

**308 Rochester-Troy**  
**ROCHESTER**  
 FOUR bedroom Williamsburg colonial,  
 settled in the woods in one of Roches-  
 ter's finest areas, superb landscaping,  
 deck, three out, call for personal showing  
 \$114,900

**308 Rochester-Troy**  
**ROCHESTER**  
 SHEPARD  
**GALLERY**  
**OF**  
**HOMES**  
 652-6900

**308 Rochester-Troy**  
**ROCHESTER**  
**MODEL CLOSOUT**  
**0.94 & 10%**  
**MORTGAGES**  
 4 bedroom, 2 1/2 bath, fireplace, full  
 floor laundry, full finished garage, full  
 11' x 11' lot. Immediate Occupancy. 10  
 Year Home Warranty \$13,900.  
 CALL JIM SEELY  
 AT 255-2650  
 Daily 12 to 6 PM

**308 Northville-Novi**  
**Attention:**  
**HORSE LOVERS**  
 Approx. 5 prime acres with wood  
 framed house, pool, all appliances,  
 separate 1 car garage, lots of trees and  
 excellent possibilities - plus completely  
 upgraded 5 bedroom ranch with fire-  
 placed living, 3 baths, family room, fire-  
 place, basement (fireplace and shower,  
 finished 2 car garage, full water.  
 Asking \$99,500 Call 459-5212

**ONE WAY**  
**Charming Colonial**  
 Located in beautiful  
 Novi. Only fireplace for cool fall nights.  
 First floor laundry. Only \$139,900

**EARL**  
**KEIM**  
 Realty-Midwest 477-8080

**JAMESTOWN GREEN**  
**IMMEDIATE OCCUPANCY**  
 5% FINANCING  
**AVAILABLE**  
 Located in family room and  
 colonial in family room that may be  
 used. In beautiful Highland Lakes Sub-  
 division Northville, Michigan. Con-  
 tract to express \$39,900.

**308 Rochester-Troy**  
**ROCHESTER**  
**Att: Transferees**  
**SPECIAL LOW-NO-MONEY**  
**AVAILABLE**  
 For these luxury colonial, quad and  
 ranch with woodwork, granite, marble  
 and loaded with extras. Located in  
 beautiful Wood Hill Park on 1/2 acre. 10  
 ft. W. of Lawrence. Clearing  
 trees, must be seen. See 11/15/79. Call  
 for referral Willoughby Woodman  
 & Komer Building Co. 649-2800



**308 Rochester-Troy**  
**ROCHESTER**  
 FOUR bedroom custom colonial in  
 Stratford Knolls, features air condi-  
 tioning, sprinkler system, family room  
 with fireplace, 2 1/2 baths, full floor  
 laundry and much more on a large main-  
 tenance lot.  
 \$184,500

**308 Rochester-Troy**  
**ROCHESTER**  
 ASSUME 2 1/2 - mortgage with only  
 \$24,875 on this 6 bedroom colonial with  
 library, neutral decor, in excellent con-  
 dition. Immediate possession. \$108,500



**308 Rochester-Troy**  
**ROCHESTER**  
 FOUR bedroom Williamsburg colonial,  
 settled in the woods in one of Roches-  
 ter's finest areas, superb landscaping,  
 deck, three out, call for personal showing  
 \$114,900

**308 Rochester-Troy**  
**ROCHESTER**  
 SHEPARD  
**GALLERY**  
**OF**  
**HOMES**  
 652-6900

**308 Rochester-Troy**  
**ROCHESTER**  
**MODEL CLOSOUT**  
**0.94 & 10%**  
**MORTGAGES**  
 4 bedroom, 2 1/2 bath, fireplace, full  
 floor laundry, full finished garage, full  
 11' x 11' lot. Immediate Occupancy. 10  
 Year Home Warranty \$13,900.  
 CALL JIM SEELY  
 AT 255-2650  
 Daily 12 to 6 PM

**308 Northville-Novi**  
**Attention:**  
**HORSE LOVERS**  
 Approx. 5 prime acres with wood  
 framed house, pool, all appliances,  
 separate 1 car garage, lots of trees and  
 excellent possibilities - plus completely  
 upgraded 5 bedroom ranch with fire-  
 placed living, 3 baths, family room, fire-  
 place, basement (fireplace and shower,  
 finished 2 car garage, full water.  
 Asking \$99,500 Call 459-5212

**ONE WAY**  
**Charming Colonial**  
 Located in beautiful  
 Novi. Only fireplace for cool fall nights.  
 First floor laundry. Only \$139,900

**EARL**  
**KEIM**  
 Realty-Midwest 477-8080

**JAMESTOWN GREEN**  
**IMMEDIATE OCCUPANCY**  
 5% FINANCING  
**AVAILABLE**  
 Located in family room and  
 colonial in family room that may be  
 used. In beautiful Highland Lakes Sub-  
 division Northville, Michigan. Con-  
 tract to express \$39,900.

**308 Rochester-Troy**  
**ROCHESTER**  
**Att: Transferees**  
**SPECIAL LOW-NO-MONEY**  
**AVAILABLE**  
 For these luxury colonial, quad and  
 ranch with woodwork, granite, marble  
 and loaded with extras. Located in  
 beautiful Wood Hill Park on 1/2 acre. 10  
 ft. W. of Lawrence. Clearing  
 trees, must be seen. See 11/15/79. Call  
 for referral Willoughby Woodman  
 & Komer Building Co. 649-2800



**308 Rochester-Troy**  
**ROCHESTER**  
 FOUR bedroom custom colonial in  
 Stratford Knolls, features air condi-  
 tioning, sprinkler system, family room  
 with fireplace, 2 1/2 baths, full floor  
 laundry and much more on a large main-  
 tenance lot.  
 \$184,500

**308 Rochester-Troy**  
**ROCHESTER**  
 ASSUME 2 1/2 - mortgage with only  
 \$24,875 on this 6 bedroom colonial with  
 library, neutral decor, in excellent con-  
 dition. Immediate possession. \$108,500



**308 Rochester-Troy**  
**ROCHESTER**  
 FOUR bedroom Williamsburg colonial,  
 settled in the woods in one of Roches-  
 ter's finest areas, superb landscaping,  
 deck, three out, call for personal showing  
 \$114,900

**308 Rochester-Troy**  
**ROCHESTER**  
 SHEPARD  
**GALLERY**  
**OF**  
**HOMES**  
 652-6900

**308 Rochester-Troy**  
**ROCHESTER**  
**MODEL CLOSOUT**  
**0.94 & 10%**  
**MORTGAGES**  
 4 bedroom, 2 1/2 bath, fireplace, full  
 floor laundry, full finished garage, full  
 11' x 11' lot. Immediate Occupancy. 10  
 Year Home Warranty \$13,900.  
 CALL JIM SEELY  
 AT 255-2650  
 Daily 12 to 6 PM

**308 Northville-Novi**  
**Attention:**  
**HORSE LOVERS**  
 Approx. 5 prime acres with wood  
 framed house, pool, all appliances,  
 separate 1 car garage, lots of trees and  
 excellent possibilities - plus completely  
 upgraded 5 bedroom ranch with fire-  
 placed living, 3 baths, family room, fire-  
 place, basement (fireplace and shower,  
 finished 2 car garage, full water.  
 Asking \$99,500 Call 459-5212

**ONE WAY**  
**Charming Colonial**  
 Located in beautiful  
 Novi. Only fireplace for cool fall nights.  
 First floor laundry. Only \$139,900

**EARL**  
**KEIM**  
 Realty-Midwest 477-8080

**JAMESTOWN GREEN**  
**IMMEDIATE OCCUPANCY**  
 5% FINANCING  
**AVAILABLE**  
 Located in family room and  
 colonial in family room that may be  
 used. In beautiful Highland Lakes Sub-  
 division Northville, Michigan. Con-  
 tract to express \$39,900.

**308 Rochester-Troy**  
**ROCHESTER**  
**Att: Transferees**  
**SPECIAL LOW-NO-MONEY**  
**AVAILABLE**  
 For these luxury colonial, quad and  
 ranch with woodwork, granite, marble  
 and loaded with extras. Located in  
 beautiful Wood Hill Park on 1/2 acre. 10  
 ft. W. of Lawrence. Clearing  
 trees, must be seen. See 11/15/79. Call  
 for referral Willoughby Woodman  
 & Komer Building Co. 649-2800



**308 Rochester-Troy**  
**ROCHESTER**  
 FOUR bedroom custom colonial in  
 Stratford Knolls, features air condi-  
 tioning, sprinkler system, family room  
 with fireplace, 2 1/2 baths, full floor  
 laundry and much more on a large main-  
 tenance lot.  
 \$184,500

**308 Rochester-Troy**  
**ROCHESTER**  
 ASSUME 2 1/2 - mortgage with only  
 \$24,875 on this 6 bedroom colonial with  
 library, neutral decor, in excellent con-  
 dition. Immediate possession. \$108,500



**308 Rochester-Troy**  
**ROCHESTER**  
 FOUR bedroom Williamsburg colonial,  
 settled in the woods in one of Roches-  
 ter's finest areas, superb landscaping,  
 deck, three out, call for personal showing  
 \$114,900

**308 Rochester-Troy**  
**ROCHESTER**  
 SHEPARD  
**GALLERY**  
**OF**  
**HOMES**  
 652-6900

**308 Rochester-Troy**  
**ROCHESTER**  
**MODEL CLOSOUT**  
**0.94 & 10%**  
**MORTGAGES**  
 4 bedroom, 2 1/2 bath, fireplace, full  
 floor laundry, full finished garage, full  
 11' x 11' lot. Immediate Occupancy. 10  
 Year Home Warranty \$13,900.  
 CALL JIM SEELY  
 AT 255-2650  
 Daily 12 to 6 PM

**308 Northville-Novi**  
**Attention:**  
**HORSE LOVERS**  
 Approx. 5 prime acres with wood  
 framed house, pool, all appliances,  
 separate 1 car garage, lots of trees and  
 excellent possibilities - plus completely  
 upgraded 5 bedroom ranch with fire-  
 placed living, 3 baths, family room, fire-  
 place, basement (fireplace and shower,  
 finished 2 car garage, full water.  
 Asking \$99,500 Call 459-5212

**ONE WAY**  
**Charming Colonial**  
 Located in beautiful  
 Novi. Only fireplace for cool fall nights.  
 First floor laundry. Only \$139,900

**EARL**  
**KEIM**  
 Realty-Midwest 477-8080

**JAMESTOWN GREEN**  
**IMMEDIATE OCCUPANCY**  
 5% FINANCING  
**AVAILABLE**  
 Located in family room and  
 colonial in family room that may be  
 used. In beautiful Highland Lakes Sub-  
 division Northville, Michigan. Con-  
 tract to express \$39,900.

**308 Rochester-Troy**  
**ROCHESTER**  
**Att: Transferees**  
**SPECIAL LOW-NO-MONEY**  
**AVAILABLE**  
 For these luxury colonial, quad and  
 ranch with woodwork, granite, marble  
 and loaded with extras. Located in  
 beautiful Wood Hill Park on 1/2 acre. 10  
 ft. W. of Lawrence. Clearing  
 trees, must be seen. See 11/15/79. Call  
 for referral Willoughby Woodman  
 & Komer Building Co. 649-2800



**308 Rochester-Troy**  
**ROCHESTER**  
 FOUR bedroom custom colonial in  
 Stratford Knolls, features air condi-  
 tioning, sprinkler system, family room  
 with fireplace, 2 1/2 baths, full floor  
 laundry and much more on a large main-  
 tenance lot.  
 \$184,500

**308 Rochester-Troy**  
**ROCHESTER**  
 ASSUME 2 1/2 - mortgage with only  
 \$24,875 on this 6 bedroom colonial with  
 library, neutral decor, in excellent con-  
 dition. Immediate possession. \$108,500



**308 Rochester-Troy**  
**ROCHESTER**  
 FOUR bedroom Williamsburg colonial,  
 settled in the woods in one of Roches-  
 ter's finest areas, superb landscaping,  
 deck, three out, call for personal showing  
 \$114,900