

Let the sun in — through the roof

If the windows in your home don't provide enough daylight, skylights may be the most efficient way to brighten the rooms and create a feeling of drama and excitement. They not only provide natural daylight from the ceiling area but visually enlarge small spaces.

Skylights have become increasingly popular just about everywhere in a house — hallways, dens, kitchens, bathrooms and even bedrooms. They are also being installed in additions to older houses where structural problems limit light from windows.

The most efficient skylights have double or triple glazing and thermalized frames. This means the frame has a built-in insulating barrier between the inside and outside surfaces. The break in the frame prevents the cold outside air from being conducted inside the house through the frame.

Most skylights are prefabricated in a wide variety of sizes and shapes, but some are custom-formed. Flat tops seem to be preferred over domed units because they are unobtrusive and blend more easily into the roof.

THESE SKYLIGHTS incorporate tempered glass or plastic set into a rigid frame which has a self-flashing perimeter and permanent weather sealing. Interior frames have either aluminum or wood finishes.

Clear or tinted panels are available. Tinted or reflective glass or plastic allows for greater sun control without changing colors inside or outside the room.

In winter, well-insulated skylights reduce some of the need for electric lighting and admit solar heat to keep the room warm. Although most skylights are permanently sealed into the roof, some have vents and screens. These are particularly effective for removing smoke and cooking odors.

WHENEVER POSSIBLE, a skylight should be installed flush with the roof of a building. Where the roof is pitched or there is an attic above the room, a skylight can be tunneled from the ceiling to the roof.

Such "vaulted" skylights were installed in a recent kitchen addition where there was a structural problem.

ENERGY SAVINGS - SAFELY!

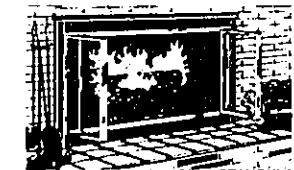

Custom-Made Arch Doors **ON SALE**

12 Finishes to Choose From 6 to 10 Week Delivery

BRAND NAME SOLID BRASS RECTANGULAR **GLASS DOORS ON SALE** 10% to 40% OFF Most Sizes and Finishes in Stock

U.L. Listed Airtight Stoves & Inserts **ON SALE**

MICHIGAN FIREPLACE & BARBEQUE

2908 Long Lake Rd. (at Dequindre) TROY 689-2296 Mon.-Wed.: 10-7; Thurs. & Fri.: 10-9; Sat.: 10-8



WINTER SHRUB PROTECTION

PRUNING • BRACING • FERTILIZING
TREE, SHRUB AND STUMP REMOVAL
DIAGNOSIS AND CONSULTATIONS
SPRAYING FOR INSECT & PLANT
DISEASE CONTROL

Free Estimates • Certified & Insured

FINISHED RESULTS PROVE IT COSTS LESS TO GO WITH A PROFESSIONAL

OUR ROOTS GO BACK TO 1927

1903 BELLAIRE, ROYAL OAK • MEMBER ISA • MPAA • MDLA

646-7777

Introducing the SLIDE-MOUNT ALL AMERICAN HUGGER®

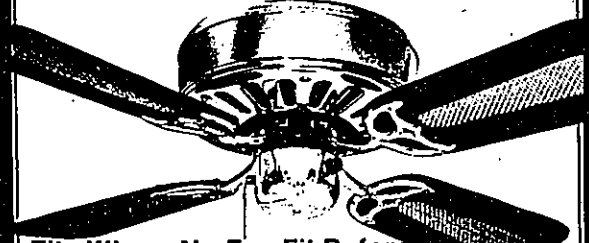

Fits Where No Fan Fit Before

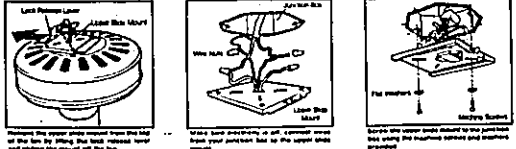

\$159.00 PRICE EFFECTIVE THRU SEPT. 24th AVAILABLE IN ANTIQUE OR BRIGHT BRASS

Pine Tree Lighting

Be Sure To Visit Our New Shade Shop at Our Lake Orion Store
7200 Dixie Hwy. Clarkston 625-8200
1447 S. Lapeer Lake Orion 693-8248
4815 Van Dyke Utica 728-8810

ALL LIGHTING DISCOUNTED DAILY

GREAT FALL SAVINGS AT SCHAEFER GREENHOUSE

25% OFF ALL NURSERY STOCK

- | | | |
|--|---|--|
| POTTED EVERGREENS | FLOWERING SHRUBS | TREES |
| <ul style="list-style-type: none"> • Yews • Junipers • Arborvitae • Dwarf Alberta Spruce • White Pine | <ul style="list-style-type: none"> • Lilac • Forsythia • Viburnum • Many More | <ul style="list-style-type: none"> • Norway Maple • Crimson King • Mountain Ash • Purple Leaf Plum |

ALSO REDUCED WOOD CHIPS | SHREDDED BARK \$14.25 per yard (reg. \$18.25/yd.)

Schaefer Greenhouse, Inc.
6825 Rochester Rd., Troy (1/2 mile south of M-59)
MON.-SAT. 8:30-8, SUN. 8:30-6 879-0288