

Sinai names branch after benefactors

Sinai Health Care System officials announced that the Farmington Hills-based Diagnostic Imaging Center opening late this summer will be named the Edward and Lillian Rose Diagnostic Imaging Center.

The Rose family has a longstanding relationship with Sinai. Brothers, Leslie, a member of Sinai's board of trustees since 1973, Irving and Sheldon have made a major financial commitment to the facility from their father Edward's estate.

Located at 32005 Northwestern Highway, the 6,500-square foot center will house a Siemens Magnetom 63 High Resolution Magnetic Resonance Imaging system and a Siemens Somatom Plus CT scanning unit.

Magnetic resonance imaging (MRI) is complementary to computerized tomography (CT scans), according to Dr. Philip N. Casadeo, chairman of Sinai's department of diagnostic imaging/radiology.

MRI incorporates magnetism and radio waves to create images rather than CT which utilizes computers and X-rays. Although both procedures may be used in some cases,

MRI is superior to CT in detecting such neurological disorders as multiple sclerosis, and CT is superior in discovering abnormalities of the pancreas.

Few MRI systems are available in the Detroit area, according to Casadeo, and Sinai's new imaging center will be advantageous to patients. "It will be accessible for patients in the northwest suburbs by offering these services on an outpatient basis," said Casadeo. "Patients will not need to travel a great distance, and it will reduce the waiting period for appointments. The facility will greatly increase the availability and accessibility of these imaging services."

Sinai's physician referral telephone number is 1-800-248-3827.

campus pipeline

If you have news from a college, university or other campus of higher education — and there's a Farmington area connection — we'd like to hear from you. Send items to: Campus Pipeline, Farmington Observer, 21898 Farmington Road, Farmington 48024.

NEW GRADUATES

James Maitrepiere of Farmington Hills graduated from Sweet Briar College in Sweet Briar, Va., with a bachelor of arts degree in international affairs.

She received the Association of American Women of European Scholarship for four years.

She was president of the French Club, a volunteer for the Prevention Center for Child Abuse and Neglect and a campus newspaper staff writer.

er. She had poems published in the college literary magazine.

Maitrepiere completed an internship with the French Trade Commission of Detroit and with Conus Communication, a broadcast news agency in Washington.

Laurie McKinnon and Stacy Sukoekas, both 1986 North Farmington High graduates, have graduated from Michigan State University with advertising degrees in the communication arts program. They plan to move to Atlanta and seek employment there.

Ruta Sepetys and Jennifer Voison of Farmington Hills received a bachelor of arts degree from Hillsdale College. Sepetys majored in international business and foreign language. Voison in early childhood education.

Robert Schulkins of Farmington Hills earned an associate in applied science degree from Vincennes University, Vincennes, Ind.

GAINS MBA

Charles Iliovanesian of Farmington Hills earned a master of business administration degree in finance and accounting from the University of Michigan.

He was admitted to the Beta Gamma Sigma fraternity for excellence in scholarship.

In 1986, he earned a bachelor's degree from the U-M in mechanical engineering.

EARN SCHOLARSHIP

Elizabeth Mistor, a food service management major from Farmington Hills, received Dykstra Scholarship from Ferris State University,

Big Rapids.

The \$400 food service scholarship is to be applied to next year's tuition.

Kristopher Shier of Farmington earned a Graco Inc. scholarship award for the 1990-91 school year. He was chosen for academic excellence, extracurricular activities, community involvement, work experience and career ambition. He'll begin his freshman year this fall at the University of Michigan.

DEAN'S LIST

Patrick Nugent of Farmington made the dean's list at Hillsdale College. He posted a perfect 4.0 grade point average for a semester.

Lisa Nordini of Farmington has been named to the dean's list for the spring semester at Bradley University, Peoria, Ill.

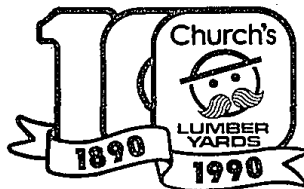

"MEET OR BEAT PACKAGE PRICING"

Sale Prices Good Thru June 27, 1990

24'x34' 2-CAR GARAGE WITH HIGH PITCH ROOF	32'x34' 2-CAR GARAGE WITH 2ND FLOOR STORAGE	32'x34' 2-CAR GARAGE WITH STUDIO LOFT
Sale Price \$1899	Sale Price \$2999	Sale Price \$3799
Includes: 24'x34' 2-Car Garage with High Pitch Roof, 24'x34' 2-Car Garage with High Pitch Roof, 24'x34' 2-Car Garage with High Pitch Roof	Includes: 32'x34' 2-Car Garage with 2nd Floor Storage, 32'x34' 2-Car Garage with 2nd Floor Storage, 32'x34' 2-Car Garage with 2nd Floor Storage	Includes: 32'x34' 2-Car Garage with Studio Loft, 32'x34' 2-Car Garage with Studio Loft, 32'x34' 2-Car Garage with Studio Loft

GARAGE PACKAGES

SIZE	GABLE ROOF	HIP ROOF
16'x20'	\$999.00*	\$979.00*
16'x24'	\$1059.00*	\$1079.00*
18'x20'	\$1029.00*	\$1029.00*
18'x24'	\$1139.00*	\$1129.00*
20'x20'	\$1119.00*	\$1109.00*
20'x24'	\$1199.00*	\$1229.00*
22'x20'	\$1169.00*	\$1179.00*
22'x24'	\$1279.00*	\$1299.00*
24'x20'	\$1259.00*	\$1259.00*
24'x24'	\$1379.00*	\$1399.00*

*Other sizes and styles available at similar savings.

*Package Includes: Stud Grade 8 stud walls with 5" R-11 (NOT 3" R-11) insulation, 20 year Owens Corning Fiberglas shingles, 2" eave and 2" eave gable window. GARAGE AND SERVICE DOORS ARE EXTRA.

HOUSE PACKAGES

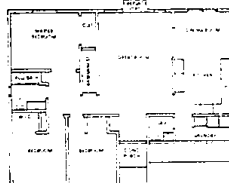
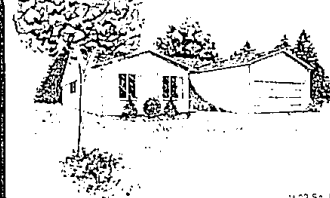

We've been supplying top quality home building materials since 1890. From ultra-custom to ultra-practical we have the know-how to handle your home building project, or we can draw on our experience to suggest a plan. For example: The rough framing package for this 1500 sq. ft. Ranch is only!

\$7995

Package Includes:
•All rough framing lumber
•Shingles, Sheathing and Nails
•Ready for installation on your foundation. This package is provided with a price, however when Church's does not supply, other pricing options are also available.

24'x32' DELUXE POLE BUILDING

With 12" Eave Overhangs

Sale Price **\$1995**

Add \$200.00 for painted steel

•Galvanized Metal & Metal Trim
•Treated 4"x4" Poles (48" Ground)
•Heavy Duty Trusses (4/12 Pitch)
•2x10 Treated Kick Board
•Door Frame Material & Hardware (10x8)
•Structural Lumber (Girts, Purlins, Ties)
•Pole Barn & Galvanized Metal Nails
*Not ready as pictured. Does not include steel or door.

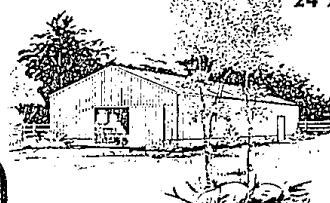

We have the only Weather-Resistant Lumber in town!



GUARANTEED 2-WAYS
1. GUARANTEED FOR DURABILITY
2. GUARANTEED FOR APPEARANCE
WITH Weyerhaeuser's Redwood
"BUCK-A-BRAND"
W-100 GUARANTEE
Visit our store for your copy

Wolmanized Extra Ponderosa Pine DECK KITS

10'x10'	10'x16'	16'x16'
Sale Price \$219	Sale Price \$319	Sale Price \$489

Select Tight Knot Cedar DECK KITS

10'x10'	10'x16'	16'x16'
Sale Price \$229	Sale Price \$339	Sale Price \$529

All deck kits include (typical) posts, nails, ready-mix cement, hardware, and step-by-step instructions. Posts and steps are extra.

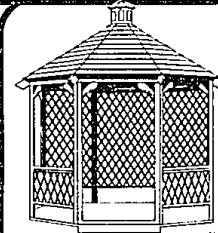

Don't Be Fooled by Ready To Cut Gazebos... We carry durable pre-cut, all-wood Western Cedar Gazebos that are backed by a 15 year warranty. Ready to assemble all pieces are pre-cut and many parts are even sub-assembled making complete assembly very simple for the do-it-yourselfer.

9'9" CEDAR GAZEBO
Sale Price **\$1495** Reg Price \$1927
INSTALLED... \$1847
Package Includes: Floor and Cupola
—SPECIAL ORDER ONLY—
other sizes available

NEW ENGLAND S&H BOX
8'x8' STORAGE SHED
W/ 10'x12' P.O.C.
Floor Extra \$36.00
Sale Price **\$329**

8'x8' ECONOMY STORAGE SHED
W/ 10'x12' P.O.C.
Floor Extra \$50.00
Sale Price **\$139**

10'x12' GAMMEL STORAGE SHED
W/ 10'x12' P.O.C.
Floor Extra \$50.00
Sale Price **\$369**

DELUXE 12'x12'x12' STORAGE BARN
W/ 12'x12' P.O.C.
Floor Extra \$50.00
Sale Price **\$729**

PICNIC TABLES
Handy overlay templates (11" x 18") let you cut lumber to precise sizes and shapes without measuring.

HEXAGON TABLE
Treated \$595 CEDAR \$695
*Take 100' 54" up to 100' 54" overall up to 10'

OCTAGON TABLE
Treated \$895 CEDAR \$995
*Take 100' 77" up to 100' 77" overall up to 10'

2x4 STUDS
Stud Grade
2x4 Foot Sale Price **\$1.05**
2x4 Foot Sale Price **\$1.45**

DRYWALL
3/8" or 1/2" x 4'8"
Sale Price **\$2.99**
LIMIT 50
Take with prices only

Weyerhaeuser STRUCTURWOOD UNDERLAYMENT
1/4" x 4'8"
Sale Price **\$7.95**
*Includes sheathing, building and waterproofing

Weyerhaeuser STRUCTURWOOD
Strong & Durable 7/16" x 4'8"
Sale Price **\$7.00**

CD PLYWOOD
5/8" 1502" (12'x14'8")
Sale Price **\$7.95**

FIBERGLAS SHINGLES
20 year limited warranty
Sale Price **\$5.99**
*Bundled \$17.97 per square

LOCATION	OPEN HOURS	16 Convenient Locations to Serve You!
Ann Arbor	Monday-Saturday 9:00 a.m. to 7:00 p.m. Sunday 9:00 a.m. to 5:00 p.m.	ANN ARBOR 688-0030 1011 N. Main St. (Maple Village Center)
Brighton	Monday-Saturday 9:00 a.m. to 7:00 p.m. Sunday 9:00 a.m. to 5:00 p.m.	BRIGHTON 227-9722 1017 Auburn Hill Rd. (Auburn Hill Center)
Detroit	Monday-Saturday 9:00 a.m. to 7:00 p.m. Sunday 9:00 a.m. to 5:00 p.m.	DETROIT 371-2100 1017 Auburn Hill Rd. (Auburn Hill Center)
Lapeer	Monday-Saturday 9:00 a.m. to 7:00 p.m. Sunday 9:00 a.m. to 5:00 p.m.	LAPEER 664-8581 1275 Saginaw Hwy. (Maple Village Center)
Oxford	Monday-Saturday 9:00 a.m. to 7:00 p.m. Sunday 9:00 a.m. to 5:00 p.m.	OXFORD 628-4848 1017 Auburn Hill Rd. (Auburn Hill Center)
Pontiac	Monday-Saturday 9:00 a.m. to 7:00 p.m. Sunday 9:00 a.m. to 5:00 p.m.	PONTIAC 334-1594 151 Oakland near W. 12th
Romero	Monday-Saturday 9:00 a.m. to 7:00 p.m. Sunday 9:00 a.m. to 5:00 p.m.	ROMERO 752-3511 1017 Auburn Hill Rd. (Auburn Hill Center)
St. Clair	Monday-Saturday 9:00 a.m. to 7:00 p.m. Sunday 9:00 a.m. to 5:00 p.m.	ST. CLAIR 329-4781 1017 Auburn Hill Rd. (Auburn Hill Center)
Utica	Monday-Saturday 9:00 a.m. to 7:00 p.m. Sunday 9:00 a.m. to 5:00 p.m.	UTICA 731-2000 1017 Auburn Hill Rd. (Auburn Hill Center)
Waterford	Monday-Saturday 9:00 a.m. to 7:00 p.m. Sunday 9:00 a.m. to 5:00 p.m.	WATERFORD 682-3040 1017 Auburn Hill Rd. (Auburn Hill Center)
Wayne	Monday-Saturday 9:00 a.m. to 7:00 p.m. Sunday 9:00 a.m. to 5:00 p.m.	WAYNE 722-7300 1017 Auburn Hill Rd. (Auburn Hill Center)

MARVIN CASEMENTS

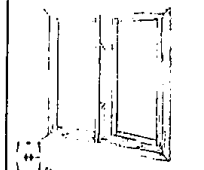

THE WINDOW THAT'S REPLACING OTHER BRANDS OF REPLACEMENT WINDOWS.

MARVIN WINDOW CENTER
11700 Coolidge Lake Road - Union Lake
363-6175

HO LEE KOW FIREWORKS

12th ANNIVERSARY

SALE

OUR MOST POPULAR ITEMS ARE NOW AVAILABLE IN PREPACKED ASSORTMENTS AT

\$5-\$100

DOZENS OF MULTI-SHOTS NEW THIS YEAR!

61-100 SHOT CAKES! AERIAL SHELL SETS

HO LEE KOW FIREWORKS
1-75 AT 7 MILE
368-9300

Where there's a need, there's a way.
The United Way.