

A house for all reasons

With only two bedrooms and a bathroom upstairs, the American Rose is a medium-sized house that can accommodate a growing family, one with older children, or empty nesters who wish to have space to entertain guests without feeling cramped.

Built over a full basement, it has the possibility for expanding living and storage spaces.

Stepping into the high vaulted entryway, the first impression is one of vastness. This area, and the formal living room are both vaulted to the second floor. The landing at the top of the curving stairway overlooks the living room.

The kitchen, with both a garden window and a bay window has a bright, airy feeling. Cooks can work together without bumping elbows. The upper of the double ovens has microwave features, and there are plenty of cupboards in addition to the pantry.

This design makes excellent use of oddly shaped spaces. A hutch is tucked into an angle in the dining room, a fireplace in another in the family room, and small angled half bath is close by.

The master suite has an oversized tub and a shower that is lightened by a skylight and glass block. A sliding door provides pri-

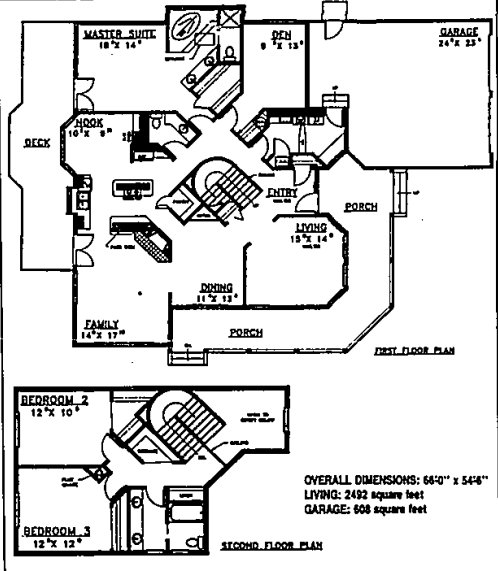

vacy, and steam containment for the shower and toilet. Double sinks are outside this area, close to the walk-in closet.

For the many people who find they are doing at least some of their work at home, this design includes an office close to the master suite.

The utility room has all the amenities: laundry sink, appli-

ances, fold-down ironing board and a window-its shelf that looks out to the front porch. The two-car garage includes extra space for a workbench or storage space.

For a study plan of the American Rose (330-99), send \$7.50 to Landmark Designs, P.O. Box 2307, Eugene, Ore. 97402. Include plan name and number when ordering.

CANTON
Stewarts Woods
Grand Opening!

This natural wooded setting is in the very heart of a vibrant suburban community providing convenient access to work, shopping, recreation and excellent schools! Yet the neighborhood is tranquil; each custom designed home is set thoughtfully within the landscape to ensure both privacy and scenic views.

16 Exceptional Homesites now available.
Priced from the \$140's.

BRANDT GROUP INC.
BUILDERS AND DEVELOPERS
Model: 397-9397 Office: 344-8222

Now You Have Two Choices For Custom Quality Homes In Novi.

Singh Development Co., Ltd. has brought a commitment to quality to their two latest communities - Bradford of Novi and Westminster Village. Each exemplifies a philosophy that each community is more than just a place to live; it is a place for living.

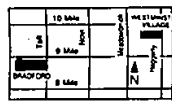

Bradford of Novi and Westminster Village Sales Offices
Open Daily 12-6
Closed Thursday
Singh Development Co., Ltd., Birmingham, MI • (313) 433-1100

• Four Distinctive Floor Plans including Ranches, Cape Cods and Colonials
• Estate Sized Half Acre Lots with Common Park Areas
• Vaulted & Cathedral Ceilings
• 4 Bedrooms, 3 1/2 Baths, Attached 3-Car Garages
• Master Suites with Walk-in Closets and Whirlpool Tubs
• Great Northville Schools

BRADFORD of Novi
On 1/2 Acre South of 9 Mile (313) 350-5555
Prices from \$284,900

• Five Distinctive Floor Plans including Ranches, Cape Cods and Colonials
• 3 & 4 Bedrooms, 2 1/2 Baths
• Dramatic Cathedral Ceilings
• Living, Family and Dining Rooms, Library
• Island Kitchen with Sink
• 2-Car Attached Garage
• Great Novi Schools

Westminster Village
On 1/2 Acre South of 10 Mile (313) 442-2626
Prices from \$164,900

ANN ARBOR'S PREMIER LOCATION!

\$129,990
Close-Out Prices
Phase I

ONLY 8 HOMES REMAINING!

Traditional ranch and 2-story townhomes with pond and wooded views.

Site Features Include:

- Adjacent to 14-acre Park with Nature Walkways
- Outstanding Location, Central to Work, Shopping & Recreation
- Premium Walk-Out Sites Available
- Exclusive Resort Class Pool
- 0 Point Financing Available*

Home Features Include:

- Soaring Cathedral Ceilings
- Private Courtyard Entries
- 2-Car Attached Garages
- 1st Floor Laundry
- Wood Burning Fireplace
- Premium Finished Lower Levels Available
- Skylights Available

Brookside Commons
Condominiums

995-8980

Located on the west side of Main St. 1/4 mile north of University Rd.
Open Daily 1 pm-6 pm
Sat & Sun 1 pm-5 pm
Closed Wednesdays

HIDDEN RIDGE HOMESITES

ESTATE OF MIND

CLOSE YOUR EYES AND IMAGINE THE PERFECT SETTING TO BUILD YOUR HOME. A SPECIAL QUIET PLACE RESERVED FOR THE PRIVILEGED FEW WHO CHERISH NATURE, BEAUTY AND TRANQUILITY. A WOODED RETREAT WITH PRIVACY AND SECLUSION. A DREAM COME TRUE. NINE EXCEPTIONAL HOMESITES AWAIT YOUR CONSIDERATION. IN THE CITY OF BLOOMFIELD HILLS, FROM \$495,000.

K.W. PETERSON & ASSOCIATES
644-6780
DEVELOPED BY:
HUGHES PROPERTIES/TINOFERRA ENTERPRISES