



Light is Right

Sunshine design is an illuminating concept

As you might have gathered from the name, the Sunshine from Landmark Designs of Eugene, Ore., was conceived to take full advantage of natural light.

One of its most unique features is a front-facing upper deck, or solarium, adjacent to the master suite. While providing privacy and protection from the wind, the space also serves as a nurturing environment for pots of colorful sun-loving plants.

The solarium's back wall is almost entirely glass. Two sets of sliding doors flank a stationary window and all three are capped

by half-frames. Step through one of the sliding glass doors and you'll find yourself on a balcony with a 12-inch shelf at railing height — another neat nook for plants.

The balcony overlooks an exceptionally bright kitchen and dining room. Light filtering in through the solarium windows combines with light from four skylights in the two-story ceiling to provide reliable natural illumination throughout the daylight hours, most of the year.

Located well away from the activities of the rest of the home, the

master suite serves as a quiet adult retreat. Luxury amenities include: his and hers pass through wardrobes, a double-basin vanity and a raised spa tub. Tropical plants flourish in the warm, moist atmosphere around the tub.

A second bedroom, on the opposite side of the balcony, also has a private bathroom. The bedrooms downstairs share a third bathroom.

Counters wrap around four sides of the generously sized kitchen. An eating bar is convenient for snacking and lazy susan

shelving provides easy cupboard access in two corners. Sliders in the bayed dining room make it easy to move meals outside onto the raised deck.

Additional storage space is available in a pass-through utility room between the dining room and garage. The two-car garage has a U-shaped shop in back, complete with counters and cabinets.

To take a closer look at the Sunshine, send \$7.50 for a study plan (301-01) to Landmark Designs, P.O. Box 2307, Eugene, Or. 97402. Be sure to include the plan name and number.

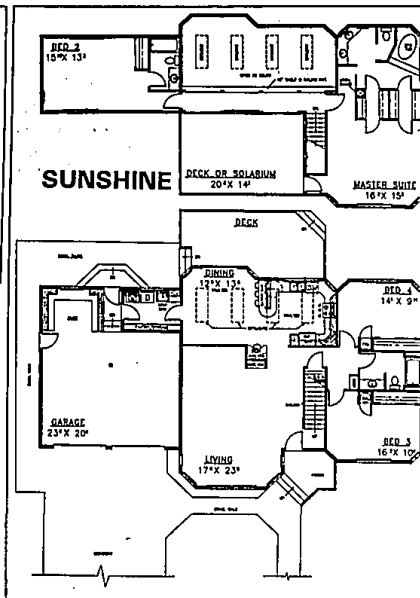

Sunshine: Overall dimensions are 66 feet by 40 feet. The living space totals 2,626 square feet and the garage is 636 square feet.

2-4 Bed, Corner Home with 1/2 Acre Backyard!

And... Behind These Beautifully Affordable New Homes, Is A 4,300-Acre Backyard.

3-4 Bedroom Homes \$177,400

You'll never find a backyard quite like this... with an 18-hole golf course, boating, fishing, swimming and miles of nature trails to explore. Plus Berwyck's exclusive adjacent Saddle Club and equestrian facilities are also at your door step!

Open Daily 12:00-6:00
BERWYCK 684-2600
 Brokers Welcome

Another Exciting Community by The Irvine Group

Get The Inside Story On West Bloomfield's Hottest Selling Detached Condominium Homes

Don't Be Left Out Of The Picture From \$169,900

Picture perfect, maintenance-free new ranch, colonial and 1-1/2 story lot plans built among 141 acres of woods and ponds. Hurry for best walk-out and wooded sites today.

Children Can Walk Next Door To The New Pleasant Lake Elementary School Built From Nature's Blueprints. Flexible Open House 6 p.m. (Closed Thursday) 681-5000 Brokers Welcome

An Irvine-Jacobson Community

SOUTH MICHIGAN'S FINEST LAKESIDE HOMES

At last the time you've always dreamed of... a private & public minutes from your front door. Maintenance free living in luxury condominiums set in rolling hills, lakes, ponds & plus! From \$189,500

Models - (313) 220-2929
 Hours - 12-6, daily
 Closed Thurs. / BROKERS WELCOME

Exit 147E Spencer Ridge Park Pointe is located 5 minutes west of Downtown Brighton, on Brighton Road (Main St.), east of Chilson in Brighton

GARDEN CITY'S BEST KEPT SECRET ISN'T A SECRET ANY MORE.

Garden City's First GRAND OPENING in 25 Years!

DISCOVER WESTERN WAYNE COUNTY'S GARDEN SPOT

It's been over two decades since a brand new single-family community has opened in this thriving, convenient location. Victoria Gardens is a great place to live... a great place to play... and a great place to watch your children grow. Enjoy Garden City's well established school system, stable taxes and wonderful city services.

FURNISHED MODELS OPEN 7 DAYS FROM 12:30-6:00 P.M.

Our exciting, feature packed homes stand head and shoulders above anything close to our affordable prices from the \$120's.

Located south of Marquette, east of Henry Ruff Rd. between Ford Rd. and Cherry Hill. Presented by two of Michigan's finest home builders: HERITAGE RESIDENTIAL GROUP, Model 458-8143 MICHIGAN GENERAL CONSTRUCTION CO., Model 421-3699

VICTORIA GARDENS A SINGH Development

ANN ARBOR'S PREMIER LOCATION!

FROM \$129,990

GRAND OPENING PHASE II!

Traditional ranch and 2-story townhomes with pond and wooded views.

- Adjacent to 14-acre Park with Nature Walkways
- Outstanding Location, Central to Work, Shopping & Recreation
- Full Basement with Premium Walk-Out Sites
- Exclusive Resort Class Pool
- Soaring Cathedral Ceilings
- Private Courtyard Entries
- 2-Car Attached Garages
- First Floor Laundry
- Wood Burning Fireplace
- Premium Finished Lower Levels Available
- Skylights Available

Immediate Occupancy Available

Brookside Commons Condominiums

995-8980

Realtor Participation Invited

Located on the west side of Main St. 1/4 mile north of Eisenhower Rd. Open Daily 1 pm-6 pm. Sat. & Sun. 1 pm-3 pm. Closed Wednesday.

Professional Marketing by Holzman & Silverman
 Developed and Built by Brookside Commons Development Company