

## Designed for sloping lot

The Foxridge is a wonderfully unusual design allowing for maximum utilization of interior space and compelling exterior. Designed for a slightly sloping lot, the Foxridge would fit equally in the city or country. The central living area allows for the striking contrast of angled vertical lines with the more linear horizontal lines of the side wings.

The right wing contains an office with full bath. Amenities include wash basin, linen storage and clothes hamper. On the lower level is an exercise room, with its own half bath.

The living area is impressive and features extensive windows allowing for a truly panoramic view and taking full advantage of natural light. The generous utility room is also centrally located for convenience.

The huge master suite is designed to pamper its owners. The fireplace adds warmth to this room for those cold winter nights. A bathroom the size of a small bedroom is filled with natural light from several skylights. The spa room can be entered through the master suite bathroom or from the patio.

Designed to compliment its environment, the Foxridge offers the opportunity for stylish and spacious living in a home intended to make the most of available space.

For a study kit of the Foxridge (402-08), send \$10 to Landmark Designs, 33127 Saginaw Rd. E., Cottage Grove OR 97424. (Be sure to specify plan name and number.) For a collection of plan books featuring our most popular house plans, send \$20 to Landmark, or call 1-800-562-1151.

### FOXBRIDGE

Landmark  
Designs

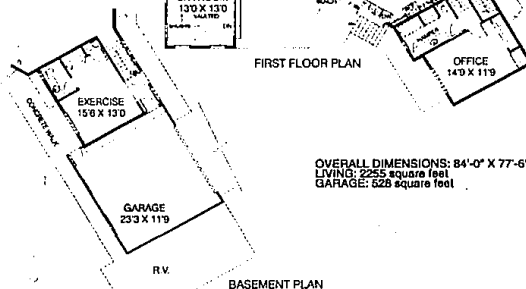

OVERALL DIMENSIONS: 84'-0" X 77'-6"  
LIVING: 2245 square feet  
GARAGE: 526 square feet

FOXBRIDGE (402-08)  
By Landmark Designs, Inc.

## Low-E film saves

Many homeowners are using add-on solar-control films to upgrade their existing windows. Upgrading a window with a retrofit window film is much less expensive than replacing a window. And the newer Low-E films are compatible with all standard single-, dual- (thermal), or storm-pane windows found in most homes today.

These new films can block up to 99 percent of the harmful ultraviolet (UV) rays that contribute to fabric fading. Plus these films help keep heat indoors during the winter months. For year-round savings, they reflect half the sun's heat back outside to improve indoor comfort and reduce those sky-high summer utility bills.

### SAVINGS BY THE YARD

There has never been a better time to visit Westmont Village. Luxurious new homes exceed every expectation in one of Novi's best locations. And now, for a limited time, we'll include professional landscaping and a complete irrigation system absolutely FREE\*! Hurry in for the best selection.

- Charming village atmosphere
- Spacious homesites
- Breathtaking designer models
- Homes under construction for quick occupancy
- Walking distance to excellent Novi schools

From the \$270,000's  
(810) 347-7855  
**NOV!**

Presented by  
Cohen, Nossan & Selective

### Canton's Wethersfield is a must if you love open spaces.

Grand Opening Phase II  
Immediate Occupancy

**Wethersfield**  
Beautiful and original Condo designs!

From \$129,990

2 and 3 bedrooms  
1st floor master bedroom suite  
2 1/2 baths with ceramic tile  
Complete kitchen appl. w/microwave  
Bay windows  
Full Basement  
Central Air Conditioning  
2 Car Garage  
Complete landscaping w/sprinklers  
Plymouth-Canton schools

Call Linda at (313) 397-9492  
Mon.-Fri. 1-6; Sat. & Sun. 1-5:30; Closed Thurs.

### WEST BLOOMFIELD

## THE GRASS REALLY IS GREENER AT PARK RIDGE SOUTH

**PARK RIDGE SOUTH**

Choosing a new home now could mean waiting until next summer for landscaping. But not at Park Ridge South. Purchase here before January 15, 1997 and we'll include a professional landscape package complete with lush green sod. Each expansive homesite is tucked into the rare privacy of deep, unspoiled woodlands. Beautiful new home designs include side-entry, three-car garages for inviting streetscapes. Park Ridge South also offers neighborhood sidewalks linked to the Pontiac Trail bike path system, an on-site children's playground and a prestigious West Bloomfield location.

Single-Family Homes  
From The Mid \$300,000's  
7 days a week  
(810) 669-1070

Visit our Sales Center at Park Ridge, on the north side of Pontiac Trail.

COHEN, NOSSAN & SELECTIVE

### Tri-Mount...Is Building Dreams

• IN MILFORD •

#### SPECIAL HOLIDAY PACKAGE

**Tri-Mount** is offering INCREDIBLE FINANCING PACKAGES where move-in costs are indicated below.

will MAKE your FIRST MORTGAGE PAYMENT on any new home purchased before 1-1-97.

will MAKE your FIRST TWO MORTGAGE PAYMENTS on any home at drywall or beyond purchased before 1-1-97.

810-685-0908 From the \$180's

MODELS OPEN 1-6 DAILY • BROKERS WELCOME

Call or Visit our Models for Details

...First to offer a 2 YEAR WARRANTY

### Tri-Mount...Is Building Dreams

• IN LAKE ORION •

#### SPECIAL HOLIDAY PACKAGE

**Tri-Mount** is offering INCREDIBLE FINANCING PACKAGES where move-in costs are indicated below.

will MAKE your FIRST MORTGAGE PAYMENT on any new home purchased before 1-1-97.

will MAKE your FIRST TWO MORTGAGE PAYMENTS on any home at drywall or beyond purchased before 1-1-97.

810-685-0908 From the \$180's

MODELS OPEN 1-6 DAILY • BROKERS WELCOME

Call or Visit our Models for Details

...First to offer a 2 YEAR WARRANTY

### Tri-Mount...Is Building Dreams

• IN LAKE ORION •

#### SPECIAL HOLIDAY PACKAGE

**Tri-Mount** is offering INCREDIBLE FINANCING PACKAGES where move-in costs are indicated below.

will MAKE your FIRST MORTGAGE PAYMENT on any new home purchased before 1-1-97.

will MAKE your FIRST TWO MORTGAGE PAYMENTS on any home at drywall or beyond purchased before 1-1-97.

810-685-0908 From the \$180's

MODELS OPEN 1-6 DAILY • BROKERS WELCOME

Call or Visit our Models for Details

...First to offer a 2 YEAR WARRANTY