

# Binghamton home plan offers 2,000 feet of elegance

Squared columns, each supported by a stone pedestal, give a distinctive look to the wrap-around front porch that welcomes visitors to the Binghamton.

Arched windows and a small gable add to the charm of this mid-sized family home. Inside, a coffered ceiling and bay windows give a touch of elegance to the living room.

Light from the gable spills down to brighten the vaulted entry and family room. Family members will enjoy spending most of their time together in this pleasant space. Standing at the kitchen sink, you face into the family room or nook, and can also gaze out into the back yard. This angled island could also be outfitted as an eating bar. A step-in pantry that nestles into the corner provides ample storage space for canned goods and staple items.

Windows fill most of the rear wall. One set flanks the fireplace and another set slides open to provide easy access to a patio that spans the home's entire back side. A small utility room is on the left. Directly connected to the garage, this space is also handy for shucking off messy footwear after gardening or tramping through rain or snow. The master suite is vaulted and has sliding glass doors. This comes in particularly handy if the family ever wants to install a hot tub on the deck or patio. Other amenities include a walk-in closet and private bathroom with double vanity. Shower and toilet are separately enclosed, for privacy and steam containment. Secondary bedrooms are well-separated from the Binghamton's master suite and share a two-section bathroom with tub. The front bedroom is vaulted.

For a review plan, including scaled floor plans, elevations, section and artist's conception, send \$15 to Associated Designs, 1100 Jacobs Dr., Eugene, Ore. 97402. Please specify the Binghamton #10-259 and include a return address when ordering. A catalog featuring over 170 home plans is available for \$12. For more information call (800) 634-0123.



**The Binghamton #10-259**  
Living Area 2000 sq.ft.  
Outside Dimensions 69' x 52'

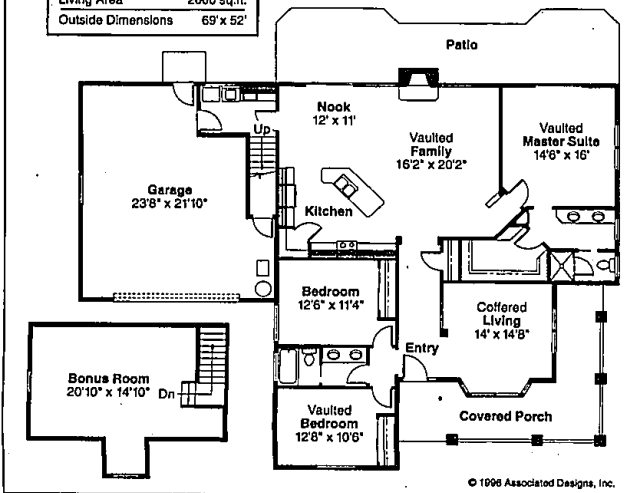

© 1996 Associated Designs, Inc.

## Do It Yourself Mistreated chairs can be repaired

READER'S DIGEST BOOKS  
FOR AP SPECIAL FEATURES

Chairs suffer more stress, strain and mistreatment than any other type of furniture, considering their lightweight construction and the heavy load they carry. However, there are several methods you can use if they have to be repaired:

### Two basic chairs

Straight-chair construction falls into two basic categories: frame or platform. A frame chair is composed of flat pieces that form a frame that supports the seat. It has two continuous back posts that serve both as the rear legs and the sides of the back rest. A platform chair has round legs, rungs and spindles. It has a separate back assembly that fits into a seat and the seat is supported directly by the legs. The joints that hold the platform chair together are mostly all dowel joints — the round legs, rungs and spindles fit into holes in the seat and legs.

All but the finest straight chairs can often be repaired at home with simple tools. The repairs you can make depend in part on the way the chair is constructed. Frame chairs, for example, are prone to break at the joints near the back of the seat. In platform chairs, the joints between the rungs and the legs are most vulnerable to damage.

### Before you start

Before taking a chair apart, examine it carefully. Plan to correct any previous quick-fix repairs. Before disassembly, remove all the fasteners. Label the components to ensure correct reassembly.

In any chair, the best way to fix a loose joint is to dismantle only the affected parts and reglue them. To dismantle a joint, gently work the pieces loose by hand, or use a rubber mallet or a hammer with a padded wooden block. If a joint is only slightly loose, you may be able to fix it by injecting a liquid wood sweller into it. Leave tight joints undisturbed.

Never substitute screws, nails,

metal plates or angle irons for a good glue job. It helps to place a chair in a warm, dry room for a few days before dismantling it.

A chair part may work loose because the glue has dried out, the wood has shrunk or because damage to another part of the chair has put a strain on the joint. Many loose joints can be repaired by pulling the joint apart, removing the old glue, applying new glue and clamping the pieces. After the glue is removed, test fit the pieces without glue to make sure all joints fit properly.

Sometimes the tenon on the end of a rung or spindle may need to be enlarged to fit snugly in its hole. Try wrapping thread or a wood shaving around the tenon, using glue to hold it in place.

### Loose frame

If you notice a wobble in a frame chair during use, check to see whether the frame is working loose around the seat. If it is, strengthen the frame by installing glue blocks. Cut a triangular block of hardwood, about 1 1/2-inches thick, to fit snugly into each corner of the frame. Make the block about 5- to 6-inches long and drill two holes through it and into the frame. Glue the mating surfaces and screw the blocks into place. If the frame already has glue blocks, reinstall them with fresh glue and slightly larger diameter screws to increase their holding power.

### Clamp and glue tips

Most repairs require gluing and clamping. You can, though, overdo both. Use too much glue and you'll not only create a mess, but weaken the joint or connection by creating a thick, easy-to-break glue line. Aim for a thin, even glue line.

Likewise, don't overtighten clamps. You can drive too much glue out, creating a starved joint. Or you can compress the wood so much that when the clamps are removed and the fibers spring back into shape, they weaken the repair.

## Law warns of lead

(AP) — Parents shopping for a new home would have some piece of mind under a new federal law that requires sellers to tell prospective buyers if a home contains lead-based paints.

But government and business officials worry that the new law aimed at protecting people from buying a home with the potentially toxic paints could cause confusion.

Under the new law, if lead is detected in a home, the would-be buyer can simply walk away — or go ahead and buy the house, intending to have the paint removed by a contractor.

Jonathan Swain, an information officer for the Indiana State Department of Health, said homeowners run the risk of hiring unqualified firms because state law doesn't require that lead paint abatement contractors be licensed.

"There's not a law on the

books, so there is no way we could say one firm is better than the other," Swain said.

Rose King, owner of Best Home Inspection in Hobart, agrees. She notes that paint dust produced during paint removal poses a health threat if improperly handled. Children often are exposed to lead paint when they eat paint chips.

"They're going to put this law into effect and we have no testing facilities in the area," she said. "This is going to scare people."

While it doesn't address lead screening or require that lead paint be removed from the home, the law requires sellers to disclose known information about lead-based paint in the home.

The seller also must give potential buyers an informational packet regarding lead and the buyer has 10 days to check for lead hazards.

## THE MASTER PLAN THAT BRINGS IT ALL HOME

A charming gate house sets the tone for a true master planned community complete with its own village shoppes and swim club. Collector's Edition condominium residences in ranch, loft and two-story plans display Herman Frankel's design mastery. Discover the community that will bring you home...to Village at Simsbury.

Priced from the upper  
\$200,000's

Village at  
**Simsbury**  
The herman frankel  
Organization

Farmington Rd., just north of 14 Mile Rd.  
(810) 851-3500

Luxury is Attainable  
at...  
RavenCrest Condominiums



### NEW MODELS UNDER CONSTRUCTION

Westland's most exciting opportunity is waiting for you!  
A standing tradition of quality construction, RavenCrest Condominiums offers 4 elegant floor plans, featuring 2 or 3 bedrooms, 1st floor master suites, 2 car attached garages and much more, prices from \$122,900.

COME VISIT US AT OUR  
SALE OFFICE, LOCATED  
AT 612 NEWBURGH RD.

OPEN DAILY 11-6 p.m.

313-722-8769

R & R Development  
Corp.

35015 Ford Rd., Westland



## Tri-Mount...Is Building Dreams • IN LAKE ORION •



SINGLE FAMILY HOMES  
**SILVERBELL**  
K & S  
LARGE LOTS • GOLF • PARK  
ROCHESTER SCHOOLS AVAILABLE  
Silverbell Rd., between M 24 & Agate  
(810) 377-4414



SINGLE FAMILY HOMES  
**Forest Hills**  
West side of Brown Rd., 3 miles North of I-75  
(810) 391-3472

MODELS OPEN 12-6 Daily • BROKERS WELCOME  
12-6 WEEKENDS  
Call or Visit our Models for Details  
...FIRST to offer a  
2 YEAR WARRANTY