

Game room completed with wet bar

FOR AP WEEKLY FEATURES

A finished basement or main-floor family room or game room isn't complete without a built-in wet bar. If you have a six-foot space available, you have room for a wet bar.

A lower cabinet can accommodate a half-sized refrigerator and a center sink, plus it has plenty of cabinet space for

storing cases of your favorite beverages.

The countertop can handle pizza boxes galore.

Upper cabinets add style, with wine holders, wine glass hanging racks and glass-fronted cabinets to show off collectible glasses and steins.

Cup lights will highlight the upper cabinetry and illuminate the countertop task area.

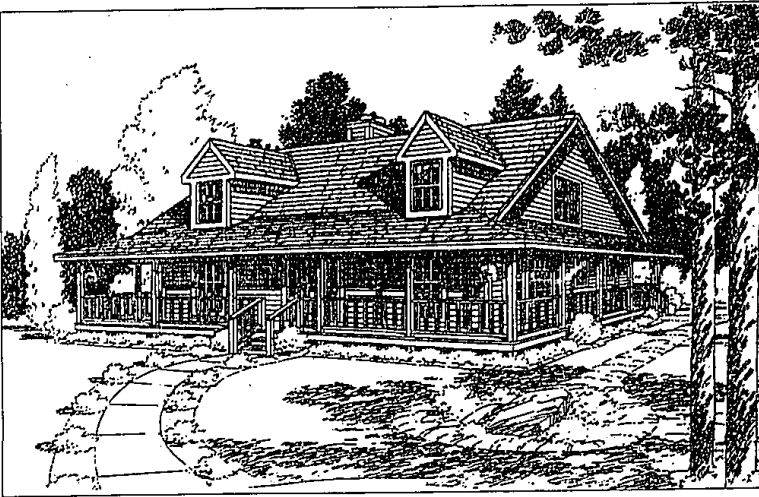

Welcoming home has wrap around porch

The classic look of a farmhouse is exemplified in the Lady Kay. It has a large wrap around porch and two dormers on the front of the home. It has one other classic feature and that is there is no attached garage. Farmhouses of early years always had a detached garage or barn.

The Lady Kay has 3,807 square feet of living space and an unfinished basement of 1,269 square feet. If needed, the basement could be finished into more bedrooms or a recreation room.

The front door is centered in the wrap around porch, bringing guests into the home facing the dining room on the right or the living room straight ahead. The dining room is very open with a bay window on the right side of the room. To the rear is the kitchen. It has the open shape of a "C" with a smaller counter across containing the range and oven. An eating bar is on the end of

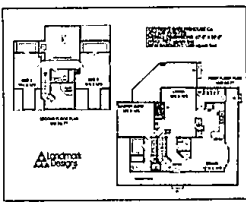

the main counter facing the dining room. At the rear of the kitchen is the utility room with a built-in pantry and storage closet.

A long living room with sliding doors to the back deck occupies the center rear of the Lady Kay. A large fireplace or wood stove is situated on the left wall with a shelf adjacent. Between the coat closet in the entry and the living room is a half bath.

The left side of Lady Kay is master suite. It has sliding doors that also open

onto the rear deck as well as windows that bathe the room in light on the left. The walk through master bath has a walk-in closet on the left with "his and her" sinks on the right. Further in is a full bath with tub and a shower as well as a linen closet.

Upstairs are two more bedrooms. They each have a dormer window with a large walk-in closet. Between the two rooms is an area open to the living room below. A full bath with a tub and a linen closet just outside are next to the stairs. There is also a plant ledge (actually over the half bath downstairs) where real or artificial flowers can provide color to both floors.

For a study plan, including scaled floor plans, elevations, sections and an artist rendering, send \$24.95 to Landmark Designs, 33127 Saginaw Road E., Cottage Grove, OR 97424. Please specify plan name (LADY KAY) and the number (610-785). A catalog featuring hundreds of home plans is available for \$12.95, or save by ordering both for \$29.95. For faster processing, call (800) 562-1151 or www.landmarkdesigns.com.

PALMER WOODS
OF OHIO

GRAND OPENING!

Sterling Height's First Gated Community where Loaded Interiors are Standard!

From \$220,000

New Furnished Model!
Open Daily: 1pm - 6pm
Weekends: Noon - 5 pm
Call: 586-826-9750
Entrance on 15 Mile Road

- Full brick exteriors
- Two bay windows
- 2 bedrooms, 2 full baths
- LAFADA custom cabinets
- Magnificent gated entrance with brick gatehouse and privacy walls
- Only 2 units per building, both ranch-style 1400 square feet each
- All wood windows and James Handle fiber cement siding
- Stained woodwork throughout
- Marble fireplace with gas logs and pine mantle and surround

VISIT YOUR NEXT NEW HOME

GRAND OPENING SUMMER OF 2003!
Call Now To Be On Our Priority Mail List!

FARMINGTON HILLS

OAKWOOD KNOLLS

- 3240 to 3700 Sq. Ft. Colonials and Cape Cod Designs Complete with Gourmet Kitchens and Palatial Master Suites
- 27 Exclusive 1/2 Acre Homesites Nestled in Nature
- Nationally Accredited Farmington Public Schools
- One of the Last Rare Finds in Farmington Hills
- Minutes From Every Convenience Including Orchard Lake Road, I-696, I-275, M-10, and M-24
- Executive Level Features Including Corian Countertops, Dual Fireplaces and Air Conditionings, Pella Windows, 3 Car Side Entry Garages, Extensive Custom Trimwork, Elegant Oak Tread Staircases
- Walkout, Wooded and Daylight Basements
- Industry Leading Quality and Service and Professional Builder of the Year

FROM THE MID \$500's
248-596-0006

BROKERS ALWAYS WELCOME!

The way it should be™

WWW.PULTE.COM

Brokers Welcome!

Pre-Grand Opening Pricing!

Woodfield

LANDING

New Condominiums Located in Grand Blanc's Prestigious Woodfield Golf Course Community
from the **\$160s**

- Secluded, heavily wooded setting
- Only 10 minutes north of Clarkston
- Ranch and 1-1/2 story condominiums with 1st floor master bedrooms
- 2-car attached garages
- Convenient 1st floor laundry

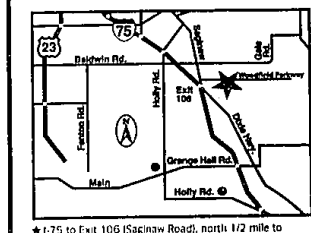

WESTMINSTER

Homes

ABBAY

A BURTON KATZMAN AFFILIATE

810-953-1388

Information Center Open Daily 12-6pm

★ I-75 to Exit 106 (Saginaw Road), north 1/2 mile to Woodfield entrance (just 10 minutes north of Clarkston)

www.WestminsterAbbeyHomes.com

Brokers Welcome!