

LAVERY INSURANCE AGENCY

FIRE — LIFE — AUTO
30760 Grand River
(Near 9 Mile)
Phone 2210

bad driving weather? go 'by TELEPHONE instead

Let the blizzards blow. Suppose roads are icy and driving dangerous. Comfortable and safe in your own home, you can still visit loved ones—by Long Distance. You'll find rates surprisingly low.

MICHIGAN BELL TELEPHONE COMPANY

Mr. Handyman DO-INSIDE WORK NOW!

REFINISH FLOORS
Refinishing floors is easy with our floor sanding machines. These machines are available for rent on a rental basis.

PAINTING
Inside painting and decorating is easy with our color books containing many suggestions for color blending. Fine quality paint at low cost.

PATCHING PLASTER
If your walls or ceilings are cracked and need patching, it can be done easily with our patching plaster. Needs only water. Easily worked.

PANELING
An old, drab, uninspiring room can be made to glow with the rich beauty of wood paneling. Easily installed. Ready to go.

OTHER QUALITY MATERIALS

FLOORING — VENEERS
CEILING TILE — CABINETS
FLOOR TILE — PLAYWOOD

HOME PLANNING DEPARTMENT

If you are thinking of extensive remodeling, see our home planning department for assistance in all phases of remodeling. No obligation.

FARMINGTON LUMBER & COAL CO.

32800 Grand River in NOWI Phone 0020
43755 Grand River Phone Northville 308

Homes and Gardening

Planting Boxes Can Play Important Role In Improving New Home Design

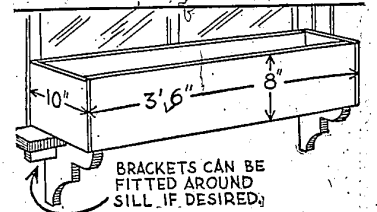

Working drawing for window box can be adapted to any length.

Planting boxes play an important part in the design of contemporary homes. They are used in many ways to contribute an important touch to the often severe lines of functional architecture.

In constructing all such boxes the needs of the plants to be grown in them should be considered. They should be sturdy, because the soil which they must hold is heavy. The material of which they are made must be capable of withstanding constant moisture. Most important of all is that they provide quick drainage for excess water which will come from rain and the garden hose.

Window boxes, which have been widely used for the last century in Europe and this country, provide experience both in constructing the container and in selecting the plants to be grown. Window boxes can be grown satisfactorily in a box at least 10 inches wide and 8 inches deep, with its length to fit the space allotted. A box of these dimensions is large enough to hold the roots of annual flowers, and small foliage plants. If larger subjects are to be grown, proportionately larger root space should be provided.

Concrete and metal boxes are satisfactory; but the do-it-yourself, hobbyist can easily build them of wood. White pine or cypress are preferred because of their moisture resistant qualities, and no boards less than one-inch thick should be used. The diagram herewith shows how to put the boards together and provide brackets to support the box where needed.

Think of the plant box as a decoration of the house. It should be painted to match the house color or trim. The flowers should be chosen to furnish a contrasting, harmonious color accent. There is a wealth of suitable varieties from which to choose.

Rich potting soil must be used for window boxes. Because there is so little of it to feed the flowers, it should be well fertilized.

For annual flowers, at least six hours of sun a day is necessary and this requires a south exposure. The best subjects are those of dwarf or trailing habit, the latter drooping festoons of bloom from the boxes. Petunias of the balcony type are excellent, as are the tall, nasturtiums, the plant morning glories, Dwarf petunias, marigolds, ageratum, calliope, annual pink, lobelia, dwarf morning glories, phlox and zinnias can be grown.

Boxes which spend most of the day in shade offer a special problem. If the shade is that of a building, perhaps only foliage plants can be grown.

The average schoolteacher in the United States earns about \$3,290 a year.

House Plan Of The Week

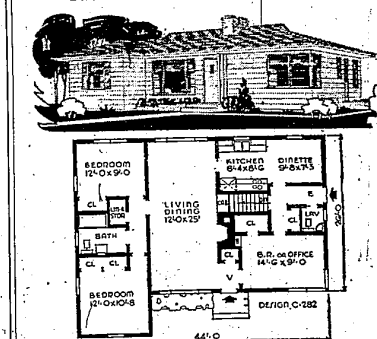

A unique feature of this plan is the third bedroom, which is placed in such a way that it can be used for a den, study or office. The other two bedrooms are separated from the rest of the house by a spacious living room - dining room combination. For further information about this plan, Design C-282, write The Small House Planning Bureau, St. Cloud, Minnesota.

SURVEY DISCLOSES COMFORTS FOUND IN MICHIGAN HOMES

Do you think yours is a typical Michigan family? A group of heating engineers just released some figures on the state which will reveal how your own family and home measure up.

The average family living under one roof consists of three persons. The family occupies an apartment or house of about five rooms and pays an average rent of around forty dollars a month. In the case of families that live in their own house, the average house is worth about seventy-five hundred dollars.

The heating engineers, who work for Minneapolis-Honeywell, also came up with some interesting figures about facilities inside Michigan homes. They say only 73 1/2 per cent of the families in Michigan have their own inside bathtub or shower installation. About 77 1/2 per cent have hot and cold running water. That's a little better than three out of four families, in each case.

The Honeywell experts found that only 68 per cent of the families in Michigan are kept warm in winter by central heating equipment. A little over two-thirds, that is, but they add, even so, this is a tremendous advance over ten years ago. There's also been a big increase in thermostats and automatic heating controls. In fact, an especially large number of Michigan homes now have electronic controls that were completely unknown a decade ago.

All in all, it looks as if the average Michigan family is keeping pretty comfortable this winter.

California Look Has Arrived In Floor Coverings

The California look has really arrived in modern floor coverings, as witnessed by the large numbers of gay handcrafted looking tweeds which were presented during the past season.

There is no set pattern to the tweed idiom. The outdoor look has been executed on just about every kind of loom and in all wool, synthetic and novelty fiber blends. Extra diversity in hardness and softness of yarn has been achieved in many instances for an authentic homespun hand and look.

Color creates 'important' style interest in the new tweeds because they do not stick to the tried and true combinations. Examples of new high fashion mixture include avocado, taupe and cinnamon; turquoise, blue and pewter; copper, charcoal and white; cedar, toast and mahogany.

Greatest appeal of the new tweeds is that they strike the happy medium between plain texture and precise motif.

Don't let other animals get the fattest feed you're giving the fattest cattle, caution MSC specialists.

MORE EQUIPMENT NOW INSTALLED IN NEW HOMES

Builders equip 997 new homes out of 1,000 with kitchen cabinets. They install water heaters in 828 houses, kitchen ventilating fans in 827, and garbage disposal units in 415.

These statistics resulted from a survey by American Builder magazine, which calls them evidence of an "increasing trend among builders to provide complete equipment in the new houses they build for sale."

The survey showed that 37.9 per cent of new houses come equipped with automatic dishwashers, 30.8 per cent with refrigerators, and 22.5 per cent with automatic washing machines.

How-To-Ideas by Dick Carpenter

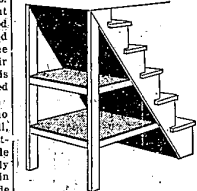

Storage Rack Under Stairs

Wasted space under a basement stairs can be converted to valuable storage space for canned fruit and similar things, by installing two or more shelves of hardboard as shown. First, the underside of the steps is enclosed with a panel of hardboard, nailing it to the edges of the two stair stringers. Next, two 1x2s are nailed from floor to ceiling, the upper ends being cut at an angle and nailed to the edges of the stringers flush with the outside. Supporting cleats of 1x2 for the hardboard shelves are nailed to the posts and stair stringers and then the hardboard shelves are cut to fit by notching the corners at the posts and nailing the hardboard to the top edges of the cleats. If desired, the whole affair can be enclosed with hardboard and a door added to the front.

"I'd Like To Be Your Mover"

Since 1924
IMLACH MOVERS
LONG DISTANCE MOVING — PACKING — STORAGE
SERVICE ANYWHERE IN THE U.S.A.
NEW YORK FLORIDA TEXAS
● Free Estimates ●
Office 28200 GRAND RIVER Farmington, Mich. Phone Farm. 3140
Office 1135 FORT STREET Lincoln Park, Mich. WArwick 8-0000

FEED the BIRDS

During the Cold Winter Weather They Can't Get Worms

We Have RYDES WILD BIRD SEED
It contains Sunflower Seed — Milo Stale — Wheat — Peanut Hearts — Canary Seed — Rice and Hulled Oats

5 lb. Sack . . . 95c
50 lb. Sack . . . \$5.50

Special
Wild Bird Feeders . . \$2.75 each
It Serves Feed and Attracts Cardinals and Blue Jays to Your Yard

MILLERS OF FLOUR AND FEED FOR OVER 50 YEARS

FARMINGTON MILLS
ESTABLISHED 1895
33408 STATE ST. DELIGHT
L.F. GLOEHEIMER, OWNER
FARMINGTON, MICH. PHONE 0015

A MESSAGE TO FARMINGTON MERCHANTS

The Farmington Enterprise

Farmington, Michigan February, 1955

Mr. Farmington Merchant
Farmington, Michigan

Dear Sir:

You have an investment in the Farmington Community... an important investment that is well worth protecting. But how can it be done with the greatest results at the lowest cost?

First, if you have something to sell, you have something to advertise. Second, if you have a growing trading area, you have new potential customers. Third, if you have an advertising media that is covering the area, you have an opportunity to tell your story.

More and more people are moving into the Farmington community every day, and they are subscribing to THE ENTERPRISE in record numbers. During the past five months your "Home Community Newspaper" has realized the largest single increase in circulation in its history. These new residents are anxious to know all about their schools, their township and their city, and they are finding the information in THE ENTERPRISE. They also want to know more about what their merchants have to offer in merchandise and services. We know, because they have told us so!

You have something to sell, you have a growing market in which to sell it, and you have a media that is not only being welcomed into more and more Farmington homes each week, but that is being read by every member of the family. Couple this growing readership with the low cost of ENTERPRISE advertising (as little as 65c per column inch) and you have a combination that spells real value. Become a regular ENTERPRISE advertiser this week. Remember, if you want people to shop at home — advertise at home!

Yours very truly,
THE FARMINGTON ENTERPRISE

MEMBER AUDIT BUREAU OF CIRCULATIONS